

Mem # 100

**CARSON CITY, NEVADA  
REQUEST FOR BOARD ACTION**

**Date Submitted:** September 22, 2006

**Agenda Date Requested:** October 5, 2006

**Time Requested:** 10 minutes

**To:** Mayor and Supervisors

**From:** Public Works - Engineering Division

**Subject Title:** Action to approve an Agreement between the Nevada Department of Transportation (NDOT) and Carson City for the Adjustment of Utility Facilities for a Portion of the Carson City Freeway Project, Phase 2A from E. Fifth St. and the Linear Park Ditch to the Wastewater Treatment Plant.

**Staff Summary:** Carson City is in the process of relocating their facilities as part of the Carson City Freeway Project, Phase 2A and the above described agreement is necessary for the construction and relocation, and reimbursement of a portion of the relocation costs.

**Type of Action Requested:** (check one)

- Resolution
- Formal Action/Motion
- Ordinance
- Other (Specify)

**Does This Action Require A Business Impact Statement:**  Yes  No

**Recommended Board Action:** I move to approve and authorize the Mayor to sign the Agreement between the Nevada Department of Transportation (NDOT) and Carson City for the Adjustment of Utility Facilities for a Portion of the Carson City Freeway Project, Phase 2A from E. Fifth St. and the Linear Park Ditch to the Wastewater Treatment Plant. The fiscal impact is \$6,404,668.00 to the Sewer and Water Capital accounts.

**Explanation for Recommended Board Action:** The proposed cooperative agreement with NDOT will allow the City to relocate sewer and water infrastructure from E. Fifth St. and the Linear Park Ditch to the Wastewater Treatment Plant that currently is in conflict with improvements proposed in conjunction with the Carson City Freeway. Carson City is proposing to construct extensive sewer, reclaimed water and water relocations primarily in E. Fifth St., West of the Freeway from Fifth St. to the Linear Ditch, at the Linear Ditch, and through Nevada State Lands prison property to Butti Way at the Wastewater Treatment Plant, as summarized in exhibit "A" attached to the agreement. The estimated project cost is approximately \$6,404,668.00 which includes engineering, construction management, construction, and a construction contingency. As further tabulated in exhibit "A" approximately \$2,928,457.00 of the total project costs is designated as a reimbursement through standard NDOT procedures. The reimbursable work is that work which is being required of City utilities contained within former City park property, and City easements which we have a "right to occupancy". Of the project total, approximately \$3,476,211.00 is deemed to be a "betterment" which represents work in which the City is undergoing within NDOT Right-Of-Way under existing encroachment permit where our facilities exist at the pleasure of NDOT, and other work that logically should occur at this time that will improve the overall infrastructure as completed, such as

the upsizing of the sewer crossing under the Freeway at the Linear Ditch to the Wastewater Treatment Plant to accommodate future build out flows.

The agreement will allow the City to move forward with the bidding and construction of the utility relocations so that NDOT'S Phase 2A contractor can proceed without conflict with the utility work.

**Applicable Statue, Code, Policy, Rule or Regulation:** NRS 408

**Fiscal Impact:** \$6,404,668.00 of which approximately \$2,928,457.00 is reimbursable from NDOT

**Explanation of Impact:** A portion of the project costs will be reimbursable by NDOT.





**Funding Source:** 515-0000-434-7998 NDOT By-Pass Replacement (Reimbursable)  
515-0000-434-7999 NDOT By-Pass Extension (Non-Reimb.)  
520-3505-435-7893 NDOT By-Pass Non-Reimbursable  
520-3505-435-7894 NDOT By-Pass Reimbursable

**Alternatives:** N/A.

**Supporting Material:** Project Overview Map  
Agreement and Agreement Exhibits

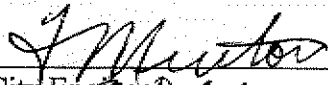
**Prepared By:** Jay Ahrens, PE, Senior Project Manager

**Reviewed By:**

<u></u>	Date: <u>9/26/06</u>
(City Engineer)	
<u></u>	Date: <u>9/26/06</u>
(Public Works Director)	
<u></u>	Date: <u>9-26-06</u>
(Finance Director)	
<u></u>	Date: <u>9-26-06</u>
(City Manager)	
<u></u>	Date: <u>9/26/06</u>
(District Attorney)	

**Board Action Taken:**

Motion: _____	1) _____	Aye/Nay
	2) _____	_____
		_____
		_____
		_____

\_\_\_\_\_  
(Vote Recorded By)

# CARSON CITY FREEWAY PHASE 2A

## UTILITY RELOCATIONS

### E. FIFTH ST. FREEWAY EAST, LINEAR DITCH TO BUTTI WAY CARSON CITY, NEVADA - SEC 16 & 21, T15N, R20E PROJECT 00-6010

EXHIBIT "B"

SHEET INDEX

- 1 TITLE SHEET
- 2 INDEX MAP, ABBREVIATIONS AND CONTROL POINTS
- 3 E. FIFTH ST. EAST OF FREEWAY - SANITARY SEWER
- 4 - 6 E. FIFTH ST. / LINEAR DITCH - SANITARY SEWER
- 7 - 14 LINEAR DITCH / WWTP - SANITARY SEWER
- 15 - 16 LINEAR DITCH - RECLAIMED WATER
- 17 - 21 E. FIFTH ST. WEST OF FREEWAY / BUTTIWAY - WATER
- 22 - 25 UTILITY REMOVAL/ABANDONMENT PLANS
- 26 - 34 TYPICAL CONSTRUCTION DETAILS

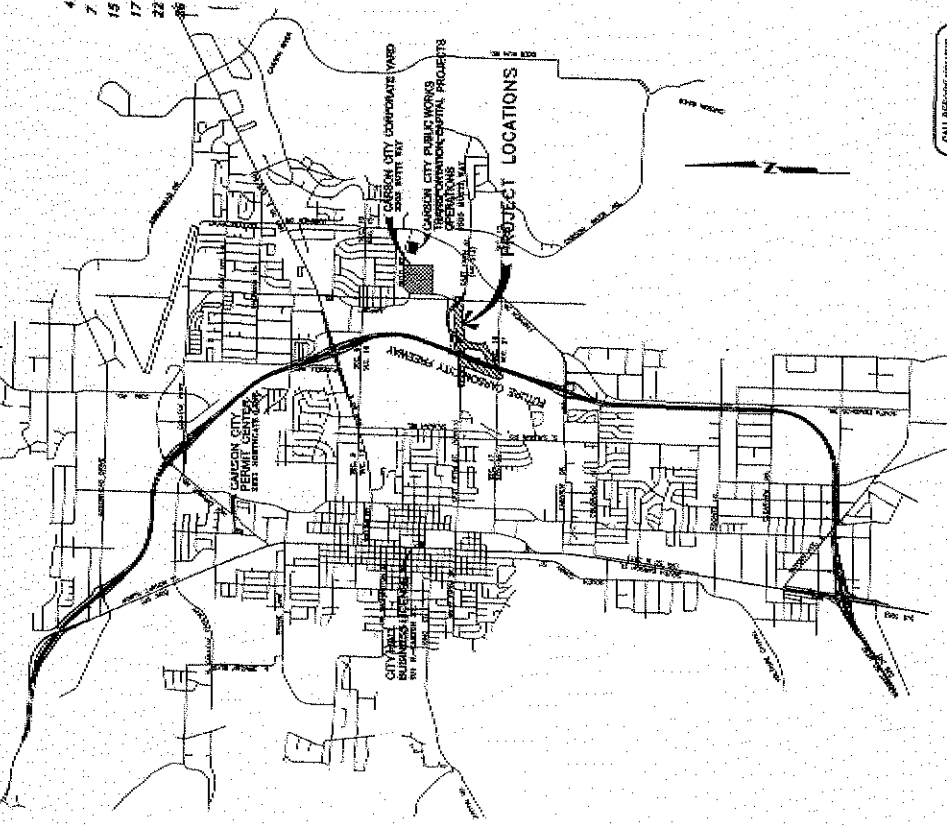

**BOARD OF SUPERVISORS**

Mary Teixeira Mayor  
 Robin Williamson Supervisor  
 Shelly Aldeman Supervisor  
 Pete Livermore Supervisor  
 Richard Staub Supervisor  
 Alan Glover City Clerk

**DESIGNED FOR:**  
 CARSON CITY PUBLIC WORKS  
 OPERATIONS DIVISION  
 3505 BUTTI WAY  
 CARSON CITY, NV 89701  
 887-2355

**GENERAL NOTES:**

1. ALL WORK SHALL CONFORM TO THE STANDARD SPECIFICATIONS AND IS TO BE USED FOR PUBLIC UTILITIES CONSTRUCTION AS APPLICABLE TO CARSON CITY, AND APPLICABLE WEST STANDARD SPECIFICATIONS AS NOTED BY THE CONTRACTOR.
2. ALL TRAVEL CHANNELS AND APPROXIMATIONS SHALL BE EXPOSED, CUT, AND WITHIN 100' OF ANY EXISTING UTILITY SHALL BE EXPOSED TO A DEPTH OF 12" BELOW THE FINISHED GRADE OF THE UTILITY. THE CONTRACTOR SHALL BE RESPONSIBLE FOR THE PROTECTION OF ALL UTILITIES EXISTING IN THE FIELD AND THE INFORMATION SHOWN ON THESE DRAWINGS IS SUBJECT TO THE CONTRACTOR'S VERIFICATION OF THE FIELD.
3. THE CONTRACTOR SHALL CALL CARSON CITY PUBLIC WORKS AT (702) 887-2355 AT LEAST 48 HOURS PRIOR TO THE START OF CONSTRUCTION.
4. THE LOCATION OF EXISTING UTILITIES SHOWN ON THESE DRAWINGS IS BASED ON THE BEST INFORMATION AVAILABLE TO THE CONTRACTOR. THE CONTRACTOR SHALL BE RESPONSIBLE FOR VERIFYING THE LOCATION OF ALL UTILITIES IN THE FIELD AND THE INFORMATION SHOWN ON THESE DRAWINGS IS SUBJECT TO THE CONTRACTOR'S VERIFICATION OF THE FIELD.
5. THE CONTRACTOR SHALL BE SOLELY AND COMPLETELY RESPONSIBLE FOR THE PROTECTION OF ALL UTILITIES EXISTING IN THE FIELD AND THE INFORMATION SHOWN ON THESE DRAWINGS IS SUBJECT TO THE CONTRACTOR'S VERIFICATION OF THE FIELD.
6. THE CONTRACTOR SHALL BE RESPONSIBLE FOR THE PROTECTION OF ALL UTILITIES EXISTING IN THE FIELD AND THE INFORMATION SHOWN ON THESE DRAWINGS IS SUBJECT TO THE CONTRACTOR'S VERIFICATION OF THE FIELD.
7. THE CONTRACTOR SHALL CALL CARSON CITY PUBLIC WORKS AT (702) 887-2355 AT LEAST 48 HOURS PRIOR TO THE START OF CONSTRUCTION.
8. THE CONTRACTOR SHALL BE RESPONSIBLE FOR THE PROTECTION OF ALL UTILITIES EXISTING IN THE FIELD AND THE INFORMATION SHOWN ON THESE DRAWINGS IS SUBJECT TO THE CONTRACTOR'S VERIFICATION OF THE FIELD.
9. THE CONTRACTOR SHALL BE RESPONSIBLE FOR THE PROTECTION OF ALL UTILITIES EXISTING IN THE FIELD AND THE INFORMATION SHOWN ON THESE DRAWINGS IS SUBJECT TO THE CONTRACTOR'S VERIFICATION OF THE FIELD.
10. THE CONTRACTOR SHALL BE RESPONSIBLE FOR THE PROTECTION OF ALL UTILITIES EXISTING IN THE FIELD AND THE INFORMATION SHOWN ON THESE DRAWINGS IS SUBJECT TO THE CONTRACTOR'S VERIFICATION OF THE FIELD.

**NDOT/CARSON CITY AGREEMENT PLANS**

FOR INFORMATION ONLY  
 NOT FOR CONSTRUCTION

**REVIEWED FOR CITY REQUIREMENTS:**

LAWRENCE A. WERNER, P.E./R.L.S. - CITY ENGINEER DATE \_\_\_\_\_  
 DEVELOPMENT ENGINEERING DATE \_\_\_\_\_  
 TOM HOFFERT, PUBLIC WORKS OPERATIONS MANAGER DATE \_\_\_\_\_

APPLICATION NO. \_\_\_\_\_  
 NDOT APPLICATION NO. \_\_\_\_\_



**PRELIMINARY**  
 09/20/06

REV.	DATE	DESCRIPTION	BY	APP.

**CARSON CITY FREEWAY PHASE 2A**  
 UTILITY RELOCATIONS  
 PROJECT NO. 001-8010  
 E. FIFTH ST. FREEWAY EXT. UNDER CONSTRUCTION IN BRUNN  
 STA. 22+50 TO STA. 25+50  
 SANITARY SEWER RELOCATION

SHEET  
**3 E**  
 OF  
 34

- CONSTRUCTION NOTES:**
1. VERIFY ALL DIMENSIONS AND CONDITIONS OF EXISTING UTILITIES AND STRUCTURES PRIOR TO CONSTRUCTION.
  2. ALL NEW UTILITIES SHALL BE INSTALLED IN ACCORDANCE WITH THE CITY ENGINEERING DEPARTMENT SPECIFICATIONS.
  3. ALL NEW UTILITIES SHALL BE INSTALLED AT A MINIMUM 18" BELOW THE FINISHED GROUND SURFACE UNLESS OTHERWISE NOTED.
  4. ALL NEW UTILITIES SHALL BE INSTALLED WITH A MINIMUM COVER OF 18" UNLESS OTHERWISE NOTED.
  5. ALL NEW UTILITIES SHALL BE INSTALLED WITH A MINIMUM COVER OF 18" UNLESS OTHERWISE NOTED.
  6. ALL NEW UTILITIES SHALL BE INSTALLED WITH A MINIMUM COVER OF 18" UNLESS OTHERWISE NOTED.
  7. ALL NEW UTILITIES SHALL BE INSTALLED WITH A MINIMUM COVER OF 18" UNLESS OTHERWISE NOTED.
  8. ALL NEW UTILITIES SHALL BE INSTALLED WITH A MINIMUM COVER OF 18" UNLESS OTHERWISE NOTED.
  9. ALL NEW UTILITIES SHALL BE INSTALLED WITH A MINIMUM COVER OF 18" UNLESS OTHERWISE NOTED.
  10. ALL NEW UTILITIES SHALL BE INSTALLED WITH A MINIMUM COVER OF 18" UNLESS OTHERWISE NOTED.

**NDOT/CARSON CITY  
 AGREEMENT PLANS**  
 FOR INFORMATION ONLY  
 NOT FOR CONSTRUCTION

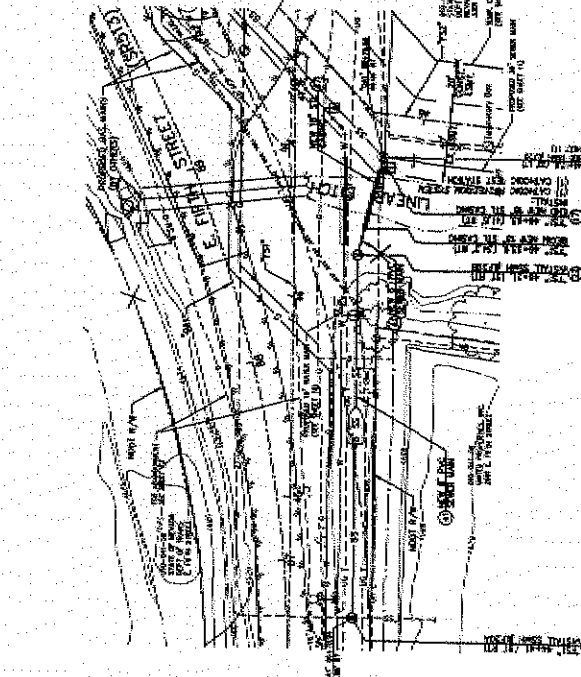

PLAN - E. FIFTH STREET (0+01')  
 SCALE: 1" = 30'

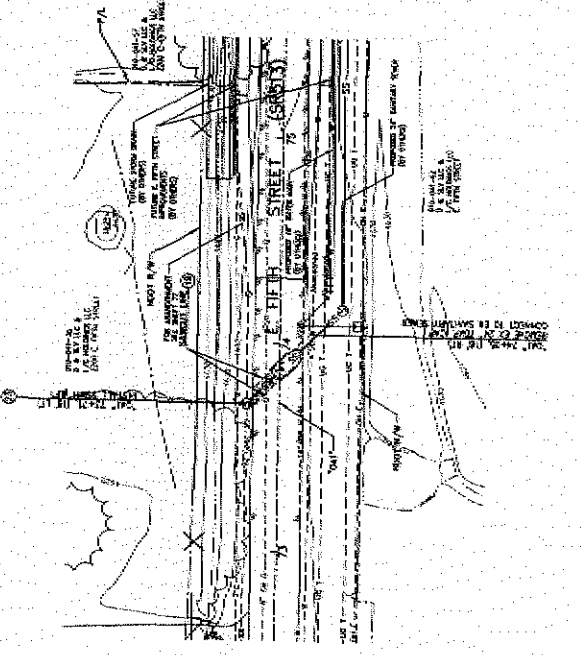

PLAN - E. FIFTH STREET (0+01')  
 SCALE: 1" = 30'

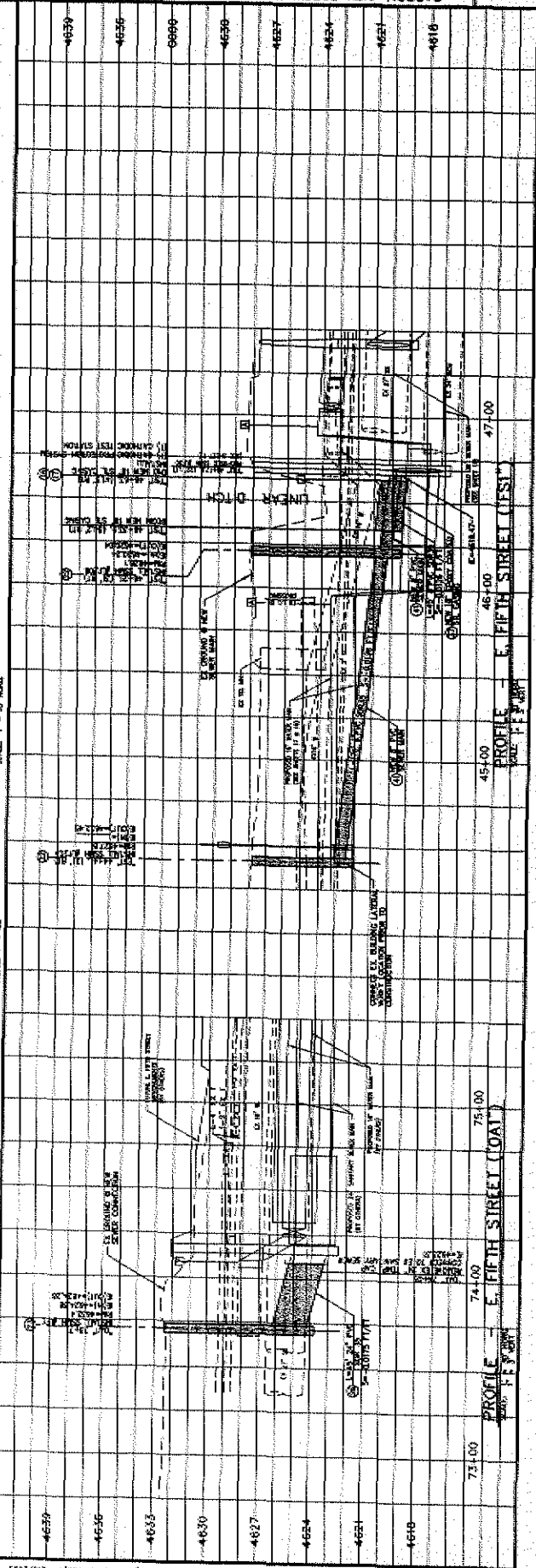

PROFILE - E. FIFTH STREET (0+01')  
 SCALE: 1" = 30'

THIS DRAWING WAS PREPARED BY THE ENGINEERING DEPARTMENT OF THE CITY ENGINEER, CARSON CITY, NEVADA, AND IS NOT TO BE USED FOR ANY OTHER PROJECT WITHOUT THE WRITTEN PERMISSION OF THE CITY ENGINEER.





CONSTRUCTION NOTES

- 1. GENERAL NOTES
- 2. CONTRACTOR TO VERIFY ALL UTILITIES AND RECORD THEM PRIOR TO CONSTRUCTION
- 3. CONTRACTOR TO VERIFY ALL CONCRETE DIT-DOWS ARE SET TO PROFILES
- 4. CONTRACTOR TO VERIFY ALL CONCRETE IS TO BE SET TO PROFILES
- 5. CONTRACTOR TO VERIFY ALL CONCRETE IS TO BE SET TO PROFILES
- 6. CONTRACTOR TO VERIFY ALL CONCRETE IS TO BE SET TO PROFILES
- 7. CONTRACTOR TO VERIFY ALL CONCRETE IS TO BE SET TO PROFILES
- 8. CONTRACTOR TO VERIFY ALL CONCRETE IS TO BE SET TO PROFILES
- 9. CONTRACTOR TO VERIFY ALL CONCRETE IS TO BE SET TO PROFILES
- 10. CONTRACTOR TO VERIFY ALL CONCRETE IS TO BE SET TO PROFILES
- 11. CONTRACTOR TO VERIFY ALL CONCRETE IS TO BE SET TO PROFILES
- 12. CONTRACTOR TO VERIFY ALL CONCRETE IS TO BE SET TO PROFILES
- 13. CONTRACTOR TO VERIFY ALL CONCRETE IS TO BE SET TO PROFILES
- 14. CONTRACTOR TO VERIFY ALL CONCRETE IS TO BE SET TO PROFILES
- 15. CONTRACTOR TO VERIFY ALL CONCRETE IS TO BE SET TO PROFILES
- 16. CONTRACTOR TO VERIFY ALL CONCRETE IS TO BE SET TO PROFILES
- 17. CONTRACTOR TO VERIFY ALL CONCRETE IS TO BE SET TO PROFILES
- 18. CONTRACTOR TO VERIFY ALL CONCRETE IS TO BE SET TO PROFILES
- 19. CONTRACTOR TO VERIFY ALL CONCRETE IS TO BE SET TO PROFILES
- 20. CONTRACTOR TO VERIFY ALL CONCRETE IS TO BE SET TO PROFILES

PRELIMINARY  
09/20/06

CARSON CITY  
PUBLIC WORKS DEPARTMENT  
3005 WINTER WAY, CARSON CITY, NEVADA 89702  
THE LOUIS BERGER GROUP, INC.  
15400 W. HAYDEN AVE.  
SPRING VALLEY, CA 94576

### PLAN - EASEMENT

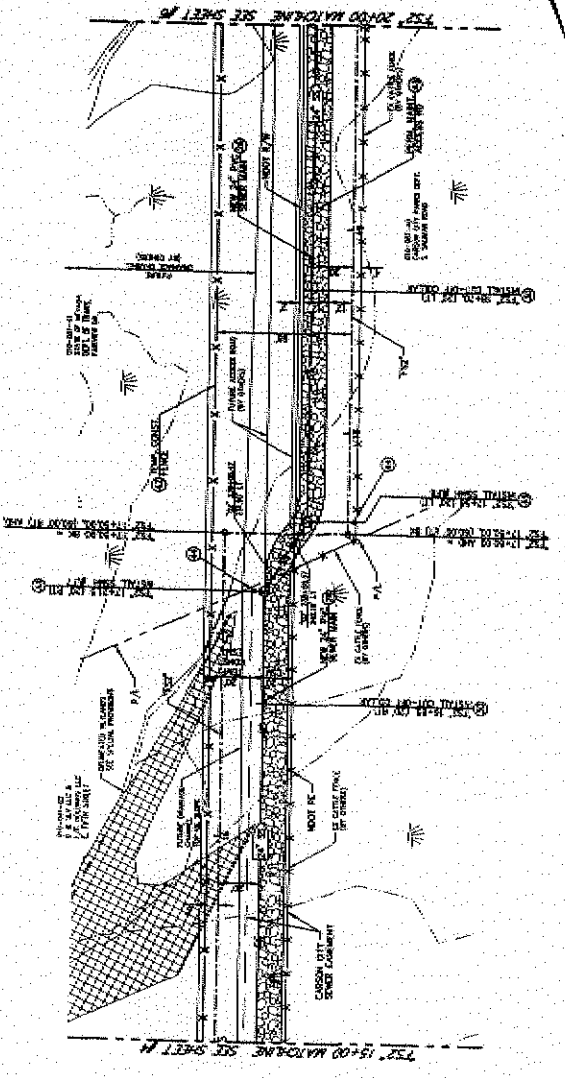

SCALE  
1" = 40'  
HORIZ. SCALE  
1" = 80'

### NDOT/CARSON CITY AGREEMENT PLANS

FOR INFORMATION ONLY  
NOT FOR CONSTRUCTION

REV.	DATE	DESCRIPTION	BY	APP'D.
1				
2				
3				
4				
5				
6				
7				
8				
9				
10				
11				
12				
13				
14				
15				
16				
17				
18				
19				
20				
21				
22				
23				
24				
25				
26				
27				
28				
29				
30				
31				
32				
33				
34				
35				
36				
37				
38				
39				
40				
41				
42				
43				
44				
45				
46				
47				
48				
49				
50				

SHEET  
**31**  
OF  
**34**

CARSON CITY FREEWAY PHASE 2A  
UTILITY RELOCATIONS  
E. FROM SE FREEWAY EAST LANE FROM 20 BIRTH WAY  
PROJECT NO. 00-8018  
SANITARY SEWER RELOCATION  
"FS2" 15+00 TO "FS2" 20+00

REFERENCE PLAN 00-8018-2A-20-20-00-00 - 15+00 TO 17+00 - 17+00 TO 19+00 - 19+00 TO 20+00 - 20+00 TO 21+00 - 21+00 TO 22+00 - 22+00 TO 23+00 - 23+00 TO 24+00 - 24+00 TO 25+00 - 25+00 TO 26+00 - 26+00 TO 27+00 - 27+00 TO 28+00 - 28+00 TO 29+00 - 29+00 TO 30+00 - 30+00 TO 31+00 - 31+00 TO 32+00 - 32+00 TO 33+00 - 33+00 TO 34+00 - 34+00 TO 35+00 - 35+00 TO 36+00 - 36+00 TO 37+00 - 37+00 TO 38+00 - 38+00 TO 39+00 - 39+00 TO 40+00 - 40+00 TO 41+00 - 41+00 TO 42+00 - 42+00 TO 43+00 - 43+00 TO 44+00 - 44+00 TO 45+00 - 45+00 TO 46+00 - 46+00 TO 47+00 - 47+00 TO 48+00 - 48+00 TO 49+00 - 49+00 TO 50+00 - 50+00 TO 51+00 - 51+00 TO 52+00 - 52+00 TO 53+00 - 53+00 TO 54+00 - 54+00 TO 55+00 - 55+00 TO 56+00 - 56+00 TO 57+00 - 57+00 TO 58+00 - 58+00 TO 59+00 - 59+00 TO 60+00 - 60+00 TO 61+00 - 61+00 TO 62+00 - 62+00 TO 63+00 - 63+00 TO 64+00 - 64+00 TO 65+00 - 65+00 TO 66+00 - 66+00 TO 67+00 - 67+00 TO 68+00 - 68+00 TO 69+00 - 69+00 TO 70+00 - 70+00 TO 71+00 - 71+00 TO 72+00 - 72+00 TO 73+00 - 73+00 TO 74+00 - 74+00 TO 75+00 - 75+00 TO 76+00 - 76+00 TO 77+00 - 77+00 TO 78+00 - 78+00 TO 79+00 - 79+00 TO 80+00 - 80+00 TO 81+00 - 81+00 TO 82+00 - 82+00 TO 83+00 - 83+00 TO 84+00 - 84+00 TO 85+00 - 85+00 TO 86+00 - 86+00 TO 87+00 - 87+00 TO 88+00 - 88+00 TO 89+00 - 89+00 TO 90+00 - 90+00 TO 91+00 - 91+00 TO 92+00 - 92+00 TO 93+00 - 93+00 TO 94+00 - 94+00 TO 95+00 - 95+00 TO 96+00 - 96+00 TO 97+00 - 97+00 TO 98+00 - 98+00 TO 99+00 - 99+00 TO 100+00





REV.	DATE	DESCRIPTION

- CONSTRUCTION NOTES:**
1. INSTALL CHANGES INDICATED ON THE ORIGINAL PLANS SHEET.
  2. ALL UTILITY AND WWTPL RELOCATIONS SHALL BE IN ACCORDANCE WITH THE "ECS" TOLLON.
  3. INSTALL CHANGES TO THE STATION PER DETAIL SHEET 1.
  4. INSTALL 18" DIA. PVC SANITARY SEWER WITH 4" DIA. RCP MANHOLE PER DETAIL SHEET 1.
  5. BRUSHING AND C-200 (MINIMUM).
  6. BRUSHING AND C-200 (MINIMUM).
  7. BRUSHING AND C-200 (MINIMUM).
  8. BRUSHING AND C-200 (MINIMUM).
  9. BRUSHING AND C-200 (MINIMUM).
  10. BRUSHING AND C-200 (MINIMUM).
  11. BRUSHING AND C-200 (MINIMUM).
  12. BRUSHING AND C-200 (MINIMUM).
  13. BRUSHING AND C-200 (MINIMUM).
  14. BRUSHING AND C-200 (MINIMUM).
  15. BRUSHING AND C-200 (MINIMUM).
  16. BRUSHING AND C-200 (MINIMUM).
  17. BRUSHING AND C-200 (MINIMUM).
  18. BRUSHING AND C-200 (MINIMUM).
  19. BRUSHING AND C-200 (MINIMUM).
  20. BRUSHING AND C-200 (MINIMUM).
  21. BRUSHING AND C-200 (MINIMUM).
  22. BRUSHING AND C-200 (MINIMUM).
  23. BRUSHING AND C-200 (MINIMUM).
  24. BRUSHING AND C-200 (MINIMUM).
  25. BRUSHING AND C-200 (MINIMUM).
  26. BRUSHING AND C-200 (MINIMUM).
  27. BRUSHING AND C-200 (MINIMUM).
  28. BRUSHING AND C-200 (MINIMUM).
  29. BRUSHING AND C-200 (MINIMUM).
  30. BRUSHING AND C-200 (MINIMUM).
  31. BRUSHING AND C-200 (MINIMUM).
  32. BRUSHING AND C-200 (MINIMUM).
  33. BRUSHING AND C-200 (MINIMUM).
  34. BRUSHING AND C-200 (MINIMUM).
  35. BRUSHING AND C-200 (MINIMUM).
  36. BRUSHING AND C-200 (MINIMUM).
  37. BRUSHING AND C-200 (MINIMUM).
  38. BRUSHING AND C-200 (MINIMUM).
  39. BRUSHING AND C-200 (MINIMUM).
  40. BRUSHING AND C-200 (MINIMUM).
  41. BRUSHING AND C-200 (MINIMUM).
  42. BRUSHING AND C-200 (MINIMUM).
  43. BRUSHING AND C-200 (MINIMUM).
  44. BRUSHING AND C-200 (MINIMUM).
  45. BRUSHING AND C-200 (MINIMUM).
  46. BRUSHING AND C-200 (MINIMUM).
  47. BRUSHING AND C-200 (MINIMUM).
  48. BRUSHING AND C-200 (MINIMUM).
  49. BRUSHING AND C-200 (MINIMUM).
  50. BRUSHING AND C-200 (MINIMUM).
  51. BRUSHING AND C-200 (MINIMUM).
  52. BRUSHING AND C-200 (MINIMUM).
  53. BRUSHING AND C-200 (MINIMUM).
  54. BRUSHING AND C-200 (MINIMUM).
  55. BRUSHING AND C-200 (MINIMUM).
  56. BRUSHING AND C-200 (MINIMUM).
  57. BRUSHING AND C-200 (MINIMUM).
  58. BRUSHING AND C-200 (MINIMUM).
  59. BRUSHING AND C-200 (MINIMUM).
  60. BRUSHING AND C-200 (MINIMUM).
  61. BRUSHING AND C-200 (MINIMUM).
  62. BRUSHING AND C-200 (MINIMUM).
  63. BRUSHING AND C-200 (MINIMUM).
  64. BRUSHING AND C-200 (MINIMUM).
  65. BRUSHING AND C-200 (MINIMUM).
  66. BRUSHING AND C-200 (MINIMUM).
  67. BRUSHING AND C-200 (MINIMUM).
  68. BRUSHING AND C-200 (MINIMUM).
  69. BRUSHING AND C-200 (MINIMUM).
  70. BRUSHING AND C-200 (MINIMUM).
  71. BRUSHING AND C-200 (MINIMUM).
  72. BRUSHING AND C-200 (MINIMUM).
  73. BRUSHING AND C-200 (MINIMUM).
  74. BRUSHING AND C-200 (MINIMUM).
  75. BRUSHING AND C-200 (MINIMUM).
  76. BRUSHING AND C-200 (MINIMUM).
  77. BRUSHING AND C-200 (MINIMUM).
  78. BRUSHING AND C-200 (MINIMUM).
  79. BRUSHING AND C-200 (MINIMUM).
  80. BRUSHING AND C-200 (MINIMUM).
  81. BRUSHING AND C-200 (MINIMUM).
  82. BRUSHING AND C-200 (MINIMUM).
  83. BRUSHING AND C-200 (MINIMUM).
  84. BRUSHING AND C-200 (MINIMUM).
  85. BRUSHING AND C-200 (MINIMUM).
  86. BRUSHING AND C-200 (MINIMUM).
  87. BRUSHING AND C-200 (MINIMUM).
  88. BRUSHING AND C-200 (MINIMUM).
  89. BRUSHING AND C-200 (MINIMUM).
  90. BRUSHING AND C-200 (MINIMUM).
  91. BRUSHING AND C-200 (MINIMUM).
  92. BRUSHING AND C-200 (MINIMUM).
  93. BRUSHING AND C-200 (MINIMUM).
  94. BRUSHING AND C-200 (MINIMUM).
  95. BRUSHING AND C-200 (MINIMUM).
  96. BRUSHING AND C-200 (MINIMUM).
  97. BRUSHING AND C-200 (MINIMUM).
  98. BRUSHING AND C-200 (MINIMUM).
  99. BRUSHING AND C-200 (MINIMUM).
  100. BRUSHING AND C-200 (MINIMUM).

**NDOT/CARSON CITY AGREEMENT PLANS**

FOR INFORMATION ONLY  
NOT FOR CONSTRUCTION

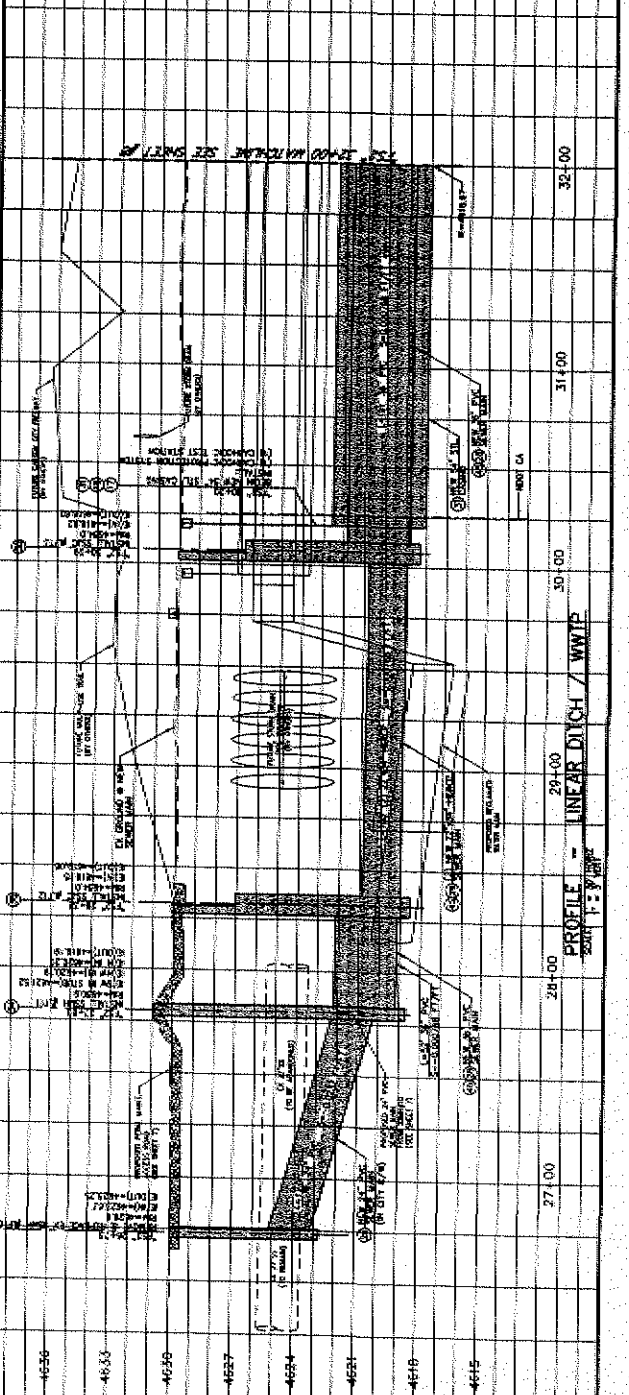
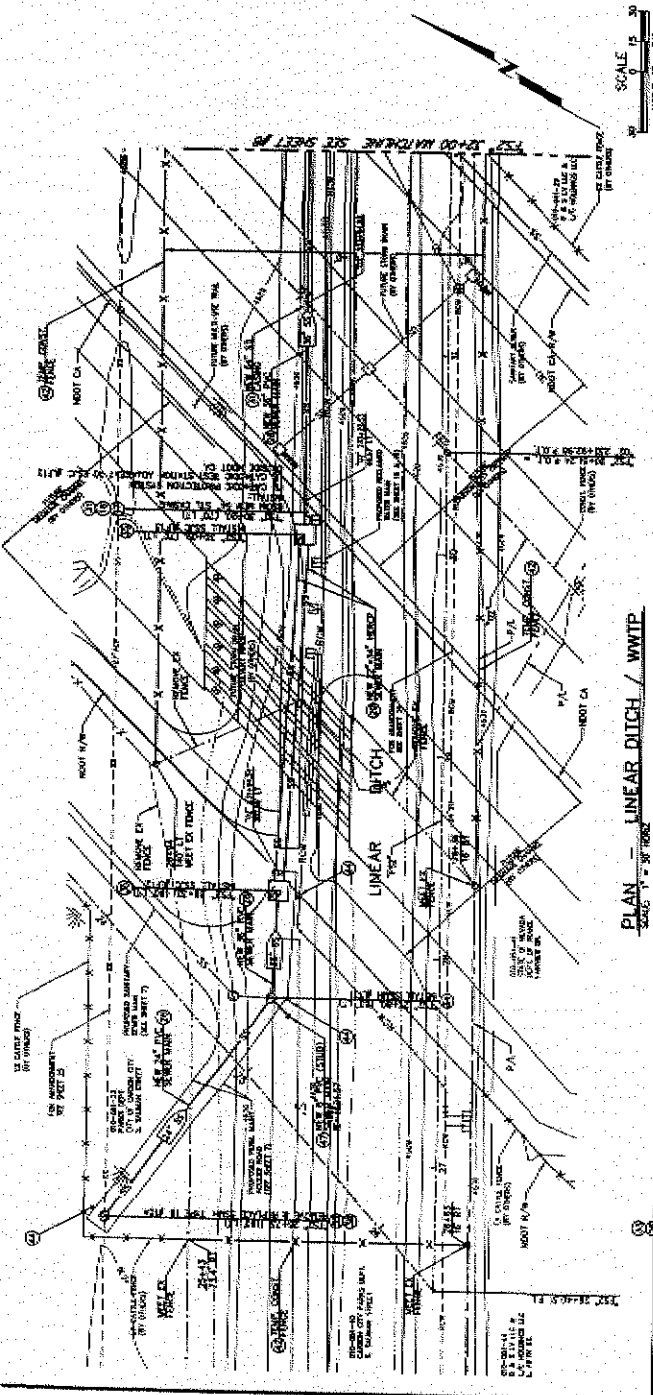





PRELIMINARY  
 09/20/05

REV.	DATE	DESCRIPTION	BY	APP'D.

CARSON CITY FREEWAY PHASE 2A  
 UTILITY RELOCATIONS  
 E. MAIN ST. FREEWAY EAST, LINEAR ENTRY TO RIGHT WAY  
 PROJECT NO. 00-6019  
 "T&E" 41+00 to "T&E" 46+50  
 SANITARY SEWER RELOCATION

SHEET  
**10E**  
 OF  
 34

- CONSTRUCTION NOTES**
- 1. SHALL BE 48" PVC CSM PIPE, 34.5' SPAN, 15' DEPTH, 15' COVER.
  - 2. CONSTRUCTION TO BE COMPLETED WITHIN 60 DAYS OF CONTRACT SIGNATURE.
  - 3. ALL MATERIALS SHALL BE APPROVED BY THE CITY ENGINEER AND PLACED IN THE MIDDLE OF THE ROAD TO BE PROTECTED BY CONSTRUCTION BARRICADES AND FLAGMEN.
  - 4. ALL MATERIALS SHALL BE APPROVED BY THE CITY ENGINEER AND PLACED IN THE MIDDLE OF THE ROAD TO BE PROTECTED BY CONSTRUCTION BARRICADES AND FLAGMEN.
  - 5. ALL MATERIALS SHALL BE APPROVED BY THE CITY ENGINEER AND PLACED IN THE MIDDLE OF THE ROAD TO BE PROTECTED BY CONSTRUCTION BARRICADES AND FLAGMEN.
  - 6. ALL MATERIALS SHALL BE APPROVED BY THE CITY ENGINEER AND PLACED IN THE MIDDLE OF THE ROAD TO BE PROTECTED BY CONSTRUCTION BARRICADES AND FLAGMEN.
  - 7. ALL MATERIALS SHALL BE APPROVED BY THE CITY ENGINEER AND PLACED IN THE MIDDLE OF THE ROAD TO BE PROTECTED BY CONSTRUCTION BARRICADES AND FLAGMEN.
  - 8. ALL MATERIALS SHALL BE APPROVED BY THE CITY ENGINEER AND PLACED IN THE MIDDLE OF THE ROAD TO BE PROTECTED BY CONSTRUCTION BARRICADES AND FLAGMEN.
  - 9. ALL MATERIALS SHALL BE APPROVED BY THE CITY ENGINEER AND PLACED IN THE MIDDLE OF THE ROAD TO BE PROTECTED BY CONSTRUCTION BARRICADES AND FLAGMEN.
  - 10. ALL MATERIALS SHALL BE APPROVED BY THE CITY ENGINEER AND PLACED IN THE MIDDLE OF THE ROAD TO BE PROTECTED BY CONSTRUCTION BARRICADES AND FLAGMEN.

**NDOT/CARSON CITY AGREEMENT PLANS**

**FOR INFORMATION ONLY  
 NOT FOR CONSTRUCTION**

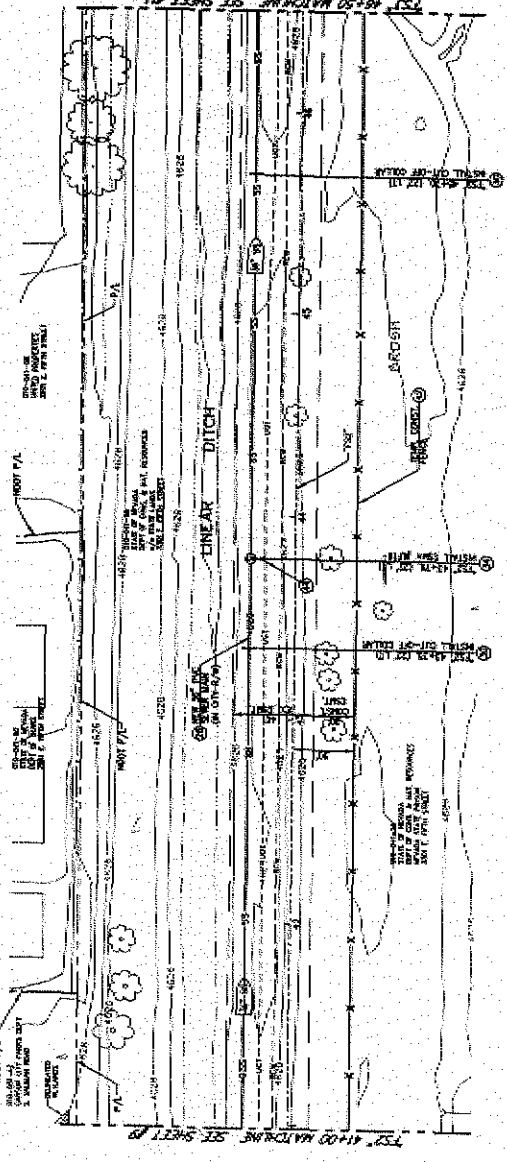

**PLAN - LINEAR DITCH / WWTP**  
 SCALE 1" = 30' HORIZ.

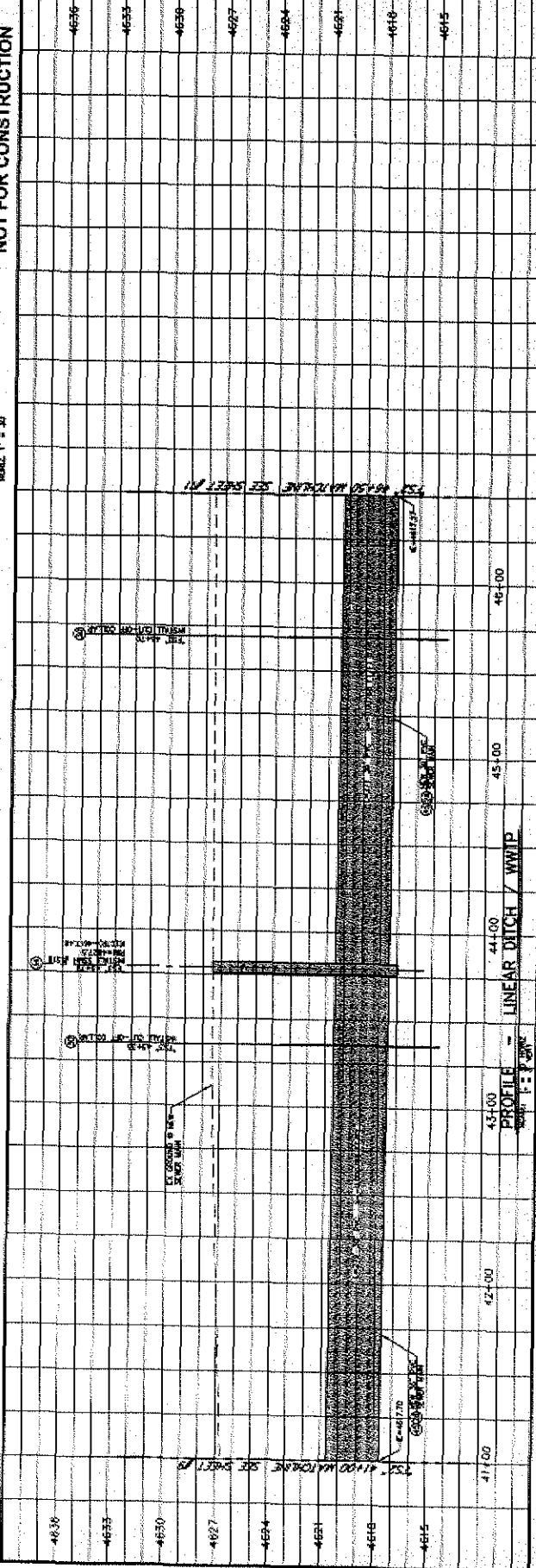

**PROFILE - LINEAR DITCH / WWTP**  
 SCALE 1" = 30' VERT.

NO.	DATE	DESCRIPTION	BY	APP'D

- CONSTRUCTION NOTES:**
- INSTALL AS SHOWN OR AS NOTED. SEE ALL NOTES AND SPECIFICATIONS FOR MATERIALS, DIMENSIONS AND CONSTRUCTION METHODS. THE CONTRACTOR SHALL BE RESPONSIBLE FOR OBTAINING ALL NECESSARY PERMITS AND APPROVALS FROM THE APPROPRIATE AGENCIES.
  - INSTALL 24" RECLAIMED WATER MAIN AS SHOWN. SEE NOTES AND SPECIFICATIONS FOR MATERIALS, DIMENSIONS AND CONSTRUCTION METHODS. THE CONTRACTOR SHALL BE RESPONSIBLE FOR OBTAINING ALL NECESSARY PERMITS AND APPROVALS FROM THE APPROPRIATE AGENCIES.
  - INSTALL 12" SANITARY SEWER AS SHOWN. SEE NOTES AND SPECIFICATIONS FOR MATERIALS, DIMENSIONS AND CONSTRUCTION METHODS. THE CONTRACTOR SHALL BE RESPONSIBLE FOR OBTAINING ALL NECESSARY PERMITS AND APPROVALS FROM THE APPROPRIATE AGENCIES.
  - INSTALL 18" SANITARY SEWER AS SHOWN. SEE NOTES AND SPECIFICATIONS FOR MATERIALS, DIMENSIONS AND CONSTRUCTION METHODS. THE CONTRACTOR SHALL BE RESPONSIBLE FOR OBTAINING ALL NECESSARY PERMITS AND APPROVALS FROM THE APPROPRIATE AGENCIES.
  - INSTALL 24" SANITARY SEWER AS SHOWN. SEE NOTES AND SPECIFICATIONS FOR MATERIALS, DIMENSIONS AND CONSTRUCTION METHODS. THE CONTRACTOR SHALL BE RESPONSIBLE FOR OBTAINING ALL NECESSARY PERMITS AND APPROVALS FROM THE APPROPRIATE AGENCIES.
  - INSTALL 30" SANITARY SEWER AS SHOWN. SEE NOTES AND SPECIFICATIONS FOR MATERIALS, DIMENSIONS AND CONSTRUCTION METHODS. THE CONTRACTOR SHALL BE RESPONSIBLE FOR OBTAINING ALL NECESSARY PERMITS AND APPROVALS FROM THE APPROPRIATE AGENCIES.
  - INSTALL 36" SANITARY SEWER AS SHOWN. SEE NOTES AND SPECIFICATIONS FOR MATERIALS, DIMENSIONS AND CONSTRUCTION METHODS. THE CONTRACTOR SHALL BE RESPONSIBLE FOR OBTAINING ALL NECESSARY PERMITS AND APPROVALS FROM THE APPROPRIATE AGENCIES.
  - INSTALL 42" SANITARY SEWER AS SHOWN. SEE NOTES AND SPECIFICATIONS FOR MATERIALS, DIMENSIONS AND CONSTRUCTION METHODS. THE CONTRACTOR SHALL BE RESPONSIBLE FOR OBTAINING ALL NECESSARY PERMITS AND APPROVALS FROM THE APPROPRIATE AGENCIES.
  - INSTALL 48" SANITARY SEWER AS SHOWN. SEE NOTES AND SPECIFICATIONS FOR MATERIALS, DIMENSIONS AND CONSTRUCTION METHODS. THE CONTRACTOR SHALL BE RESPONSIBLE FOR OBTAINING ALL NECESSARY PERMITS AND APPROVALS FROM THE APPROPRIATE AGENCIES.
  - INSTALL 54" SANITARY SEWER AS SHOWN. SEE NOTES AND SPECIFICATIONS FOR MATERIALS, DIMENSIONS AND CONSTRUCTION METHODS. THE CONTRACTOR SHALL BE RESPONSIBLE FOR OBTAINING ALL NECESSARY PERMITS AND APPROVALS FROM THE APPROPRIATE AGENCIES.
  - INSTALL 60" SANITARY SEWER AS SHOWN. SEE NOTES AND SPECIFICATIONS FOR MATERIALS, DIMENSIONS AND CONSTRUCTION METHODS. THE CONTRACTOR SHALL BE RESPONSIBLE FOR OBTAINING ALL NECESSARY PERMITS AND APPROVALS FROM THE APPROPRIATE AGENCIES.
  - INSTALL 66" SANITARY SEWER AS SHOWN. SEE NOTES AND SPECIFICATIONS FOR MATERIALS, DIMENSIONS AND CONSTRUCTION METHODS. THE CONTRACTOR SHALL BE RESPONSIBLE FOR OBTAINING ALL NECESSARY PERMITS AND APPROVALS FROM THE APPROPRIATE AGENCIES.
  - INSTALL 72" SANITARY SEWER AS SHOWN. SEE NOTES AND SPECIFICATIONS FOR MATERIALS, DIMENSIONS AND CONSTRUCTION METHODS. THE CONTRACTOR SHALL BE RESPONSIBLE FOR OBTAINING ALL NECESSARY PERMITS AND APPROVALS FROM THE APPROPRIATE AGENCIES.
  - INSTALL 78" SANITARY SEWER AS SHOWN. SEE NOTES AND SPECIFICATIONS FOR MATERIALS, DIMENSIONS AND CONSTRUCTION METHODS. THE CONTRACTOR SHALL BE RESPONSIBLE FOR OBTAINING ALL NECESSARY PERMITS AND APPROVALS FROM THE APPROPRIATE AGENCIES.
  - INSTALL 84" SANITARY SEWER AS SHOWN. SEE NOTES AND SPECIFICATIONS FOR MATERIALS, DIMENSIONS AND CONSTRUCTION METHODS. THE CONTRACTOR SHALL BE RESPONSIBLE FOR OBTAINING ALL NECESSARY PERMITS AND APPROVALS FROM THE APPROPRIATE AGENCIES.
  - INSTALL 90" SANITARY SEWER AS SHOWN. SEE NOTES AND SPECIFICATIONS FOR MATERIALS, DIMENSIONS AND CONSTRUCTION METHODS. THE CONTRACTOR SHALL BE RESPONSIBLE FOR OBTAINING ALL NECESSARY PERMITS AND APPROVALS FROM THE APPROPRIATE AGENCIES.
  - INSTALL 96" SANITARY SEWER AS SHOWN. SEE NOTES AND SPECIFICATIONS FOR MATERIALS, DIMENSIONS AND CONSTRUCTION METHODS. THE CONTRACTOR SHALL BE RESPONSIBLE FOR OBTAINING ALL NECESSARY PERMITS AND APPROVALS FROM THE APPROPRIATE AGENCIES.
  - INSTALL 102" SANITARY SEWER AS SHOWN. SEE NOTES AND SPECIFICATIONS FOR MATERIALS, DIMENSIONS AND CONSTRUCTION METHODS. THE CONTRACTOR SHALL BE RESPONSIBLE FOR OBTAINING ALL NECESSARY PERMITS AND APPROVALS FROM THE APPROPRIATE AGENCIES.
  - INSTALL 108" SANITARY SEWER AS SHOWN. SEE NOTES AND SPECIFICATIONS FOR MATERIALS, DIMENSIONS AND CONSTRUCTION METHODS. THE CONTRACTOR SHALL BE RESPONSIBLE FOR OBTAINING ALL NECESSARY PERMITS AND APPROVALS FROM THE APPROPRIATE AGENCIES.
  - INSTALL 114" SANITARY SEWER AS SHOWN. SEE NOTES AND SPECIFICATIONS FOR MATERIALS, DIMENSIONS AND CONSTRUCTION METHODS. THE CONTRACTOR SHALL BE RESPONSIBLE FOR OBTAINING ALL NECESSARY PERMITS AND APPROVALS FROM THE APPROPRIATE AGENCIES.
  - INSTALL 120" SANITARY SEWER AS SHOWN. SEE NOTES AND SPECIFICATIONS FOR MATERIALS, DIMENSIONS AND CONSTRUCTION METHODS. THE CONTRACTOR SHALL BE RESPONSIBLE FOR OBTAINING ALL NECESSARY PERMITS AND APPROVALS FROM THE APPROPRIATE AGENCIES.

**NDOT/CARSON CITY  
 AGREEMENT PLANS**

FOR INFORMATION ONLY  
 NOT FOR CONSTRUCTION

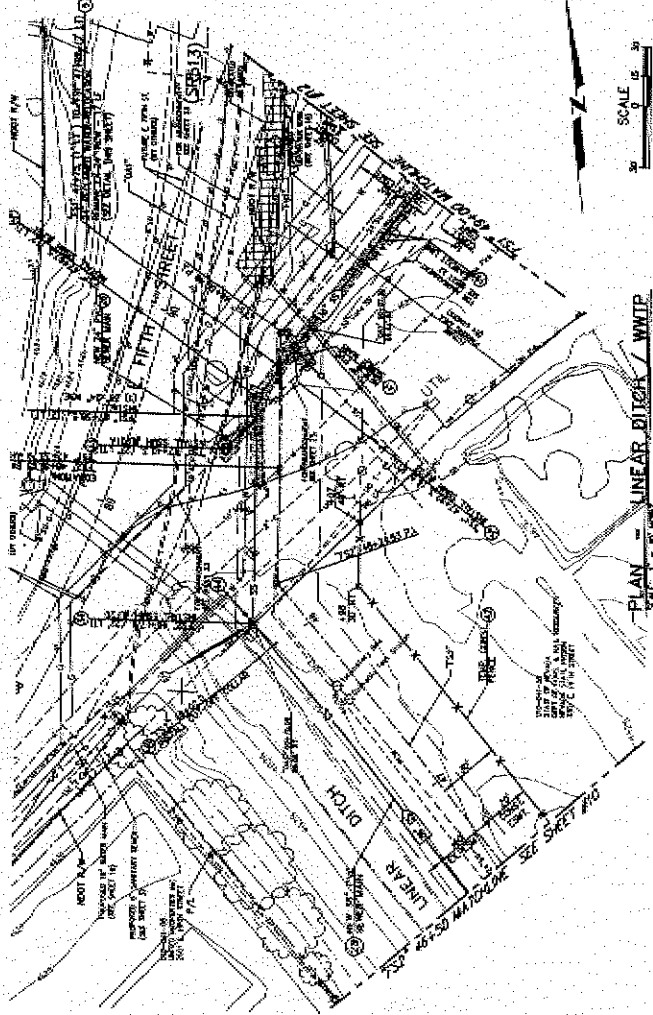

SCALE 1" = 30'  
 HORIZ. 1" = 30'

PLAN - LINEAR DITCH / WWTP  
 SCALE 1" = 30'

PROFILE - LINEAR DITCH / WWTP  
 SCALE 1" = 30'

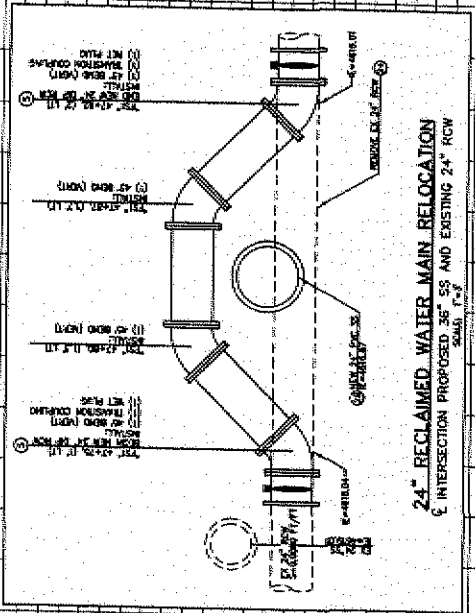

24" RECLAIMED WATER MAIN RELOCATION  
 @ INTERSECTION PROPOSED 24" CS AND EXISTING 24" RCW

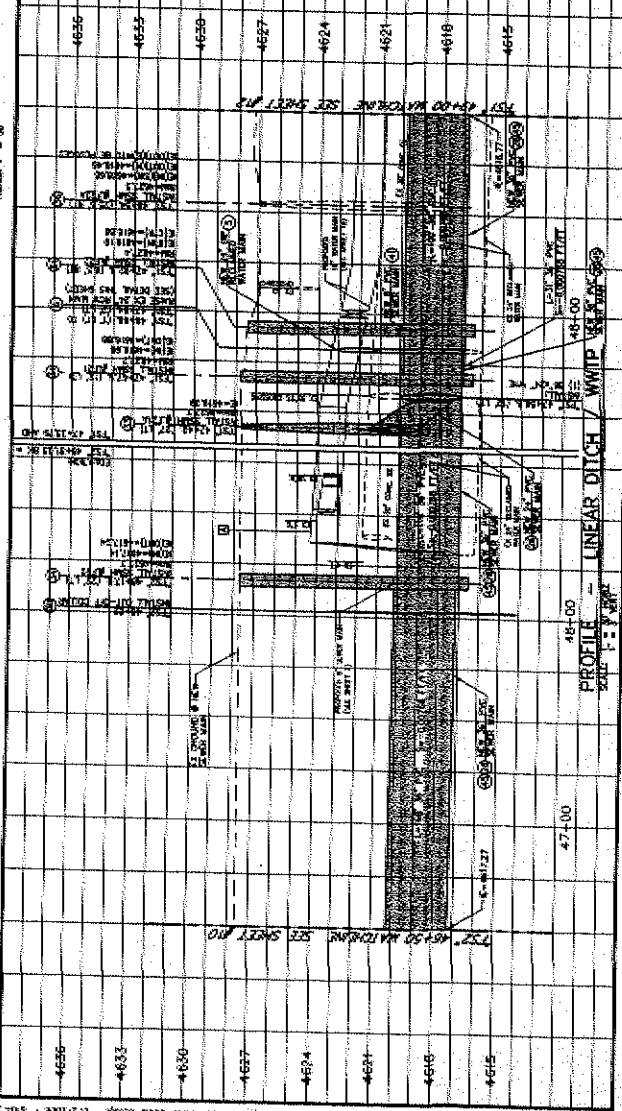

REFERENCE: FILED 9/20/06 AT Carson City, Nevada. DRAWING NO. DC-8818. SHEET NO. 11E OF 34. DATE: 09/20/06. BY: [Signature]



NO.	DATE	DESCRIPTION	BY

- CONSTRUCTION NOTES**
1. VERIFY ALL EXISTING UTILITIES AND RECORD THEM ACCORDING TO THE STANDARD SPECIFICATIONS FOR PUBLIC WORKS.
  2. ALL NEW UTILITIES SHALL BE INSTALLED IN ACCORDANCE WITH THE STANDARD SPECIFICATIONS FOR PUBLIC WORKS.
  3. ALL UTILITIES SHALL BE PROTECTED BY A MINIMUM OF 18" OF CONCRETE OR 24" OF ASPHALT.
  4. ALL UTILITIES SHALL BE INSTALLED IN ACCORDANCE WITH THE STANDARD SPECIFICATIONS FOR PUBLIC WORKS.
  5. ALL UTILITIES SHALL BE PROTECTED BY A MINIMUM OF 18" OF CONCRETE OR 24" OF ASPHALT.
  6. ALL UTILITIES SHALL BE INSTALLED IN ACCORDANCE WITH THE STANDARD SPECIFICATIONS FOR PUBLIC WORKS.
  7. ALL UTILITIES SHALL BE PROTECTED BY A MINIMUM OF 18" OF CONCRETE OR 24" OF ASPHALT.
  8. ALL UTILITIES SHALL BE INSTALLED IN ACCORDANCE WITH THE STANDARD SPECIFICATIONS FOR PUBLIC WORKS.
  9. ALL UTILITIES SHALL BE PROTECTED BY A MINIMUM OF 18" OF CONCRETE OR 24" OF ASPHALT.
  10. ALL UTILITIES SHALL BE INSTALLED IN ACCORDANCE WITH THE STANDARD SPECIFICATIONS FOR PUBLIC WORKS.

**NDOT/CARSON CITY  
 AGREEMENT PLANS**

**FOR INFORMATION ONLY  
 NOT FOR CONSTRUCTION**

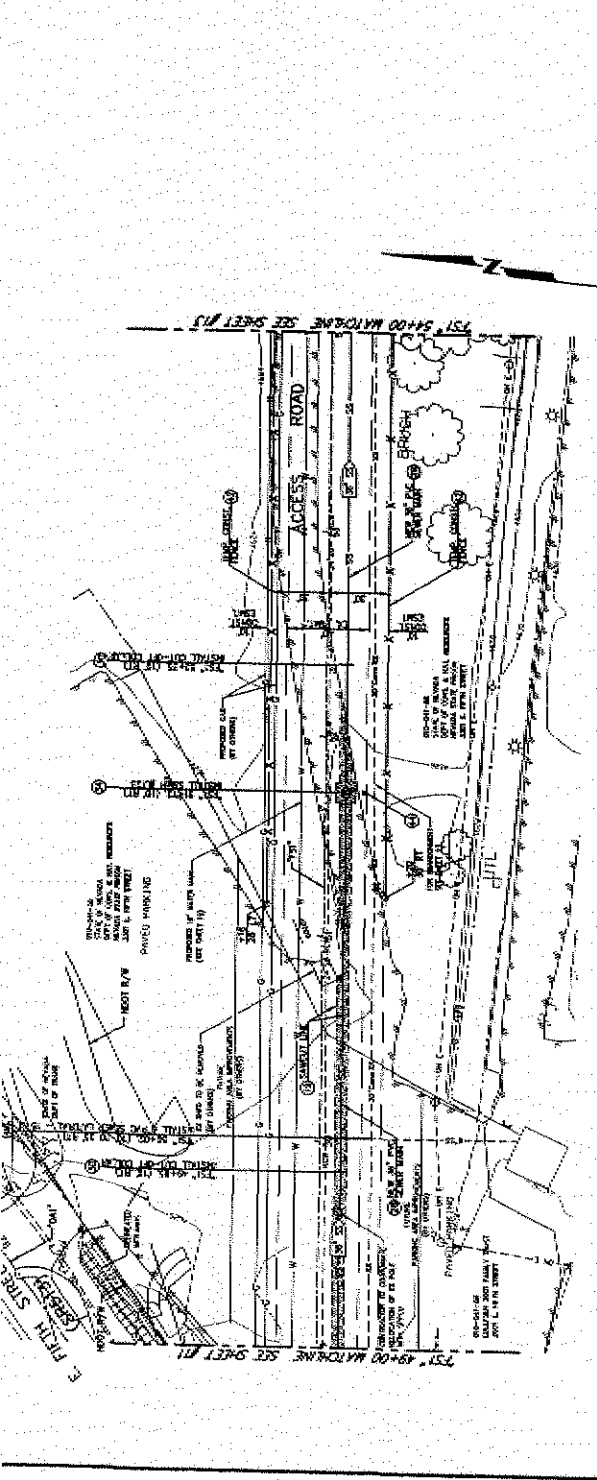

PLAN - LINEAR DITCH / WWTP  
 SCALE 1" = 20'

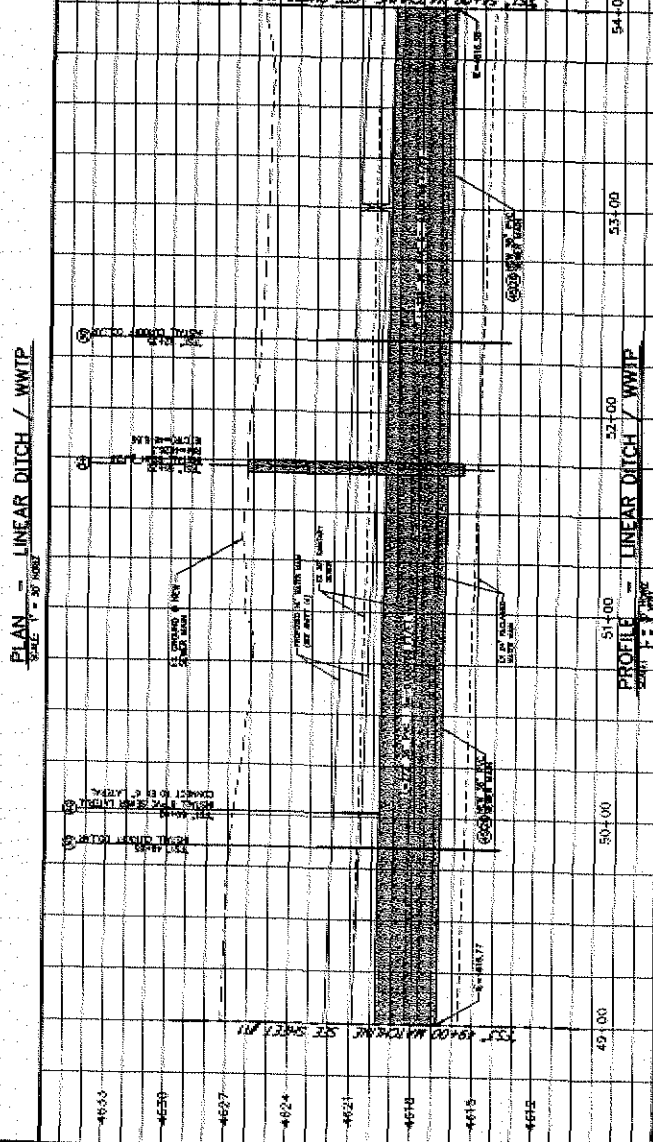

PROFILE - LINEAR DITCH / WWTP  
 SCALE 1" = 20'





PRELIMINARY  
 09/20/06

REV.	DATE	DESCRIPTION

- ### CONSTRUCTION NOTES
1. VERIFY ALL EXISTING UTILITY LOCATIONS AND DEPTHS WITH FIELD SURVEY DATA.
  2. EXISTING SANITARY SEWER MAIN SHALL BE RELOCATED TO THE WEST SIDE OF THE FREEWAY EAST. SEE SHEET 13 E FOR THE DETAILED PLAN.
  3. EXISTING 24" DIA. SANITARY SEWER MAIN SHALL BE RELOCATED TO THE WEST SIDE OF THE FREEWAY EAST. SEE SHEET 13 E FOR THE DETAILED PLAN.
  4. EXISTING 18" DIA. SANITARY SEWER MAIN SHALL BE RELOCATED TO THE WEST SIDE OF THE FREEWAY EAST. SEE SHEET 13 E FOR THE DETAILED PLAN.
  5. EXISTING 15" DIA. SANITARY SEWER MAIN SHALL BE RELOCATED TO THE WEST SIDE OF THE FREEWAY EAST. SEE SHEET 13 E FOR THE DETAILED PLAN.
  6. EXISTING 12" DIA. SANITARY SEWER MAIN SHALL BE RELOCATED TO THE WEST SIDE OF THE FREEWAY EAST. SEE SHEET 13 E FOR THE DETAILED PLAN.
  7. EXISTING 8" DIA. SANITARY SEWER MAIN SHALL BE RELOCATED TO THE WEST SIDE OF THE FREEWAY EAST. SEE SHEET 13 E FOR THE DETAILED PLAN.
  8. EXISTING 6" DIA. SANITARY SEWER MAIN SHALL BE RELOCATED TO THE WEST SIDE OF THE FREEWAY EAST. SEE SHEET 13 E FOR THE DETAILED PLAN.
  9. EXISTING 4" DIA. SANITARY SEWER MAIN SHALL BE RELOCATED TO THE WEST SIDE OF THE FREEWAY EAST. SEE SHEET 13 E FOR THE DETAILED PLAN.
  10. EXISTING 3" DIA. SANITARY SEWER MAIN SHALL BE RELOCATED TO THE WEST SIDE OF THE FREEWAY EAST. SEE SHEET 13 E FOR THE DETAILED PLAN.
  11. EXISTING 2" DIA. SANITARY SEWER MAIN SHALL BE RELOCATED TO THE WEST SIDE OF THE FREEWAY EAST. SEE SHEET 13 E FOR THE DETAILED PLAN.
  12. EXISTING 1 1/2" DIA. SANITARY SEWER MAIN SHALL BE RELOCATED TO THE WEST SIDE OF THE FREEWAY EAST. SEE SHEET 13 E FOR THE DETAILED PLAN.
  13. EXISTING 1" DIA. SANITARY SEWER MAIN SHALL BE RELOCATED TO THE WEST SIDE OF THE FREEWAY EAST. SEE SHEET 13 E FOR THE DETAILED PLAN.
  14. EXISTING 3/4" DIA. SANITARY SEWER MAIN SHALL BE RELOCATED TO THE WEST SIDE OF THE FREEWAY EAST. SEE SHEET 13 E FOR THE DETAILED PLAN.
  15. EXISTING 1/2" DIA. SANITARY SEWER MAIN SHALL BE RELOCATED TO THE WEST SIDE OF THE FREEWAY EAST. SEE SHEET 13 E FOR THE DETAILED PLAN.
  16. EXISTING 1/4" DIA. SANITARY SEWER MAIN SHALL BE RELOCATED TO THE WEST SIDE OF THE FREEWAY EAST. SEE SHEET 13 E FOR THE DETAILED PLAN.
  17. EXISTING 1/8" DIA. SANITARY SEWER MAIN SHALL BE RELOCATED TO THE WEST SIDE OF THE FREEWAY EAST. SEE SHEET 13 E FOR THE DETAILED PLAN.
  18. EXISTING 3/16" DIA. SANITARY SEWER MAIN SHALL BE RELOCATED TO THE WEST SIDE OF THE FREEWAY EAST. SEE SHEET 13 E FOR THE DETAILED PLAN.
  19. EXISTING 1/16" DIA. SANITARY SEWER MAIN SHALL BE RELOCATED TO THE WEST SIDE OF THE FREEWAY EAST. SEE SHEET 13 E FOR THE DETAILED PLAN.
  20. EXISTING 1/32" DIA. SANITARY SEWER MAIN SHALL BE RELOCATED TO THE WEST SIDE OF THE FREEWAY EAST. SEE SHEET 13 E FOR THE DETAILED PLAN.

**FOR INFORMATION ONLY  
 NOT FOR CONSTRUCTION**

## NDOT-CARSON CITY AGREEMENT PLANS

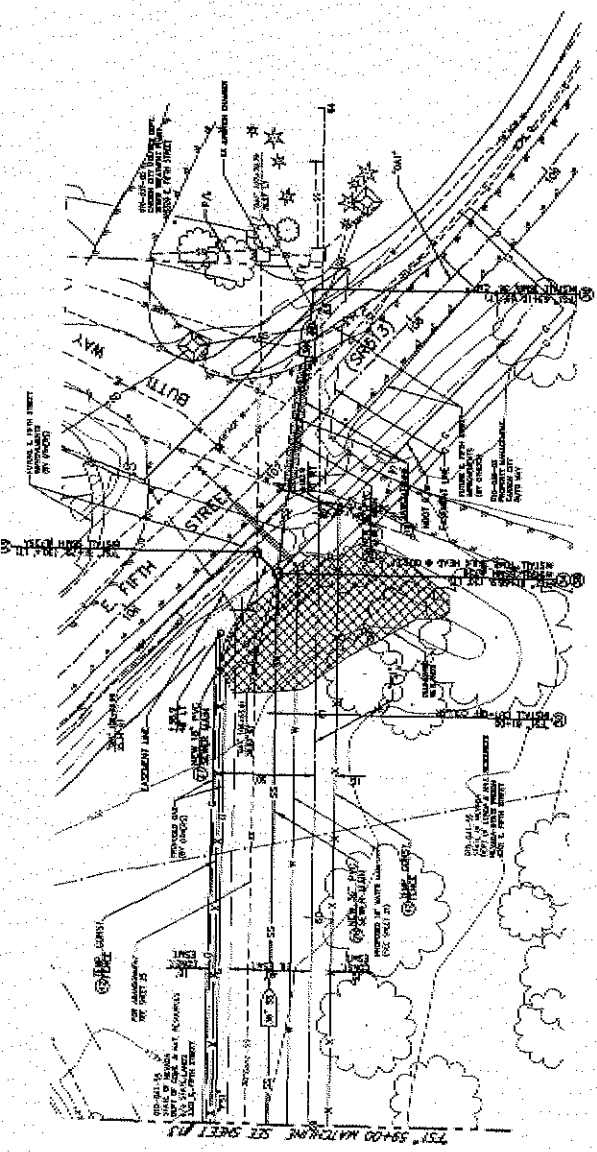

STATIONING	DEPTH (ELEVATION)	DESCRIPTION
59+00	4654	
59+10	4653	
59+20	4652	
59+30	4651	
59+40	4650	
59+50	4649	
59+60	4648	
59+70	4647	
59+80	4646	
59+90	4645	
60+00	4644	
60+10	4643	
60+20	4642	
60+30	4641	
60+40	4640	
60+50	4639	
60+60	4638	
60+70	4637	
60+80	4636	
60+90	4635	
61+00	4634	
61+10	4633	
61+20	4632	
61+30	4631	
61+40	4630	
61+50	4629	
61+60	4628	
61+70	4627	
61+80	4626	
61+90	4625	
62+00	4624	
62+10	4623	
62+20	4622	
62+30	4621	
62+40	4620	
62+50	4619	
62+60	4618	
62+70	4617	
62+80	4616	
62+90	4615	
63+00	4614	
63+10	4613	
63+20	4612	
63+30	4611	
63+40	4610	
63+50	4609	
63+60	4608	
63+70	4607	
63+80	4606	
63+90	4605	
64+00	4604	

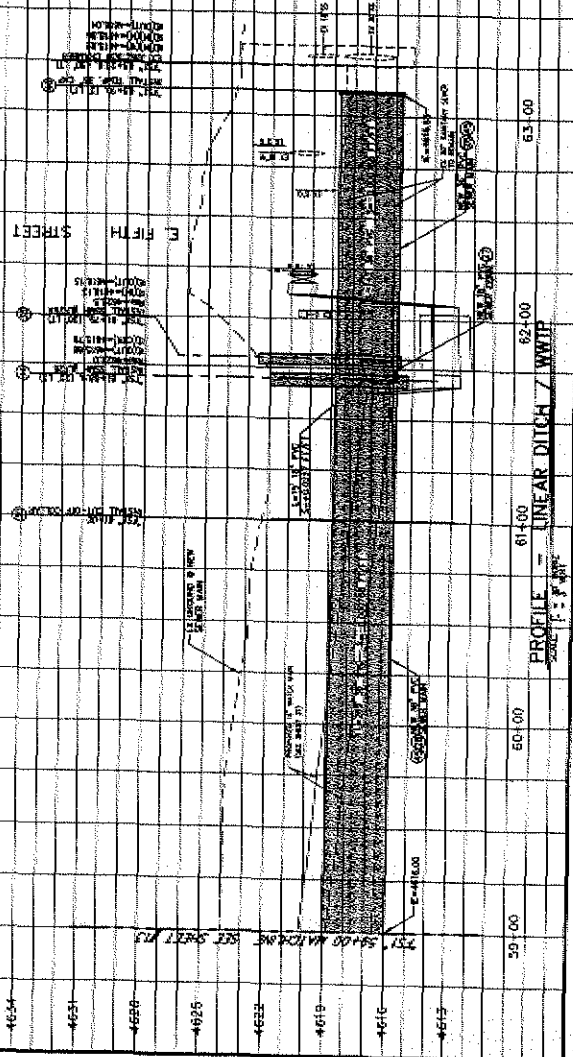





REV.	DATE	DESCRIPTION	BY	APP'D.

CARSON CITY PUBLIC WORKS DEPARTMENT  
 THE LOUIS BERGER GROUP INC.  
 2008 WINTER WAY, SUITE 100, CARSON CITY, NEVADA 89601  
 PHONE: 702-233-2155 FAX: 702-233-2155

- CONSTRUCTION NOTES:**
- INSTALL IN NOT OVER PROPOSED CLASS WATER MAIN WITH 12" WIDENING. SEE SHEET 2A-10 FOR DETAILS.
  - INSTALL IN NOT OVER PROPOSED CLASS 16" WATER MAIN WITH 12" WIDENING. SEE SHEET 2A-11 FOR DETAILS.
  - INSTALL IN NOT OVER PROPOSED CLASS 20" WATER MAIN WITH 12" WIDENING. SEE SHEET 2A-12 FOR DETAILS.
  - INSTALL IN NOT OVER PROPOSED CLASS 24" WATER MAIN WITH 12" WIDENING. SEE SHEET 2A-13 FOR DETAILS.
  - INSTALL IN NOT OVER PROPOSED CLASS 30" WATER MAIN WITH 12" WIDENING. SEE SHEET 2A-14 FOR DETAILS.
  - INSTALL IN NOT OVER PROPOSED CLASS 36" WATER MAIN WITH 12" WIDENING. SEE SHEET 2A-15 FOR DETAILS.
  - INSTALL IN NOT OVER PROPOSED CLASS 42" WATER MAIN WITH 12" WIDENING. SEE SHEET 2A-16 FOR DETAILS.
  - INSTALL IN NOT OVER PROPOSED CLASS 48" WATER MAIN WITH 12" WIDENING. SEE SHEET 2A-17 FOR DETAILS.
  - INSTALL IN NOT OVER PROPOSED CLASS 54" WATER MAIN WITH 12" WIDENING. SEE SHEET 2A-18 FOR DETAILS.
  - INSTALL IN NOT OVER PROPOSED CLASS 60" WATER MAIN WITH 12" WIDENING. SEE SHEET 2A-19 FOR DETAILS.
  - INSTALL IN NOT OVER PROPOSED CLASS 66" WATER MAIN WITH 12" WIDENING. SEE SHEET 2A-20 FOR DETAILS.
  - INSTALL IN NOT OVER PROPOSED CLASS 72" WATER MAIN WITH 12" WIDENING. SEE SHEET 2A-21 FOR DETAILS.
  - INSTALL IN NOT OVER PROPOSED CLASS 78" WATER MAIN WITH 12" WIDENING. SEE SHEET 2A-22 FOR DETAILS.
  - INSTALL IN NOT OVER PROPOSED CLASS 84" WATER MAIN WITH 12" WIDENING. SEE SHEET 2A-23 FOR DETAILS.
  - INSTALL IN NOT OVER PROPOSED CLASS 90" WATER MAIN WITH 12" WIDENING. SEE SHEET 2A-24 FOR DETAILS.

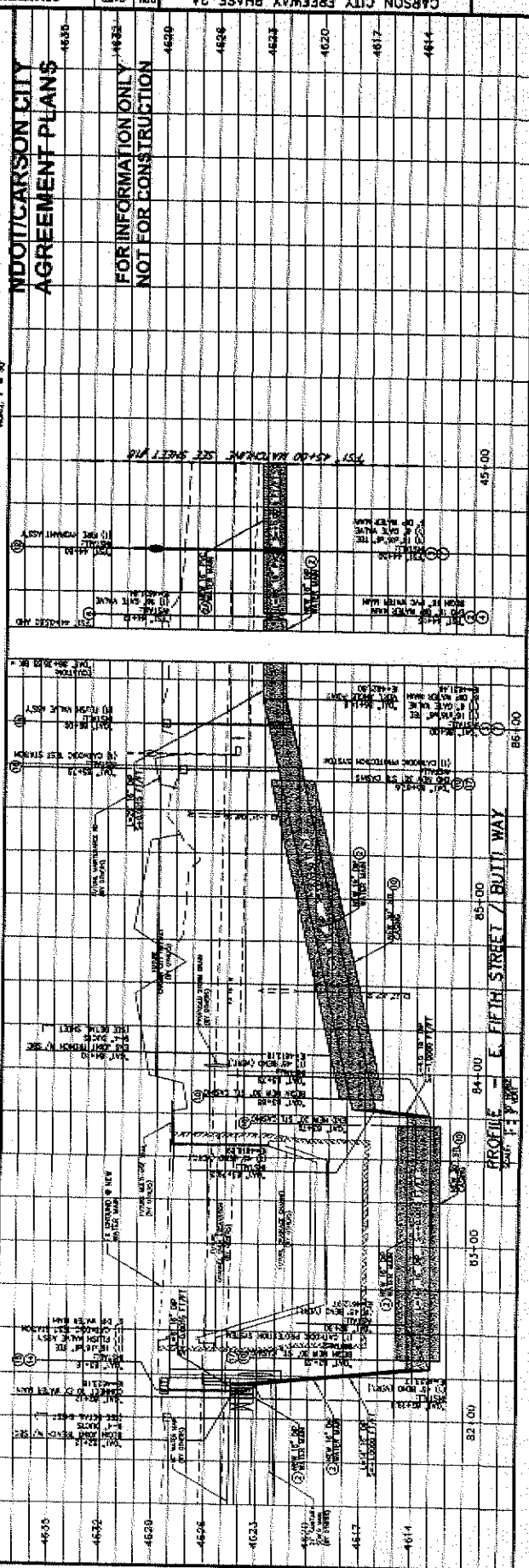
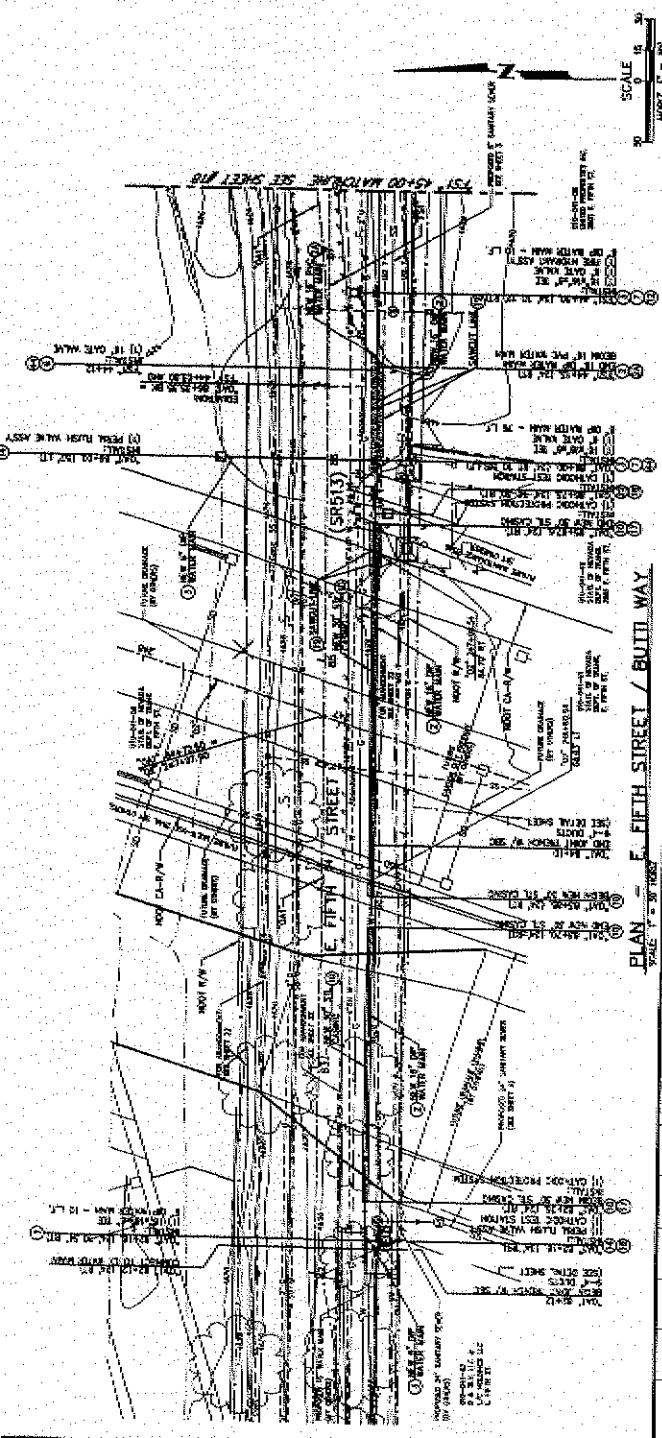

NDOT/CARSON CITY  
 AGREEMENT PLANS

FOR INFORMATION ONLY  
 NOT FOR CONSTRUCTION







REVISIONS: 1. DATE: 11/20/08 2. BY: [ ] 3. DESCRIPTION: [ ]

BY: AFD

**CONSTRUCTION NOTES**

- INSTALL TO MEET THE SPECIFICATION CLASS 150 WATER MARK PER THE DRAWING SCALE.
- INSTALL 1/2" DIA. GATE VALVE PER THE DRAWING SCALE.
- INSTALL 1/2" DIA. GATE VALVE PER THE DRAWING SCALE.
- INSTALL UTILITY OCCUPANCY MARKER PER DETAIL SHEET 21.

**CARSON CITY FREEMWAY PHASE 2A UTILITY RELOCATIONS**

E. FIFTH ST. PROJECT NO. 00-8010  
 18" WATER MAIN  
 STA 50+00 TO STA. 55+00

**NDOT/CARSON CITY AGREEMENT PLANS**

**FOR INFORMATION ONLY NOT FOR CONSTRUCTION**

PLAN E. FIFTH STREET / BUITI WAY  
 SCALE: 1" = 30' HORIZ.

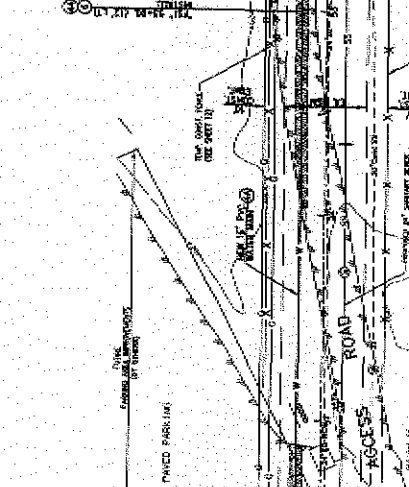

SCALE: 1" = 30' HORIZ.

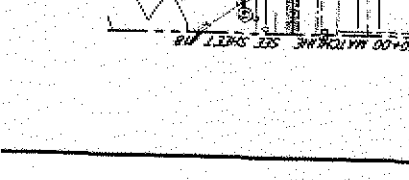

PROFILE E. FIFTH STREET / BUITI WAY  
 SCALE: 1" = 30' VERT.

KEY	DATE	DESCRIPTION
4638		
4628		
4626		
4623		
4620		
4617		
4614		
4611		

**PRELIMINARY**  
08/20/06

THE LOUIS BERGER GROUP INC.  
PUBLIC WORKS DEPARTMENT  
CARSON CITY  
2000 SOUTH STATE HIGHWAY EAST, SUITE 100, CARSON CITY, NEVADA 89801  
PHONE 702-255-9288  
FAX 702-255-9118

- CONSTRUCTION NOTES**
1. INSTALL 18 INCH DIAMETER (CLASS 200) WATER MAIN WITH RESTRICTED JOINTS AND 30' SPACING @ 30'
  2. INSTALL 18 INCH P.C. (CLASS 160) WATER MAIN WITH 30' SPACING @ 30'
  3. INSTALL 18 INCH P.C. (CLASS 160) WATER MAIN WITH 30' SPACING @ 30'
  4. INSTALL 18 INCH P.C. (CLASS 160) WATER MAIN WITH 30' SPACING @ 30'
  5. INSTALL 18 INCH P.C. (CLASS 160) WATER MAIN WITH 30' SPACING @ 30'
  6. INSTALL 18 INCH P.C. (CLASS 160) WATER MAIN WITH 30' SPACING @ 30'
  7. INSTALL 18 INCH P.C. (CLASS 160) WATER MAIN WITH 30' SPACING @ 30'
  8. INSTALL 18 INCH P.C. (CLASS 160) WATER MAIN WITH 30' SPACING @ 30'
  9. INSTALL 18 INCH P.C. (CLASS 160) WATER MAIN WITH 30' SPACING @ 30'
  10. INSTALL 18 INCH P.C. (CLASS 160) WATER MAIN WITH 30' SPACING @ 30'
  11. INSTALL 18 INCH P.C. (CLASS 160) WATER MAIN WITH 30' SPACING @ 30'
  12. INSTALL 18 INCH P.C. (CLASS 160) WATER MAIN WITH 30' SPACING @ 30'
  13. INSTALL 18 INCH P.C. (CLASS 160) WATER MAIN WITH 30' SPACING @ 30'
  14. INSTALL 18 INCH P.C. (CLASS 160) WATER MAIN WITH 30' SPACING @ 30'
  15. INSTALL 18 INCH P.C. (CLASS 160) WATER MAIN WITH 30' SPACING @ 30'
  16. INSTALL 18 INCH P.C. (CLASS 160) WATER MAIN WITH 30' SPACING @ 30'
  17. INSTALL 18 INCH P.C. (CLASS 160) WATER MAIN WITH 30' SPACING @ 30'
  18. INSTALL 18 INCH P.C. (CLASS 160) WATER MAIN WITH 30' SPACING @ 30'
  19. INSTALL 18 INCH P.C. (CLASS 160) WATER MAIN WITH 30' SPACING @ 30'
  20. INSTALL 18 INCH P.C. (CLASS 160) WATER MAIN WITH 30' SPACING @ 30'
  21. INSTALL 18 INCH P.C. (CLASS 160) WATER MAIN WITH 30' SPACING @ 30'
  22. INSTALL 18 INCH P.C. (CLASS 160) WATER MAIN WITH 30' SPACING @ 30'
  23. INSTALL 18 INCH P.C. (CLASS 160) WATER MAIN WITH 30' SPACING @ 30'
  24. INSTALL 18 INCH P.C. (CLASS 160) WATER MAIN WITH 30' SPACING @ 30'
  25. INSTALL 18 INCH P.C. (CLASS 160) WATER MAIN WITH 30' SPACING @ 30'
  26. INSTALL 18 INCH P.C. (CLASS 160) WATER MAIN WITH 30' SPACING @ 30'
  27. INSTALL 18 INCH P.C. (CLASS 160) WATER MAIN WITH 30' SPACING @ 30'
  28. INSTALL 18 INCH P.C. (CLASS 160) WATER MAIN WITH 30' SPACING @ 30'
  29. INSTALL 18 INCH P.C. (CLASS 160) WATER MAIN WITH 30' SPACING @ 30'
  30. INSTALL 18 INCH P.C. (CLASS 160) WATER MAIN WITH 30' SPACING @ 30'

**NDOT/CARSON CITY AGREEMENT PLANS**

**FOR INFORMATION ONLY NOT FOR CONSTRUCTION**

**PLAN - E FIFTH STREET / BUTT WAY**

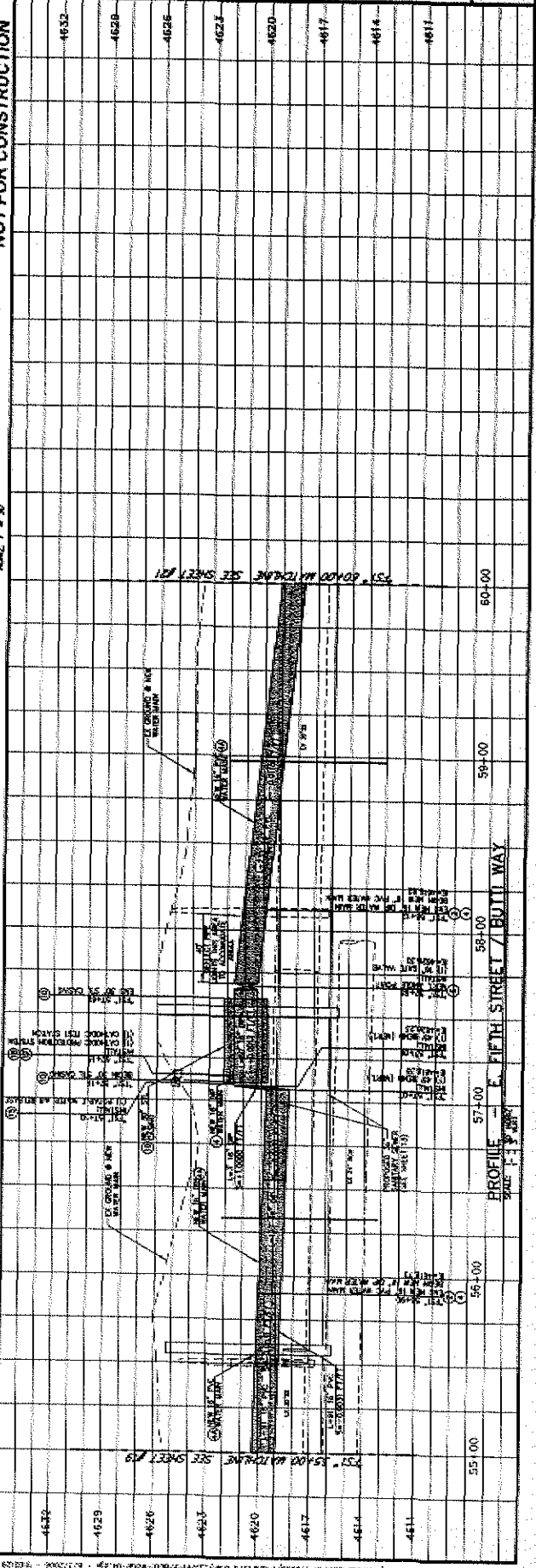

**PROFILE - E FIFTH STREET / BUTT WAY**

CARSON CITY FREEMAN PHASE 2A  
UTILITY RELOCATIONS  
PROJECT NO. 09-0010  
16" WATER MAIN  
151' 55+00 TO 151' 80+00

PRELIMINARY  
 09/20/05

REV.	DATE	DESCRIPTION
01	APP'D	

CARSON CITY FREeway PHASE 2A  
 UTILITY RELOCATIONS  
 E. 5TH ST. PROJECT EXIST. UNDER BRIDGE ON MAIN WAY

SHEET  
 21E  
 OF  
 34

- CONSTRUCTION NOTES**
- INSTALL 16" WATER MAIN IN TRENCH CLASS 200. WATER MAIN WITH 12" MIN. COVER. SEE SHEET 20 FOR DETAILS.
  - INSTALL 16" WATER MAIN IN TRENCH CLASS 140. WATER MAIN WITH 12" MIN. COVER. SEE SHEET 20 FOR DETAILS.
  - INSTALL 16" WATER MAIN IN TRENCH CLASS 100. WATER MAIN WITH 12" MIN. COVER. SEE SHEET 20 FOR DETAILS.
  - INSTALL 16" WATER MAIN IN TRENCH CLASS 60. WATER MAIN WITH 12" MIN. COVER. SEE SHEET 20 FOR DETAILS.
  - INSTALL 16" WATER MAIN IN TRENCH CLASS 30. WATER MAIN WITH 12" MIN. COVER. SEE SHEET 20 FOR DETAILS.
  - INSTALL 16" WATER MAIN IN TRENCH CLASS 15. WATER MAIN WITH 12" MIN. COVER. SEE SHEET 20 FOR DETAILS.
  - INSTALL 16" WATER MAIN IN TRENCH CLASS 5. WATER MAIN WITH 12" MIN. COVER. SEE SHEET 20 FOR DETAILS.
  - INSTALL 16" WATER MAIN IN TRENCH CLASS 0. WATER MAIN WITH 12" MIN. COVER. SEE SHEET 20 FOR DETAILS.
  - INSTALL 16" WATER MAIN IN TRENCH CLASS 0. WATER MAIN WITH 12" MIN. COVER. SEE SHEET 20 FOR DETAILS.
  - INSTALL 16" WATER MAIN IN TRENCH CLASS 0. WATER MAIN WITH 12" MIN. COVER. SEE SHEET 20 FOR DETAILS.
  - INSTALL 16" WATER MAIN IN TRENCH CLASS 0. WATER MAIN WITH 12" MIN. COVER. SEE SHEET 20 FOR DETAILS.
  - INSTALL 16" WATER MAIN IN TRENCH CLASS 0. WATER MAIN WITH 12" MIN. COVER. SEE SHEET 20 FOR DETAILS.
  - INSTALL 16" WATER MAIN IN TRENCH CLASS 0. WATER MAIN WITH 12" MIN. COVER. SEE SHEET 20 FOR DETAILS.
  - INSTALL 16" WATER MAIN IN TRENCH CLASS 0. WATER MAIN WITH 12" MIN. COVER. SEE SHEET 20 FOR DETAILS.
  - INSTALL 16" WATER MAIN IN TRENCH CLASS 0. WATER MAIN WITH 12" MIN. COVER. SEE SHEET 20 FOR DETAILS.

**NDOT/CARSON CITY  
 AGREEMENT PLANS**

FOR INFORMATION ONLY  
 NOT FOR CONSTRUCTION

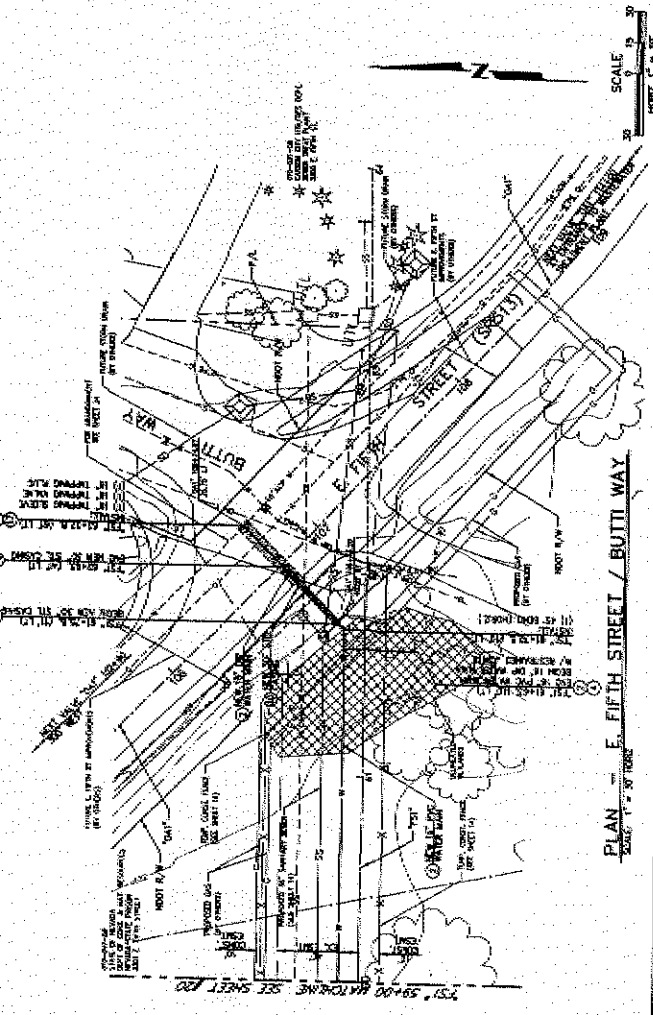

PLAN - E FIFTH STREET / BUTTI WAY  
 SCALE: 1" = 20'

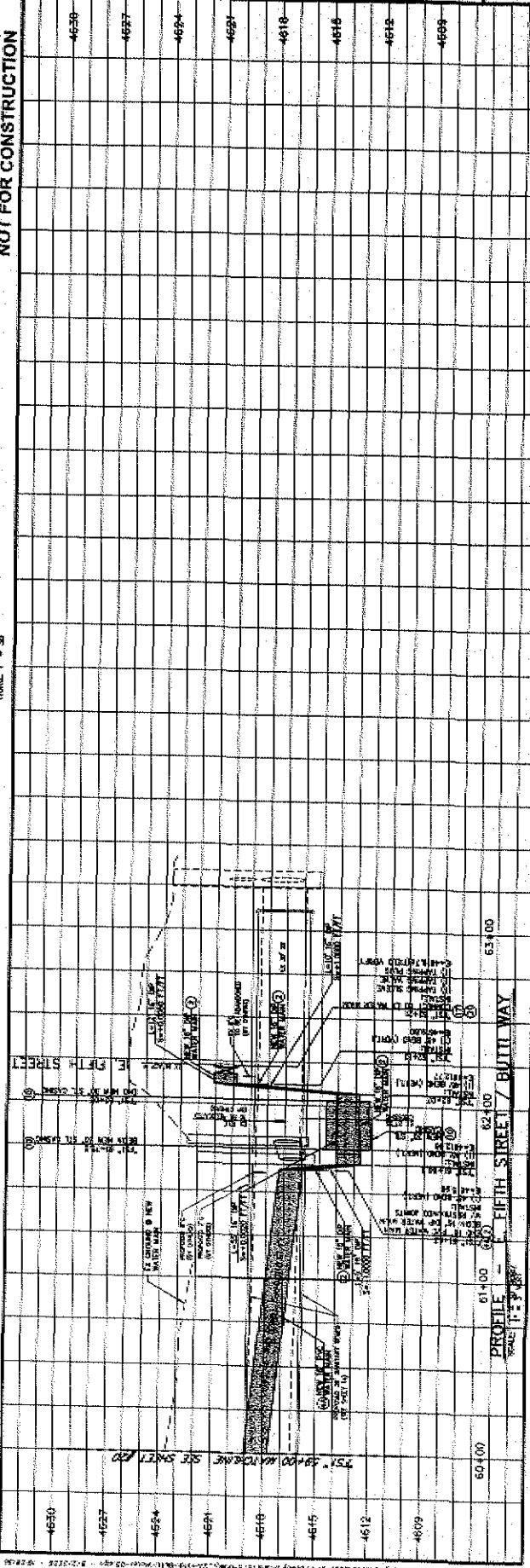

PROFILE - E FIFTH STREET / BUTTI WAY  
 SCALE: 1" = 3'

REV.	DATE	DESCRIPTION

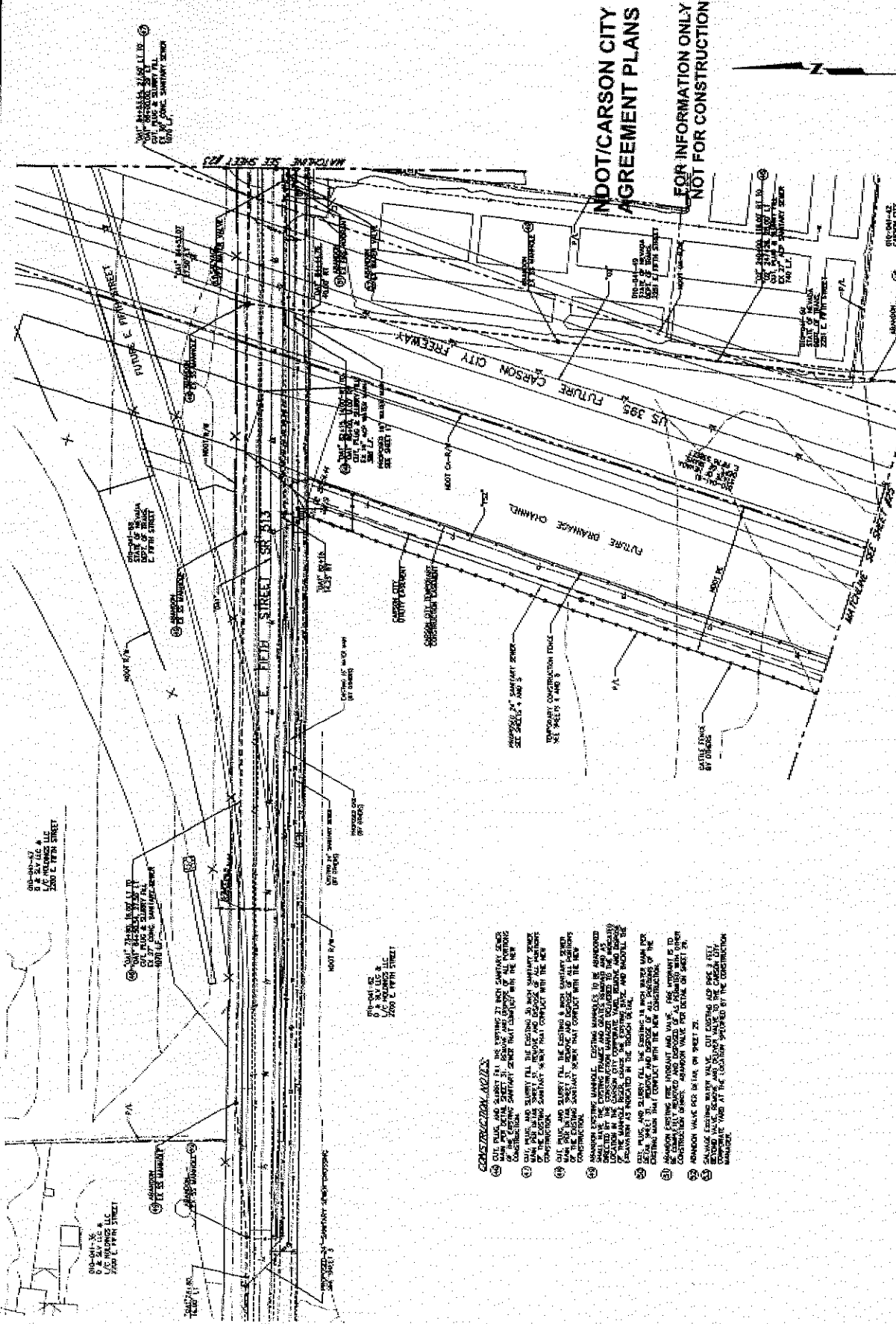

**NOT/CARSON CITY  
 AGREEMENT PLANS**  
 FOR INFORMATION ONLY  
 NOT FOR CONSTRUCTION

- CONSTRUCTION NOTES:**
1. ALL UTILITIES TO BE REMOVED OR ABANDONED SHALL BE IDENTIFIED BY THE CONTRACTOR AND SHALL BE IDENTIFIED BY THE CONTRACTOR AND SHALL BE IDENTIFIED BY THE CONTRACTOR.
  2. ALL UTILITIES TO BE REMOVED OR ABANDONED SHALL BE IDENTIFIED BY THE CONTRACTOR AND SHALL BE IDENTIFIED BY THE CONTRACTOR.
  3. ALL UTILITIES TO BE REMOVED OR ABANDONED SHALL BE IDENTIFIED BY THE CONTRACTOR AND SHALL BE IDENTIFIED BY THE CONTRACTOR.
  4. ALL UTILITIES TO BE REMOVED OR ABANDONED SHALL BE IDENTIFIED BY THE CONTRACTOR AND SHALL BE IDENTIFIED BY THE CONTRACTOR.
  5. ALL UTILITIES TO BE REMOVED OR ABANDONED SHALL BE IDENTIFIED BY THE CONTRACTOR AND SHALL BE IDENTIFIED BY THE CONTRACTOR.
  6. ALL UTILITIES TO BE REMOVED OR ABANDONED SHALL BE IDENTIFIED BY THE CONTRACTOR AND SHALL BE IDENTIFIED BY THE CONTRACTOR.
  7. ALL UTILITIES TO BE REMOVED OR ABANDONED SHALL BE IDENTIFIED BY THE CONTRACTOR AND SHALL BE IDENTIFIED BY THE CONTRACTOR.
  8. ALL UTILITIES TO BE REMOVED OR ABANDONED SHALL BE IDENTIFIED BY THE CONTRACTOR AND SHALL BE IDENTIFIED BY THE CONTRACTOR.
  9. ALL UTILITIES TO BE REMOVED OR ABANDONED SHALL BE IDENTIFIED BY THE CONTRACTOR AND SHALL BE IDENTIFIED BY THE CONTRACTOR.
  10. ALL UTILITIES TO BE REMOVED OR ABANDONED SHALL BE IDENTIFIED BY THE CONTRACTOR AND SHALL BE IDENTIFIED BY THE CONTRACTOR.



PRELIMINARY  
 09/20/06

REV.	DATE	DESCRIPTION	BY	APP'D.

DATE 2/4E  
 OF 34

- CONSTRUCTION NOTES**
- SEE PLAN AND SHEET FOR ALL UTILITY LOCATIONS AND DEPT. FOR REMOVAL AND RELOCATION OF ALL UTILITIES. VERIFY DEPT. AND LOCATION OF ALL UTILITIES BEFORE CONSTRUCTION.
  - REMOVE EXISTING UTILITY. EXISTING UTILITIES TO BE REMOVED SHALL BE THE SOUTHWEST AND EAST OF THE MAINWAY AND AS SHOWN ON THE EXISTING PLAN. ALL UTILITIES TO BE REMOVED SHALL BE REMOVED AT THE END OF THE MAINWAY AND SHALL BE MARKED BY THE CONTRACTOR.
  - SEE PLAN AND SHEET FOR ALL UTILITY LOCATIONS AND DEPT. FOR REMOVAL AND RELOCATION OF ALL UTILITIES. VERIFY DEPT. AND LOCATION OF ALL UTILITIES BEFORE CONSTRUCTION.
  - REMOVE EXISTING UTILITY. EXISTING UTILITIES TO BE REMOVED SHALL BE THE SOUTHWEST AND EAST OF THE MAINWAY AND AS SHOWN ON THE EXISTING PLAN. ALL UTILITIES TO BE REMOVED SHALL BE REMOVED AT THE END OF THE MAINWAY AND SHALL BE MARKED BY THE CONTRACTOR.
  - REMOVE EXISTING UTILITY. EXISTING UTILITIES TO BE REMOVED SHALL BE THE SOUTHWEST AND EAST OF THE MAINWAY AND AS SHOWN ON THE EXISTING PLAN. ALL UTILITIES TO BE REMOVED SHALL BE REMOVED AT THE END OF THE MAINWAY AND SHALL BE MARKED BY THE CONTRACTOR.

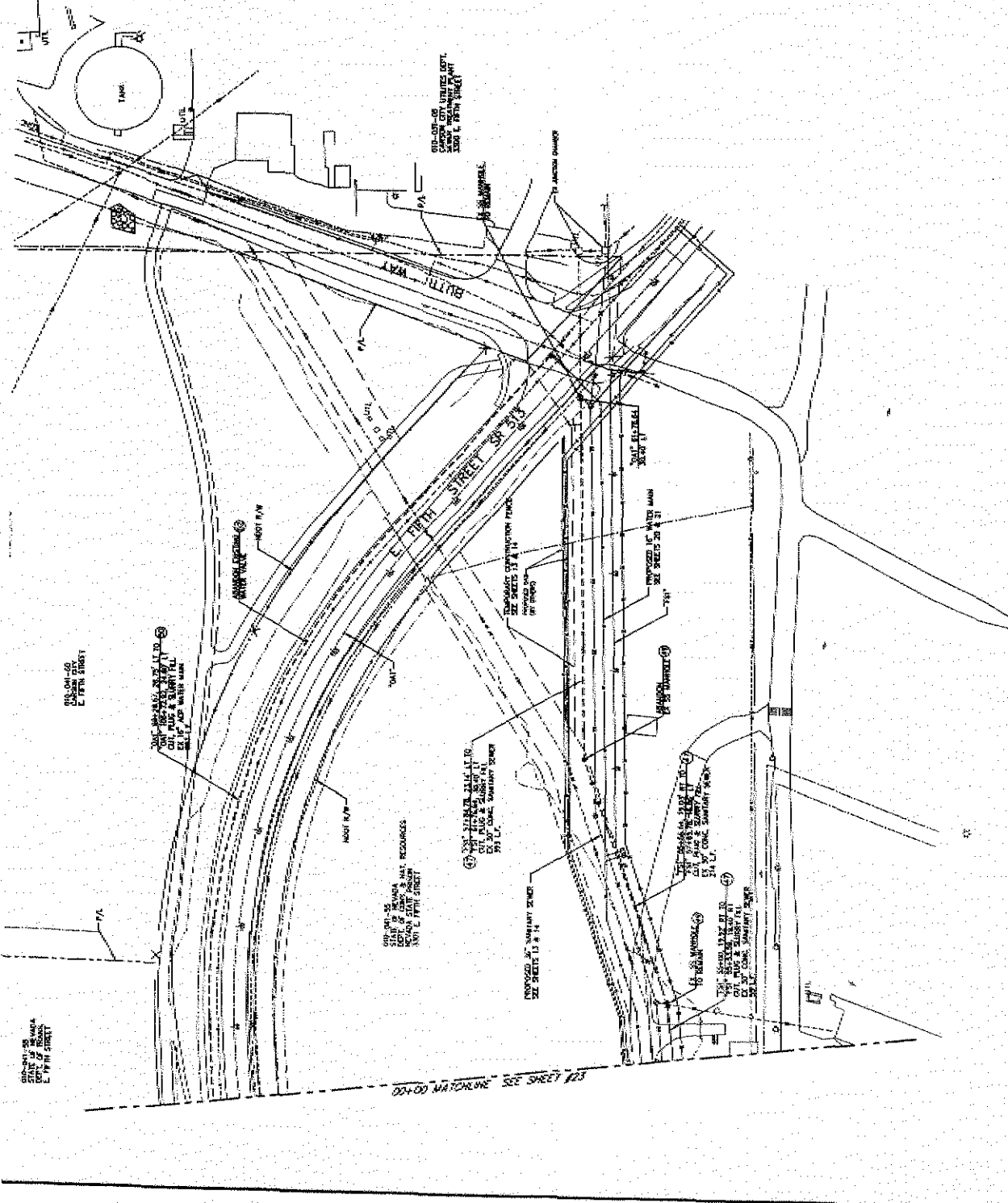

**NDOT/CARSON CITY  
 AGREEMENT PLANS**  
 FOR INFORMATION ONLY  
 NOT FOR CONSTRUCTION





