

**E. WASHINGTON ST. STRIPING PLAN**  
 SCALE: 1" = 30'  
 REFERENCE SHEETS C1 TO C6 FOR WATERLINE IMPROVEMENTS

- CONSTRUCTION NOTES:**
- 60 PAINT 24" WIDE SOLID WHITE CROSSWALK STRIPING PER STD DWG C-5.4.3
  - 61 PAINT 24" WIDE SOLID WHITE STOP BAR PER STD DWG C-5.4.3
  - 62 PAINT 8" WIDE SOLID WHITE LANE STRIPE
  - 63 PAINT 4" WIDE SOLID DOUBLE YELLOW CENTERLINE STRIPE
  - 64 PAINT 4" WIDE SOLID YELLOW CENTERLINE STRIPE
  - 65 PAINT 4" WIDE SOLID WHITE PARKING STALL STRIPE
  - 66 PAINT HANDICAP PARKING LEGEND (WHITE ON BLUE FIELD)
  - 67 PAINT 4" SOLID WHITE BOUNDARY LINE WITH 4" SOLID WHITE CROSS HATCH INFILL (45° ANGLE AT 3' ON CENTER)
  - 68 PAINT 4" SOLID WHITE LINE
  - 69 PAINT SOLID WHITE DIRECTIONAL ARROW LEGEND AS SHOWN
  - 70 PAINT SOLID WHITE PAVEMENT LEGEND AS SHOWN
  - 71 PAINT SPEED BUMP SOLID HIGH VISIBILITY YELLOW
  - 72 PAINT CURB RED (NO PARKING ZONE)
  - 73 INSTALL CONCRETE WHEEL STOP PER STD DWG C-5.5.2

DESIGNED BY: DGR  
 DRAWN BY: DGR  
 CHECKED BY: TEG  
 DWG NO.: 4-000 per set mtd at setting  
 SCALE (HORIZ): 1"=30'  
 SCALE (VERT): N/A  
 DATE: 3/31/2014

**CARSON CITY  
 PUBLIC WORKS DEPARTMENT**  
 3505 BUTTI WAY CARSON CITY, NEVADA 89701  
 PH: 887-2355 FAX: 887-2112

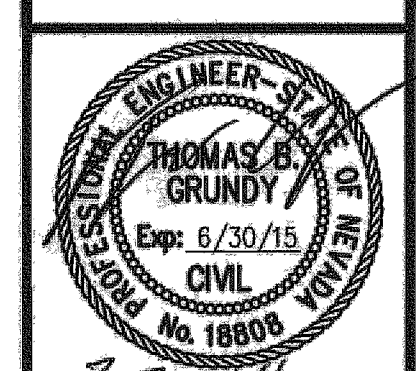

3-31-14

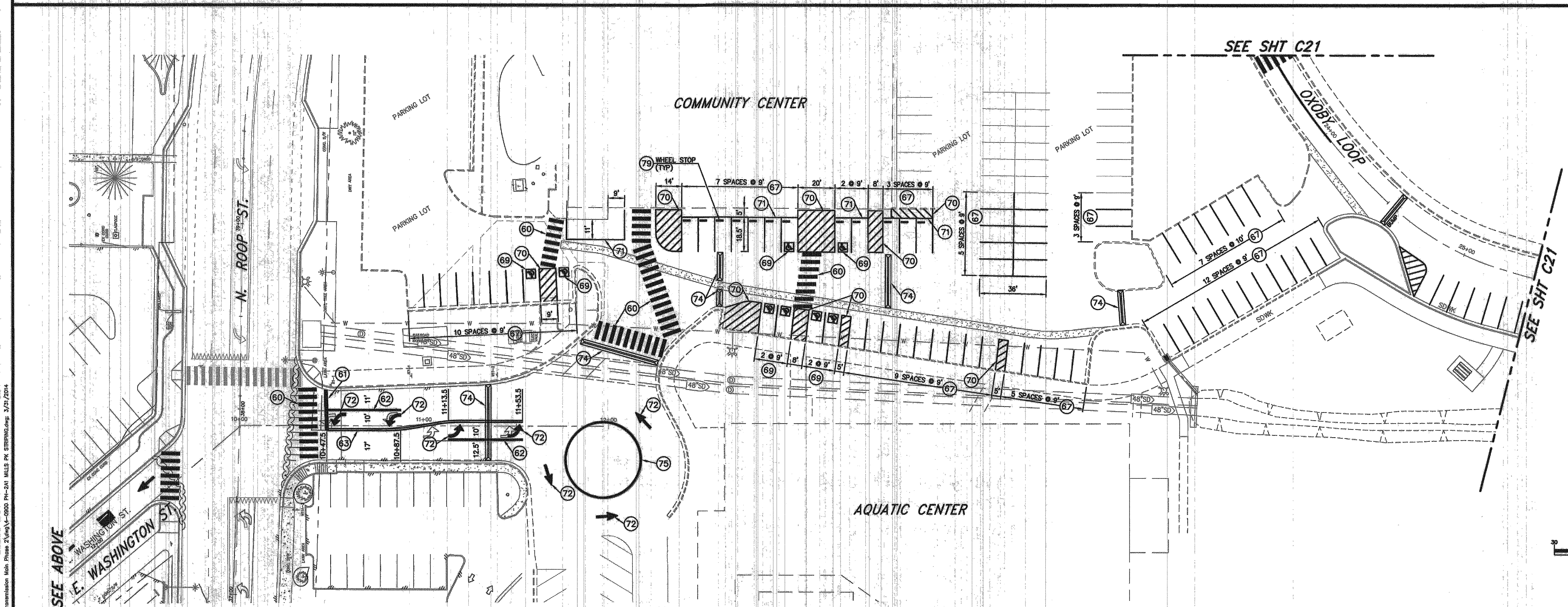

**COMMUNITY CENTER STRIPING PLAN**  
 SCALE: 1" = 30'  
 REFERENCE SHEETS C1 TO C6 FOR WATERLINE IMPROVEMENTS  
 REFERENCE SHEETS C7 TO C11 FOR PARKING LOT IMPROVEMENTS

SEE SHT C21

SEE SHT C21

SEE ABOVE

SCALE  
 HORIZ: 1" = 30'

Call before you Dig  
 Avoid cutting underground utility lines. It's costly.

**Call 811**  
 OR  
 1-800-227-2600

REV.	DATE	DESCRIPTION	BY	APP'D

**EAST/WEST WATER TRANSMISSION MAIN  
 PROJECT - PHASE 2A-1  
 PROJECT No. 4.0900  
 E. WASHINGTON ST. / COMMUNITY CENTER  
 SIGNING & STRIPING PLAN**

SHEET  
**C20**  
 OF  
**31**

H:\PROJECTS\4000 E-W Transmission Main Phase 2A-1\4-0900 Plan-201 Mills PK Striping.dwg 3/31/2014

FOR BIDDING PURPOSE ONLY

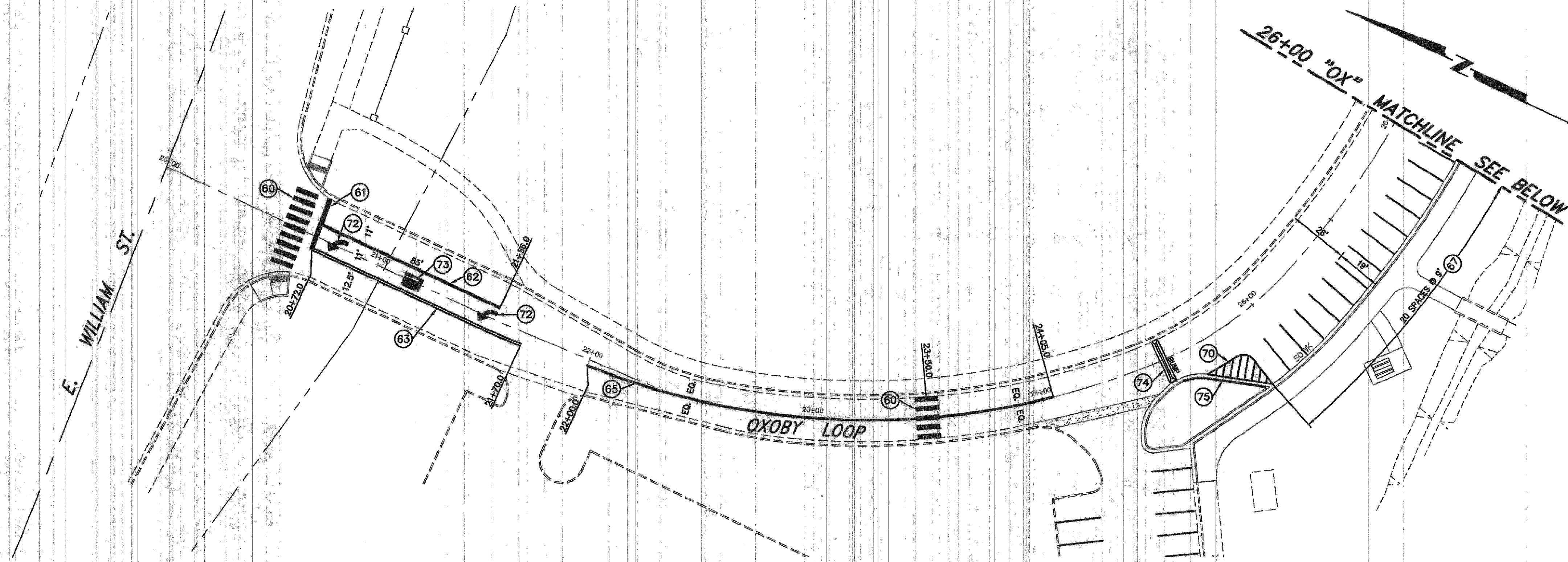

**OXOBY LOOP STRIPING PLAN**

SCALE: 1" = 30'  
 REFERENCE SHEETS C1 TO C6 FOR WATERLINE IMPROVEMENTS  
 REFERENCE SHEETS C7 TO C11 FOR PARKING LOT IMPROVEMENTS

SEE SHT C20

**CONSTRUCTION NOTES:**

- 60 PAINT 24" WIDE SOLID WHITE CROSSWALK STRIPING PER STD DWG C-5.4.3
- 61 PAINT 24" WIDE SOLID WHITE STOP BAR PER STD DWG C-5.4.3
- 62 PAINT 8" WIDE SOLID WHITE LANE STRIPE
- 63 PAINT 4" WIDE SOLID DOUBLE YELLOW CENTERLINE STRIPE
- 64 PAINT 4" WIDE SOLID YELLOW CENTERLINE STRIPE
- 65 PAINT 4" WIDE SOLID WHITE PARKING STALL STRIPE
- 66 PAINT 4" SOLID WHITE PARALLEL PARKING "T" PER DETAIL 1, SHEET C23.
- 69 PAINT HANDICAP PARKING LEGEND (WHITE ON BLUE FIELD)
- 70 PAINT 4" SOLID WHITE BOUNDARY LINE WITH 4" SOLID WHITE CROSS HATCH INFILL (45° ANGLE AT 3" ON CENTER)
- 72 PAINT SOLID WHITE DIRECTIONAL ARROW LEGEND AS SHOWN
- 73 PAINT SOLID WHITE PAVEMENT LEGEND AS SHOWN
- 74 PAINT SPEED BUMP SOLID HIGH VISIBILITY YELLOW
- 75 PAINT CURB RED (NO PARKING ZONE)
- 76 INSTALL SIGN & POST PER STD DRAWING C-5.4.2
- 77 REMOVE EXISTING SIGN & POST, GRIND FLUSH WITH CONCRETE, FILL ANNULAR SPACE WITH NON SHRINK GROUT.
- 78 PAINT 8" SOLID WHITE BOUNDARY LINE WITH 8" SOLID WHITE CHEVRON HATCH INFILL AT 6" ON CENTER

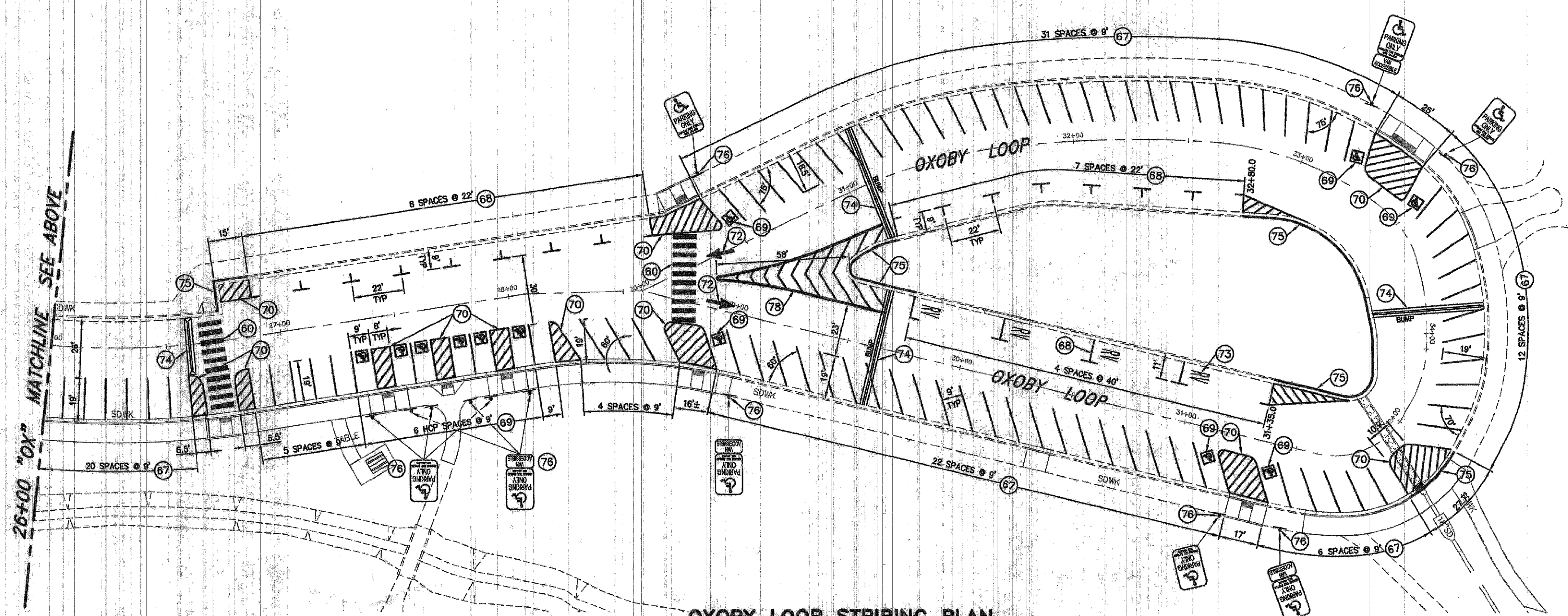

**OXOBY LOOP STRIPING PLAN**

SCALE: 1" = 30'  
 REFERENCE SHEETS C1 TO C6 FOR WATERLINE IMPROVEMENTS  
 REFERENCE SHEETS C7 TO C11 FOR PARKING LOT IMPROVEMENTS

SCALE  
 HORZ: 1" = 30'

Call before you Dig  
 Avoid cutting underground utility lines. It's costly.

**Call 811**  
 OR  
 1-800-227-2600

DESIGNED BY: DGR	<b>CARSON CITY          PUBLIC WORKS DEPARTMENT</b>  3505 BUTTI WAY CARSON CITY, NEVADA 89701 PH: 887-2355 FAX: 887-2112
DRAWN BY: DGR	
CHECKED BY: TBC	
DWG NO.: 4-0900-2A-01	
SCALE (HORIZ): 1" = 30'	
SCALE (VERT): N/A	DATE: 3/31/2014
BY: APP'D	
REV.	
DATE	
DESCRIPTION	
<b>EAST/WEST WATER TRANSMISSION MAIN          PROJECT - PHASE 2A-1          PROJECT No. 4-0900          OXOBY LOOP          SIGNING &amp; STRIPING PLAN</b>	
SHEET <b>C21</b> OF <b>31</b>	

FOR BIDDING PURPOSE ONLY

H:\PROJECTS\4-0900 E-W Transmission Main Phase 2\Drawings\4-0900 PH-2A-MLS PK STRIPING.dwg 3/31/2014

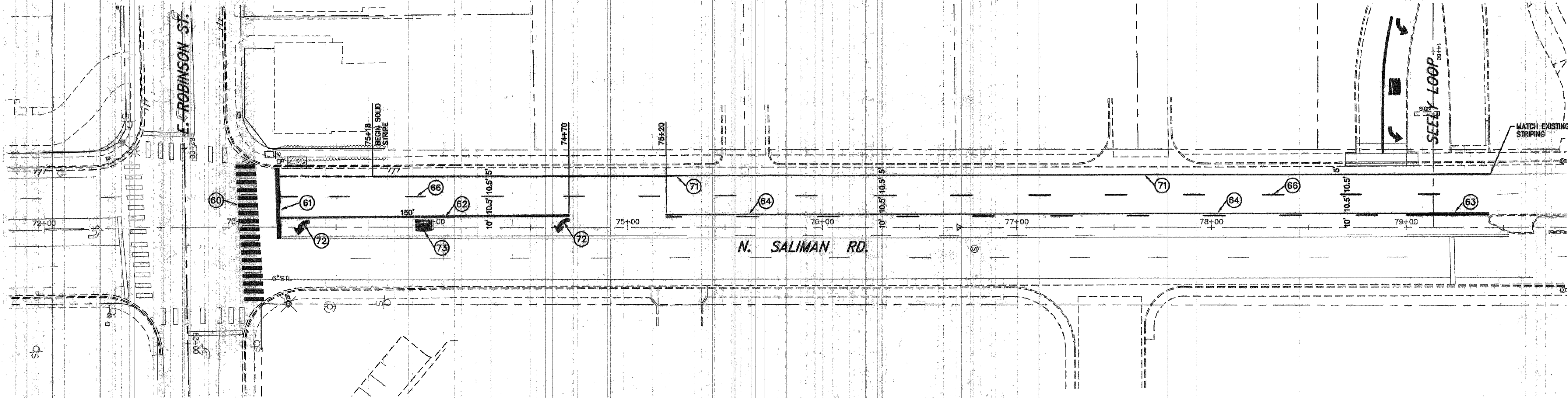

**PLAN - N. SALIMAN RD.**

SCALE: 1" = 30'  
REFERENCE SHEETS C1 TO C6 FOR WATERLINE IMPROVEMENTS

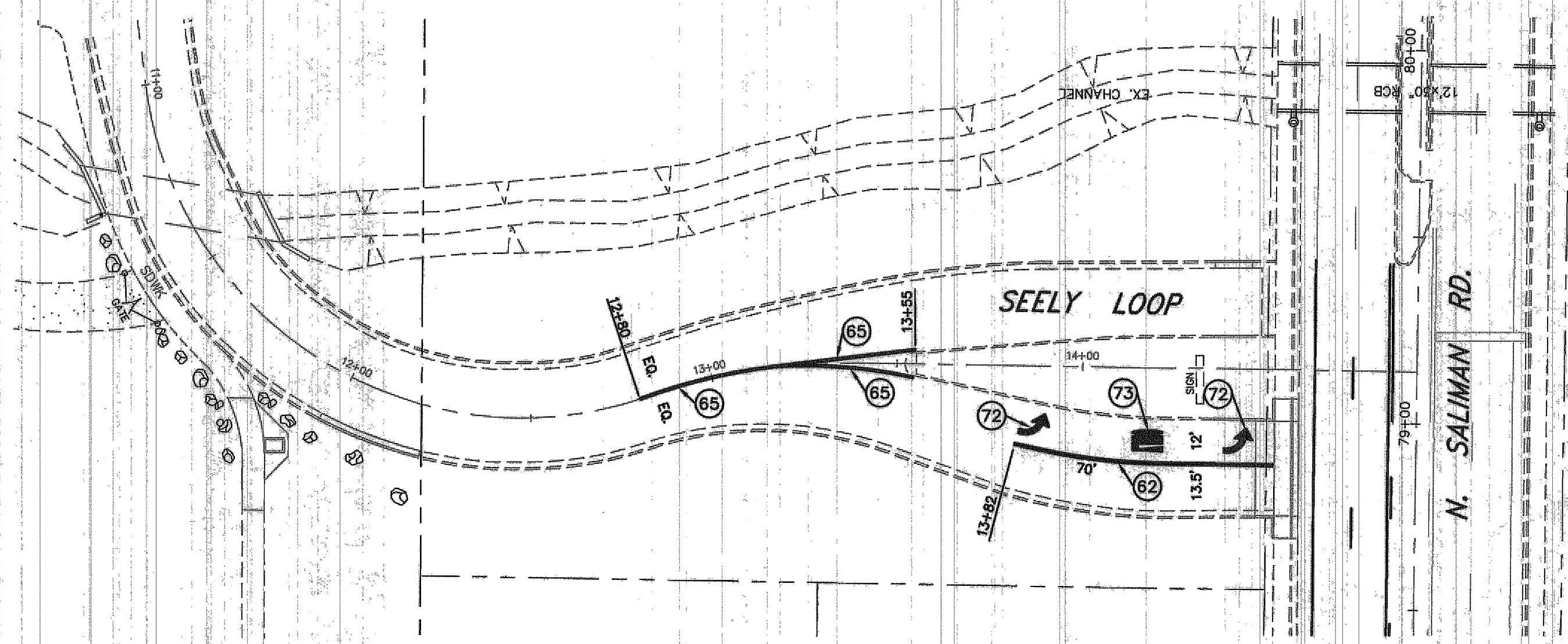

**SEELY LOOP STRIPING PLAN**

SCALE: 1" = 30'  
REFERENCE SHEETS C1 TO C6 FOR WATERLINE IMPROVEMENTS  
REFERENCE SHEETS C7 TO C11 FOR PARKING LOT IMPROVEMENTS

SEE BELOW

**CONSTRUCTION NOTES:**

- 60 PAINT 24" WIDE SOLID WHITE CROSSWALK STRIPING PER STD DWG C-5.4.3
- 61 PAINT 24" WIDE SOLID WHITE STOP BAR PER STD DWG C-5.4.3
- 62 PAINT 8" WIDE SOLID WHITE LANE STRIPE
- 63 PAINT 4" WIDE SOLID DOUBLE YELLOW CENTERLINE STRIPE
- 64 PAINT 4" WIDE SOLID YELLOW WITH 4" WIDE YELLOW SKIP CENTERLINE STRIPE
- 65 PAINT 4" WIDE SOLID YELLOW CENTERLINE STRIPE
- 66 PAINT 4" WIDE SOLID WHITE SKIP STRIPE LANE LINE
- 71 PAINT 4" SOLID WHITE LINE
- 72 PAINT SOLID WHITE DIRECTIONAL ARROW LEGEND AS SHOWN
- 73 PAINT SOLID WHITE PAVEMENT LEGEND AS SHOWN

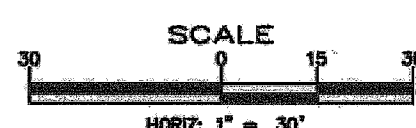

**EAST/WEST WATER TRANSMISSION MAIN  
PROJECT - PHASE 2A-1  
PROJECT No. 4.0900  
SEELY LOOP & N. SALIMAN RD.  
SIGNING & STRIPING PLAN**

SHEET  
**C22**  
OF  
**31**

REV.	DATE	DESCRIPTION	BY	APP'D

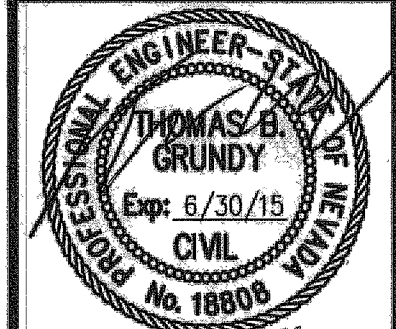

**CARSON CITY  
PUBLIC WORKS DEPARTMENT**

3505 BUTTI WAY CARSON CITY, NEVADA 89701  
PH: 887-2355 FAX: 887-2112

DESIGNED BY: DGR  
DRAWN BY: DGR  
CHECKED BY: TEG  
DWG NO.: 4-0900 PH-2A-MLS PK STRIPING  
SCALE (HORIZ): 1" = 30'  
SCALE (VERT): N/A  
DATE: 3/31/2014

FOR BIDDING PURPOSE ONLY

H:\PROJECTS\40000 E-W Transmission Main Phase 2\DWG\40000 PHASE 2-241 WALKER PK STRIPING.DWG 7/27/2014

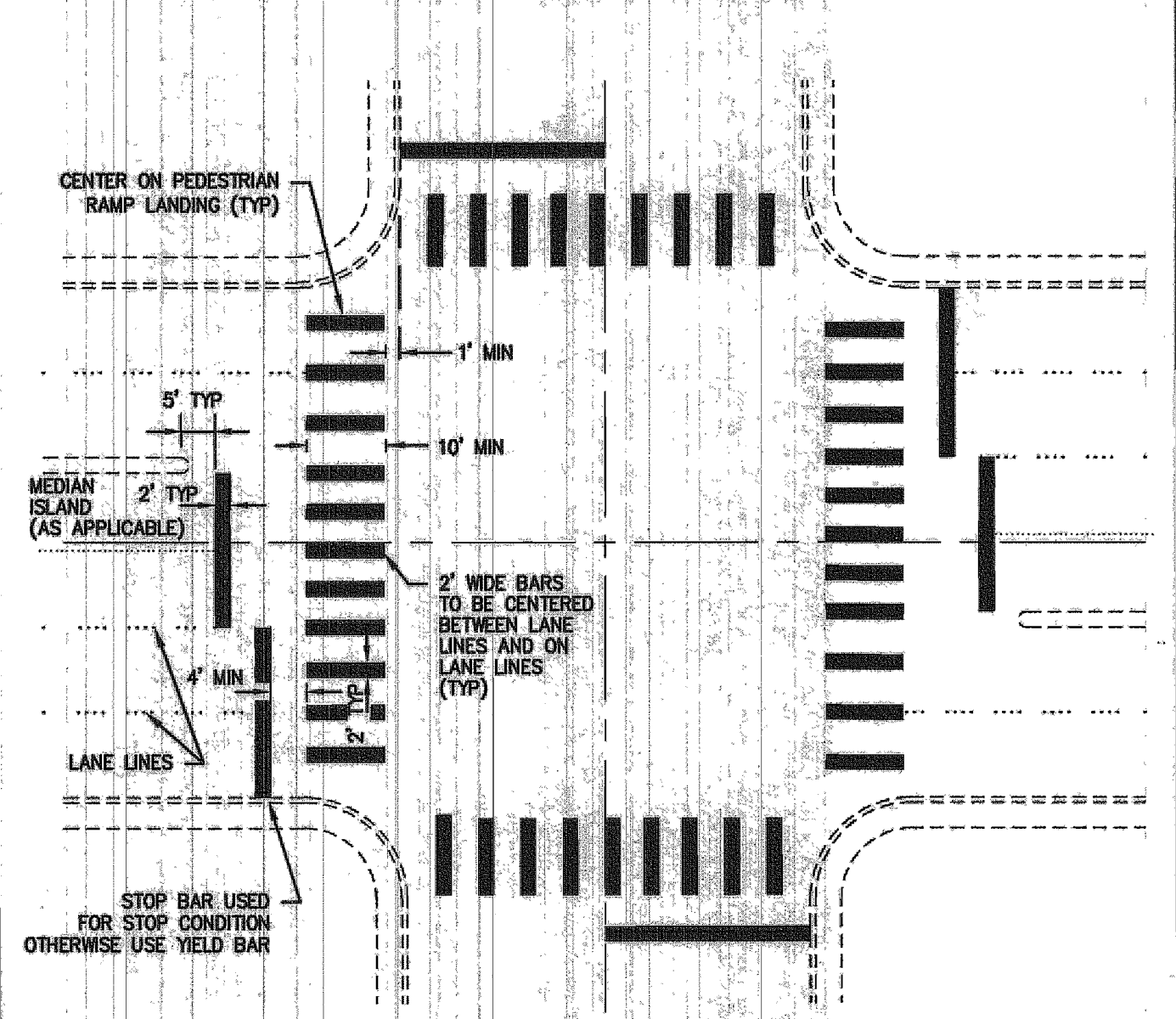

**TYPICAL CROSSWALK STRIPING DETAIL**

**NOTES:**

- ALL STRIPING SHALL CONFORM TO THE MANUAL ON UNIFORM TRAFFIC CONTROL DEVICES (MUTCD) FOR STREETS AND HIGHWAYS, CURRENT EDITION.
- INLAY TAPE STRIPING AND/OR PAVEMENT LEGENDS SHALL BE INSTALLED PER MANUFACTURERS RECOMMENDATIONS.
- CROSSWALK MARKINGS SHALL BE INSTALLED AT ALL TRAFFIC SIGNAL LOCATIONS AND AT OTHER LOCATIONS AS DIRECTED BY THE CARSON CITY ENGINEER OR PUBLIC WORKS DIRECTOR.

NO.	REVISION	DATE	STANDARD DETAIL FOR PUBLIC WORKS CONSTRUCTION	SECTION CARSON CITY DRAWING NO. C-5.4.3
APPROVED BY: <i>[Signature]</i> 7/09				DATE 7/2009

**CROSSWALK LEGEND**

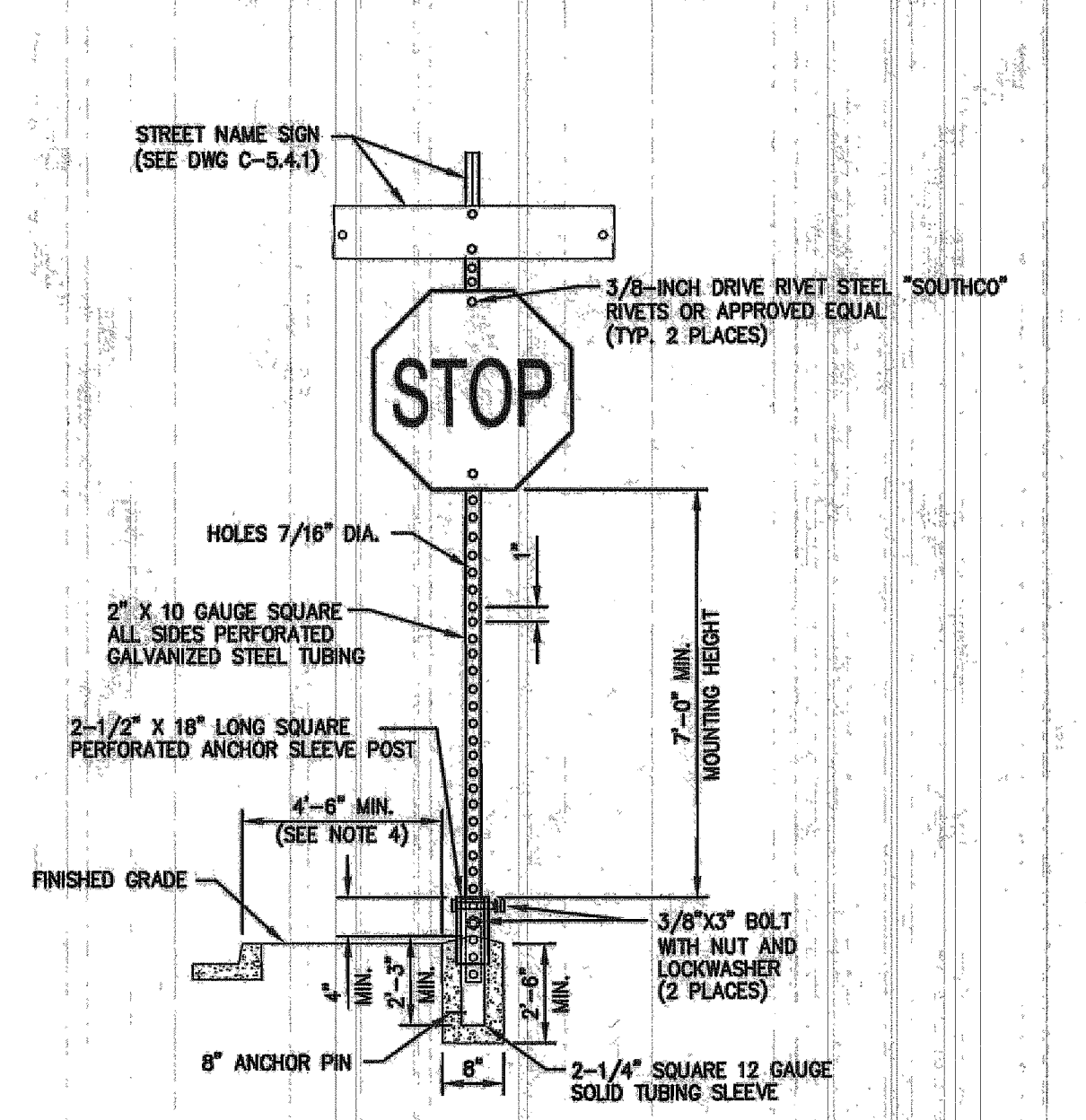

**NOTES:**

- SIGN MATERIALS, CONSTRUCTION AND PLACEMENT SHALL BE IN CONFORMANCE WITH THE LATEST EDITION OF THE MANUAL ON UNIFORM TRAFFIC CONTROL DEVICES.
- STREET NAME SIGN SHALL BE AS SPECIFIED IN STANDARD DETAIL DRAWING NO. C-5.4.1
- ON STREETS WHERE CURBING DOES NOT EXIST, SET SIGN 6 FEET MINIMUM FROM PAVEMENT EDGE.
- CONCRETE BASE SHALL BE LOCATED AT BACK OF SIDEWALK, UNLESS OTHERWISE DIRECTED BY THE CITY ENGINEER.
- ALL REGULATORY SIGNS SHALL USE ASTM TYPE 3 OR 4 INTENSITY SHEETING.

NO.	REVISION	DATE	STANDARD DETAIL FOR PUBLIC WORKS CONSTRUCTION	SECTION CARSON CITY DRAWING NO. C-5.4.2
APPROVED BY: <i>[Signature]</i> 7/09				DATE 7/2009

**TRAFFIC SIGN INSTALLATION**

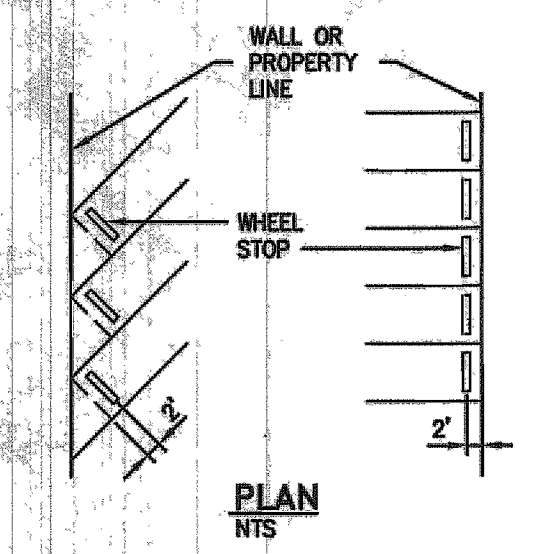

**TYPICAL PAVEMENT SECTION**

- PARKING LOTS WILL BE CONSTRUCTED WITH A MINIMUM OF 2.5 INCHES OF A.C. SURFACE ON 6 INCHES OF TYPE 2 CLASS B AGGREGATE BASE (BOTH COMPACTED TO 95% MIN.)

**WHEEL STOPS**

- WHEEL STOPS WILL BE 2 FEET (MIN.) FROM PROPERTY LINE OR APPURTENANCES.
- WHEEL STOP WILL BE SECURED WITH 0.5 INCH REBAR DRIVEN 12 INCHES (MIN.) INTO SURFACE OR WITH AN APPROVED EPOXY HAVING A SETTING TIME OF 4-HOUR (MAX.) AT 77 DEGREES FAHRENHEIT.
- WHEEL STOPS WILL BE WHITE OR SAFETY YELLOW WITH 0.25 CANDLE POWER REFLECTIVITY.
- WHEEL STOP DIMENSIONS WILL BE 4 INCHES TO 7 INCHES HIGH X 4 FEET (MIN.) LONG X 6 INCHES (MIN.) WIDE. WHEEL STOP LOCATION SHALL SECURE VEHICLE TIRES.
- MINIMUM WALL THICKNESS FOR METAL STOPS WILL BE 0.25 INCHES, FOR POLYETHYLENE OR FIBERGLASS WHEEL STOPS - 0.75 INCHES.
- WOOD WHEEL STOPS WILL BE REDWOOD #2 OR BETTER.
- CONCRETE WHEEL STOPS WILL HAVE A MINIMUM TENSILE STRENGTH OF 2000 P.S.I. (ASTM D-746).
- IMPACT BRITTLE TEMPERATURE SHALL BE -75 DEGREES CELSIUS. (ASTM D-746).
- ELONGATION SHALL BE LIMITED TO 35 PERCENT AT 73 DEGREES FAHRENHEIT (ASTM D638).

**STRIPING**

- PARKING LOT STRIPING SHALL BE WHITE WITH A MINIMUM WIDTH OF 4 INCHES. PAINT SHALL BE SPECIFIED "TRAFFIC STRIPING PAINT" OR HAVE MANUFACTURER'S CERTIFICATION OF SUITABLE APPLICATION ON ASPHALTIC OR CONCRETE SURFACES.

**LIGHTING**

- APPLICATION LEVEL WILL BE 1.0 FOOT CANDLES (MIN.) WITH A UNIFORMITY RATIO (AVERAGE ILLUMINATION) NOT EXCEEDING 6:1 AND AS APPROVED BY THE PUBLIC WORKS DEPARTMENT DEPENDING ON PEDESTRIAN VOLUMES.
- LIGHT FIXTURES SHALL BE FULL CUT-OFF FIXTURES AS DEFINED BY THE ILLUMINATING ENGINEERING SOCIETY OF NORTH AMERICA (IESNA) UNLESS OTHERWISE APPROVED BY THE CARSON CITY ENGINEER OR PUBLIC WORKS DIRECTOR.
- LIGHT POLES SHALL BE LOCATED TO ELIMINATE INTERFERENCE WITH VEHICULAR OR PEDESTRIAN TRAFFIC (AT THE END OF PARKING ROWS WHEN PRACTICAL) AND AS APPROVED BY THE PUBLIC WORKS DEPARTMENT. POLES SHALL NOT BE LOCATED NEXT TO TREES.
- MOUNTING POLES WILL COMPLY WITH THE SAME SPECIFICATIONS PRESCRIBED FOR URBAN COLLECTOR STREET USE.

NO.	REVISION	DATE	STANDARD DETAIL FOR PUBLIC WORKS CONSTRUCTION	SECTION CARSON CITY DRAWING NO. C-5.5.2
APPROVED BY: <i>[Signature]</i> 7/09				DATE 7/2009

**PARKING LOT REQUIREMENTS**

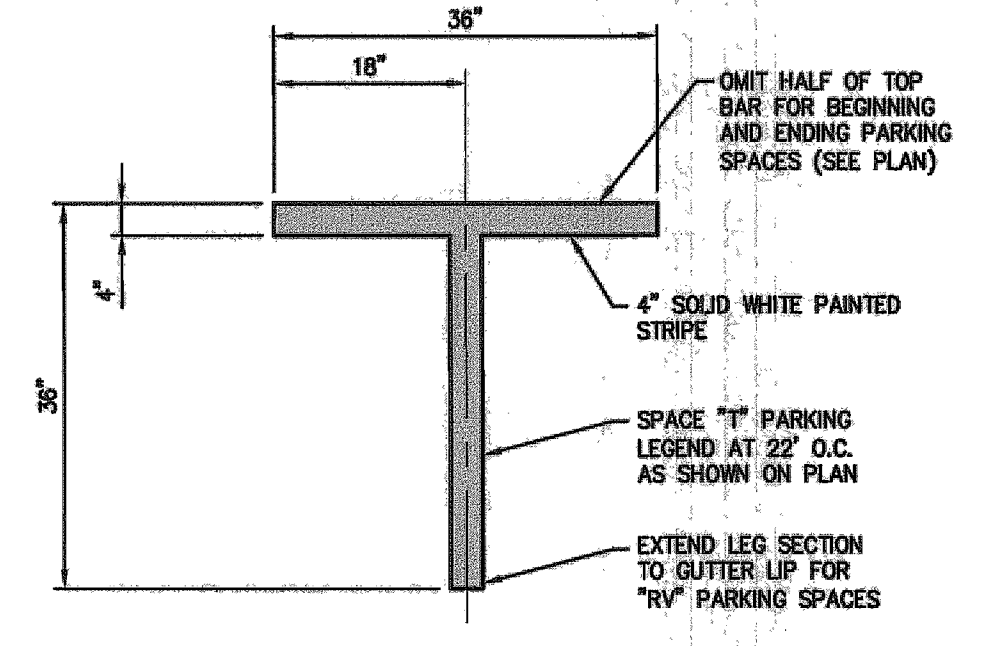

**PARALLEL PARKING STRIPE**

DESIGNED BY: DGR  
 DRAWN BY: DGR  
 CHECKED BY: TBG  
 DWG NO.: 4-0000 PH-241 WALKER PK STRIPING  
 SCALE (HORIZ): N/A  
 SCALE (VERT): N/A  
 DATE: 3/31/2014

**CARSON CITY PUBLIC WORKS DEPARTMENT**  
 3505 BUTTI WAY CARSON CITY, NEVADA 89701  
 PH: 887-2355 FAX: 887-2112

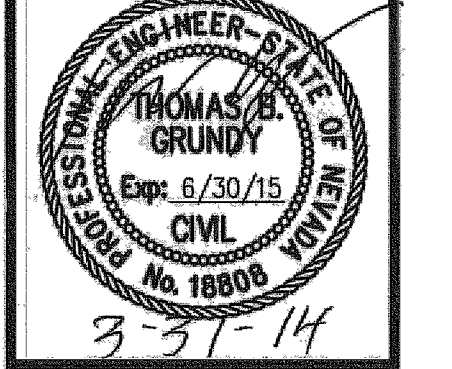

REV.	DATE	DESCRIPTION	BY	APP'D

**EAST/WEST WATER TRANSMISSION MAIN PROJECT - PHASE 2A-1 PROJECT No. 4.0900 SIGNING & STRIPING DETAILS**

FOR BIDDING PURPOSE ONLY