

EAST/WEST WATER TRANSMISSION MAIN PROJECT - PHASE 2A-1

CARSON CITY, NEVADA PROJECT 4.0900

BOARD OF SUPERVISORS

Bob Crowell	Mayor
Karen Abowd	Supervisor
Brad Bonkowski	Supervisor
John McKenna	Supervisor
Jim Shirk	Supervisor
Alan Glover	City Clerk

DESIGNED FOR:

CARSON CITY PUBLIC WORKS DEPARTMENT
OPERATIONS DIVISION
3505 BUTTI WAY
CARSON CITY, NV 89701
775-887-2355

GENERAL NOTES:

- ALL WORK SHALL CONFORM TO THE AMERICAN WATER WORKS ASSOCIATION (AWWA) STANDARDS PER NAC 445A.67145 (1)(g) AND THE "STANDARD SPECIFICATIONS FOR PUBLIC WORKS CONSTRUCTION" (SSPWC) AND THE "STANDARD DETAILS FOR PUBLIC WORKS CONSTRUCTION" (SDPWC) AS ADOPTED BY CARSON CITY. THE CONTRACTOR SHALL OBTAIN A PERMIT FOR PUBLIC WORKS CONSTRUCTION FROM THE CARSON CITY PERMIT CENTER PRIOR TO THE START OF CONSTRUCTION.
- ALL TRAFFIC CONTROL AND BARRICADING WITHIN THE CARSON CITY RIGHT-OF-WAY SHALL CONFORM TO SECTION 100.33, 332.04 AND 332.05 OF THE STANDARD SPECIFICATIONS, PART V OF THE MANUAL ON UNIFORM TRAFFIC CONTROL DEVICES, LATEST EDITION, AND THE UNR T2 CENTER, TEMPORARY TRAFFIC CONTROL GUIDELINES LATEST EDITION. A TRAFFIC CONTROL PLAN MUST BE SUBMITTED AND APPROVED BY THE CARSON CITY ENGINEERING DIVISION PRIOR TO ANY STREET CLOSURES.
- THE CONTRACTOR SHALL CALL UNDERGROUND SERVICE ALERT "CALL BEFORE YOU DIG" (811) OR (1-800-227-2600) AT LEAST TWO (2) WORKING DAYS PRIOR TO START OF CONSTRUCTION AND COMPLY WITH THE REQUIREMENTS OF NRS AND NAC 455 THROUGHOUT THE COURSE OF THE WORK. SEWER SERVICE LATERALS ARE NOT OWNED OR MARKED BY CARSON CITY.
- THE CONTRACTOR SHALL CALL THE CARSON CITY ENGINEERING DIVISION (887-2300) TWO (2) WORKING DAYS PRIOR TO THE START OF CONSTRUCTION. THE CONTRACTOR SHALL CALL ONE (1) WORKING DAY PRIOR TO REQUIRED INSPECTIONS AND TESTING. THE REQUIRED INSPECTIONS AND TESTING ARE LISTED ON THE INSPECTION RECORD ISSUED WITH EACH PERMIT. THE CONTRACTOR MUST HAVE THE PERMIT NUMBER AND THE DESCRIPTION LISTED ON THE INSPECTION RECORD TO SCHEDULE REQUIRED INSPECTIONS AND TESTING. FOR CITY CONTRACTED PROJECTS, THE CONTRACTOR SHALL SCHEDULE INSPECTIONS PER THE CONTRACT DOCUMENTS.
- FINAL INSPECTIONS WILL BE PERFORMED BY CARSON CITY ENGINEERING DIVISION ACCORDING TO THE CARSON CITY INSPECTIONS AND TESTING PROCEDURES. NOTE: THESE PROCEDURES REQUIRE SUBMITTAL OF RECORD DRAWING PRINTS BY THE CONTRACTOR AND 10 WORKING DAYS TO PREPARE A FINAL PUNCH LIST. ALL CONDITIONS OF THE FINAL INSPECTION MUST BE COMPLETED PRIOR TO FINAL ACCEPTANCE OR ANY APPROVAL OF A CERTIFICATE OF OCCUPANCY BY THE CARSON CITY ENGINEERING DIVISION.
- MODIFICATIONS TO THE APPROVED PLANS REQUIRES REVIEW AND APPROVAL BY THE CARSON CITY ENGINEERING DIVISION. WORK PERFORMED WITHOUT WRITTEN APPROVAL BY CARSON CITY ENGINEERING WILL REQUIRE REMOVAL AT THE CONTRACTORS EXPENSE.
- THE APPROVED PLAN, PERMIT AND INSPECTION RECORD MUST BE ON THE JOB SITE AT ALL TIMES.
- PLAN APPROVAL FOR SEWER AND WATER CONSTRUCTION SHALL EXPIRE ONE YEAR FROM DATE OF APPROVAL UNLESS CONSTRUCTION HAS BEEN INITIATED. (CCMC 12.06.180F, 12.01.140D)
- THE CONTRACTOR WILL BE SOLELY AND COMPLETELY RESPONSIBLE FOR ACQUIRING A STORMWATER DISCHARGE PERMIT FROM THE NEVADA DIVISION OF ENVIRONMENTAL PROTECTION (NDEP) INCLUDING DEVELOPING, SUBMITTING AND IMPLEMENTING A STORM WATER POLLUTION PREVENTION PLAN (SWPPP). THE CONTRACTOR SHALL DEVELOP, PLACE AND MAINTAIN STORM WATER PROTECTION DEVICES IN COMPLIANCE WITH THE NEVADA CONTRACTORS FIELD GUIDE FOR CONSTRUCTION SITE BEST MANAGEMENT PRACTICES (JUNE 2008).
- THE LOCATION OF EXISTING UTILITIES SHOWN ON THESE DRAWINGS IS BASED ON THE BEST INFORMATION AVAILABLE TO THE ENGINEER. IT SHALL BE THE CONTRACTORS' RESPONSIBILITY TO VERIFY THESE LOCATIONS AT THE PROPOSED POINTS OF CONNECTIONS AND IN AREAS OF POSSIBLE CONFLICT WITH NEW UTILITY INSTALLATION, PRIOR TO BEGINNING CONSTRUCTION. POTHOLES IS REQUIRED. SHOULD THE CONTRACTOR FIND ANY DISCREPANCIES BETWEEN THE CONDITIONS EXISTING IN THE FIELD AND THE INFORMATION SHOWN ON THESE DRAWINGS, HE SHALL NOTIFY THE ENGINEER BEFORE PROCEEDING WITH CONSTRUCTION.
- THE CONTRACTOR WILL BE SOLELY AND COMPLETELY RESPONSIBLE FOR THE CONDITIONS OF THE JOB SITE, INCLUDING SAFETY OF ALL PERSONS AND PROPERTY DURING PERFORMANCE OF THE WORK. THIS REQUIREMENT WILL APPLY CONTINUOUSLY AND NOT BE LIMITED TO NORMAL WORKING HOURS. THE CONTRACTOR SHALL BE RESPONSIBLE FOR THE DESIGN AND CONSTRUCTION OF PROPER SHORING OF TRENCHES IN ACCORDANCE WITH OCCUPATIONAL SAFETY LAWS. THE DUTIES OF THE ENGINEER DO NOT INCLUDE REVIEW OF THE ADEQUACY OF THE CONTRACTORS SAFETY IN, ON, OR NEAR THE CONSTRUCTION SITE.
- SHOULD IT APPEAR THAT THE WORK TO BE DONE, OR ANY MATTER RELATIVE THERETO, IS NOT SUFFICIENTLY DETAILED OR EXPLAINED ON THESE PLANS, THE CONTRACTOR SHALL CONTACT THE ENGINEER FOR SUCH FURTHER EXPLANATIONS AS MAY BE NECESSARY.
- ALL PVC WATER PIPELINES SHALL BE PRESSURE TESTED IN ACCORDANCE WITH AWWA STANDARD C605 PER NAC 445A.67145 (7)(b) PRIOR TO BEING FLUSHED, DISINFECTED OR SAMPLED FOR AN ANALYSIS OF WATER QUALITY. ALL PVC WATER PIPELINES ARE TO BE DISINFECTED ACCORDING TO AWWA STANDARD C651 PER NAC 445A.67145 (6)(c).

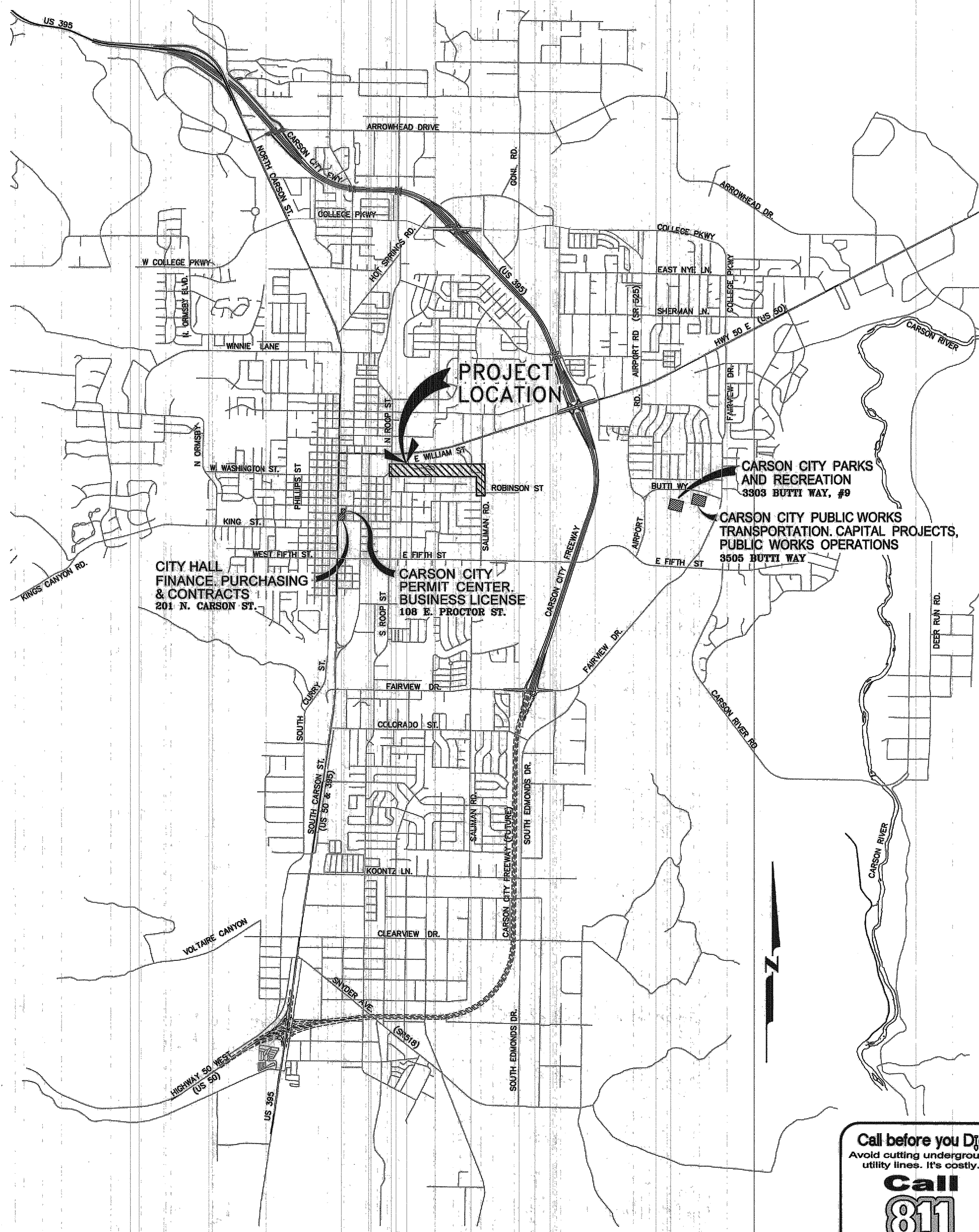

VICINITY MAP

N.T.S.

SHEET INDEX

- G1 TITLE SHEET
- G2 NOTES, LEGEND & ABBREVIATIONS
- G3 GENERAL NOTES
- G4 LANDSCAPE & IRRIGATION - GENERAL NOTES
- G5 SHEET INDEX / SURVEY CONTROL PLAN
- G6 & G7 STORM WATER POLLUTION PREVENTION PLAN
- G8 STORM WATER POLLUTION PREVENTION PLAN DETAILS
- C1 E. WASHINGTON ST "EW" & MILLS PARK LANE "MP" PLAN & PROFILE
- C2 to C5 MILLS PARK WATERLINE "WL1" - PLAN & PROFILE
- C6 N. SALIMAN RD. WATERLINE "SA" - PLAN & PROFILE
- C7 to C11 MILLS PARK WATERLINE "WL1" SITE RESTORATION PLAN
- C12 N. SALIMAN RD. WATERLINE "SA" SITE RESTORATION PLAN
- C13 to C18 CONSTRUCTION DETAILS
- C19 LANDSCAPE & IRRIGATION DETAILS
- C20 E. WASHINGTON ST / COMMUNITY CENTER SIGNING & STRIPING PLAN
- C21 OXOBY LOOP - SIGNING & STRIPING PLAN
- C22 SEELEY LOOP / N. SALIMAN RD. SIGNING & STRIPING PLAN
- C23 SIGNING & STRIPING DETAILS

REVIEWED FOR CITY REQUIREMENTS:

DARREN SCHULZ, P.E. - DEPUTY PUBLIC WORKS DIRECTOR DATE



APPLICATION NO. _____

DESIGNED BY: DGR
DRAWN BY: DGR
CHECKED BY: TBC
DWG NO.: 44500-15 PHASE 2A-1
SCALE (HORIZ): N/A
SCALE (VERT): N/A
DATE: 3/31/14

CARSON CITY
PUBLIC WORKS DEPARTMENT

3505 BUTTI WAY
CARSON CITY, NEVADA 89701
PH: 775-887-2355
FAX: 775-887-2112

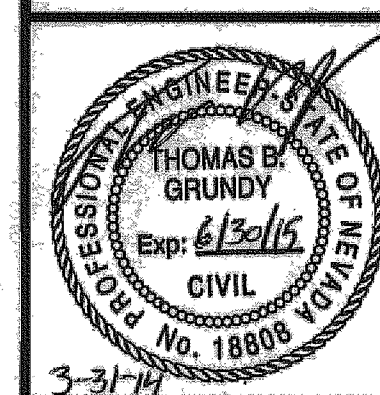

REV.	DATE	DESCRIPTION

EAST/WEST WATER TRANSMISSION
MAIN PROJECT - PHASE 2A-1
PROJECT No. 4.0900

TITLE SHEET

SHEET
G1
OF
31

FOR BIDDING PURPOSE ONLY

LEGEND

EXISTING		PROPOSED	
	BM#		BENCH MARK
			PROPERTY LINE
			EASEMENT LINE
			WATER VALVE
	8" W		WATER LINE
			WATER METER
	WS		WATER SERVICE
			FIRE HYDRANT
			AIR RELEASE VALVE
	8" SS		SEWER LINE
			SANITARY SEWER MANHOLE
			SANITARY SEWER CLEANOUT
	SS		SEWER SERVICE
	18" SD		STORM DRAIN GULVERT
			CHECK DAM
			STORM DRAIN MANHOLE
	CB		CATCH BASIN (SQUARE)
	CB		CATCH BASIN (ROUND)
	12"		DIRECTION OF DRAINAGE FLOW
			DRAINAGE SWALE
			GAS LINE
			GAS METER
			GAS VALVE
			OVERHEAD POWER
			UTILITY POLE
			ELECTRIC MANHOLE
			TELEPHONE LINE
			TELEPHONE MANHOLE
			FIBER OPTIC LINE
			LUMINAIRE
			LIGHT POLE
			SIGN
			CONTOUR LINES
			SPOT ELEVATION
			TREES
			PCC CURB & GUTTER TYPE 1
			GLUE DOWN CURB
			AC PAVEMENT
			PCC PAVEMENT
			FENCE LINE
			AREAS OF SPECIAL CONSTRUCTION INSTALL RESTRAINING GLANDS ON ALL PIPE JOINTS

ABBREVIATIONS

AB	AGGREGATE BASE	N	NORTH
AC	ASPHALTIC CONCRETE	NO	NUMBER
ACP	ASBESTOS CEMENT PIPE	NTS	NOT TO SCALE
APN	ASSESSORS PARCEL NUMBER	PCC	POINT OF CURVATURE
APPROX	APPROXIMATE	PC	PORTLAND CEMENT CONCRETE
ARV	AIR RELEASE VALVE	PE	POLYETHYLENE
ASTM	AMERICAN SOCIETY FOR TESTING MATERIALS	PEB	PEDESTRIAN
BCR	BEGIN CURB RETURN	PI	POINT OF INTERSECTION
BVC	BEGIN VERTICAL CURVE	PL	PROPERTY LINE
CATV	CABLE TV	PRV	PRESSURE REDUCING VALVE
CB	CATCH BASIN	PT	POINT OF TANGENCY
CL	CENTER LINE, CLASS CONCRETE	PVC	POLYVINYLCHLORIDE
COND	CONDUIT	PVI	POINT OF VERTICAL INTERSECTION
COND	CONDUIT	PVMT	PAVEMENT
C&G	CURB & GUTTER	R	RADIUS
DI	DROP INLET	R&R	REMOVE & REPLACE
DTL	DETAIL	RCP	REINFORCED CONCRETE PIPE
DIA	DIAMETER	ROW	RIGHT OF WAY
DWY	DRIVEWAY	RT	RIGHT
EXIST	EXISTING	S	SLOPE, SOUTH
E	EACH	SD	STORM DRAIN
EA	END CURB RETURN	SDMH	STORM DRAIN MANHOLE
EL	ELEVATION	SDWK	SIDEWALK
ELEV	EDGE OF PAVEMENT	SF	SQUARE FEET
EQ	EQUAL	SHT	SHEET
EVC	END VERTICAL CURVE	SRV	SERVE
FES	FLARED END SECTION	SS	SANITARY SEWER
FG	FINISH GRADE	SSCO	SANITARY SEWER CLEANOUT
FL	FLOWLINE	SSMH	SANITARY SEWER MANHOLE
FLG	FLANGE	ST	STREET
FT	FEET	STA	STATION
G	GRADE BREAK	STEEL	STEEL
GB	GAS VALVE/GATE VALVE	T	TELEPHONE
GV	HORIZONTAL	TBC	TOP BACK OF CURB
HORIZ	HORIZONTAL	TOP	TOP OF CURB
HP	HIGH POINT	TRANS	TRANSITION
HV	HORIZONTAL/VERTICAL	TR	TYPICAL
IE	INVERT ELEVATION	UG	UNDERGROUND
IRR	IRRIGATION LINE	UG	UNDERGROUND ELECTRIC
IRR	IRRIGATION LINE	VC	VERTICAL CURVE
L	LENGTH	W	WEST, WATER
LAT	LATERAL	WM	WATER METER
LF	LINEAL FEET	W/O	WITHOUT
LT	LEFT	WV	WATER VALVE
LX	LINEAL FEET	XING	CROSSING
MAX	MAXIMUM		
MH	MANHOLE		
MJ	MECHANICAL JOINT		
MIN	MINIMUM		

CONSTRUCTION NOTES:

1. INSTALL PVC C905, DR-25, 165 PSI BELL & SPIGOT OR FUSIBLE PVC WATER MAIN (WHERE INDICATED ON PLAN) PER MODIFIED STD DRAWING C-1.2.1, JOINT RESTRAINTS FOR PVC PIPE SHALL BE USED ON ALL FITTINGS, AND AT SPECIFIC LOCATIONS WHERE IDENTIFIED ON THE PLAN. INSTALLATION PER MANUFACTURER'S RECOMMENDATIONS.
2. INSTALL 24" BUTTERFLY VALVE PER DETAIL 1, SHEET C14, WITH NUT EXTENDER TO EXTEND TOP OF NUT TO BETWEEN 18" TO 24" FROM TOP OF VALVE BOX.
3. INSTALL LINE LOCATION BOX & LID PER STD DRAWINGS C-1.2.2 & C-1.2.3, AT ALL HORIZONTAL BEND LOCATIONS, UNLESS A WATER VALVE BOX IS AT SAME LOCATION.
4. INSTALL 2" POTABLE WATER AIR RELEASE VALVE PER STD. DRAWING C-3.1.10.
5. INSTALL PERMANENT FLUSH ASSEMBLY PER STD. DRAWING C-3.1.12.
6. INSTALL FLUSH ASSEMBLY PER DETAIL 5, SHEET C14.
7. POTHOLE TO VERIFY EXACT DEPTH AND/OR MAKE & MATERIALS.
8. PROTECT-IN-PLACE
9. ADJUST EXISTING WATER VALVE BOX TO NEW FINISH GRADE PER STD. DRAWING C-3.1.4.
10. WATER MAIN CROSSING EXISTING UTILITY PER STD DRAWINGS C-3.1.6 & C3.1.9
11. PROVIDE "SPECIAL CONSTRUCTION" MITIGATION TO AFFECTED LINES AS REQUIRED, PER "WATER/SEWER SEPARATION GUIDELINES". INSTALL MECHANICAL JOINT RESTRAINTS TO LIMITS SHOWN ON PLANS, PER MANUFACTURER'S RECOMMENDATIONS. JOINTLESS WELDED OR FUSIBLE PIPE MAY BE USED IN LIEU OF RESTRAINED JOINTS.
12. INSTALL JOINT RESTRAINTS FOR USE WITH C-905 PVC PIPE TO LIMITS SHOWN ON PLANS, PER MANUFACTURER'S RECOMMENDATIONS. FUSIBLE C-905 PVC PIPE MAY BE USED IN LIEU OF RESTRAINED JOINTS.
13. CONSTRUCT GRADE BREAK TRANSITION PER DETAIL 4, SHEET C14.
14. INSTALL TAPPING SLEEVE, PER STD. DRAWING C-3.1.3. WITH GATE VALVE PER STD. DRAWING C-3.1.4.
15. LIMITS OF FULL DEPTH SAWCUT AND REMOVAL OF EXISTING AC PAVEMENT.
16. CONSTRUCT PERMANENT PAVEMENT PATCH PER STD DRAWING C-5.1.6
17. INSTALL FIRE HYDRANT ASSEMBLY PER STD. DRAWING C-3.1.7
20. INSTALL 4" DIAMETER, SCH 40, PVC CONDUITS WITH PULL ROPE, PER MODIFIED STD DWG C-1.2.1, LARGE RADIUS (36" MIN.) SWEEPS ONLY, ENCASED WITH 6" (INCHES) CONCRETE, WHERE REQUIRED.
21. INSTALL No. 9 PULL BOX WITH TRAFFIC RATED, BOLT DOWN, STEEL COVER MARKED "FIBER OPTIC" PER DETAIL 7, SHEET C15.
22. INSTALL NEW BASIS FIBERGLASS/POLYMER CONCRETE PULL BOX "FOA 400036T-00006" WITH, BOLT DOWN, COVER MARKED "FIBER OPTIC" PER DETAIL 7, SHEET C15.
23. REMOVE AND REPLACE EXISTING CURB, GUTTER & SIDEWALK AS REQUIRED FOR PULL BOX INSTALLATION, SET PULLBOX FLUSH WITH ADJACENT WALKWAY.
30. INSTALL 15" CLASS III RCP STORM DRAIN PIPE PER STD DRAWING C-1.2.1,
31. INSTALL CATCH BASIN TYPE 4R PER STD. DRAWING C-4.1.5.
32. CONSTRUCT CONCRETE HEADWALL PER DETAIL 1, SHEET C16.
40. CONSTRUCT PCC CURB AND GUTTER TYPE 1, PER STD. DRAWING C-5.1.3.
41. REMOVE & REPLACE PCC PLAY AREA CURB AS REQUIRED, PER DETAIL 1, SHEET C16.
42. CONSTRUCT PCC DRIVEWAY APRON TYPE 1, PER STD. DRAWING C-5.2.3. (WIDTH PER PLAN)
43. CONSTRUCT TYPE "A" SIDEWALK PER STD. DRAWING C-5.2.2. (WIDTH PER PLAN)
44. RECONSTRUCT ALL EXISTING SIDEWALK DAMAGED AS A RESULT OF PIPELINE CONSTRUCTION (WIDTH PER PLAN) FINISH SHALL MATCH EXISTING OR PICTURE FRAME STYLE PER DETAIL 3, SHEET C11.
45. CONSTRUCT PARALLEL CURB RAMP APEX, PER STD. DRAWING C-5.3.5.
46. CONSTRUCT LINEAR CURB RAMP SINGLE ADJACENT, PER STD. DRAWING C-5.3.8.
47. CONSTRUCT MID BLOCK CURB RAMP, PER STD. DRAWING C-5.3.9.
48. CONSTRUCT PCC RETAINING CURB AS REQUIRED, PER STD. DRAWING C-5.3.10.
49. CONSTRUCT PCC VALLEY GUTTER, 4 FEET WIDE, PER STD. DRAWING C-5.1.2.
50. CONSTRUCT AC SPEED BUMP PER DETAIL 2, SHEET C7
51. REMOVE & REPLACE PCC TREE RING CURB, PER DETAIL 2, SHEET C16.
52. CONSTRUCT PERPENDICULAR CURB RAMP DIRECTIONAL PER STD. DRAWING C-5.3.2.
60. PAINT 24" WIDE SOLID WHITE CROSSWALK STRIPING PER STD DWG C-5.4.3
61. PAINT 24" WIDE SOLID WHITE STOP BAR PER STD DWG C-5.4.3
62. PAINT 6" WIDE SOLID WHITE LANE STRIPE
63. PAINT 4" WIDE SOLID DOUBLE YELLOW CENTERLINE STRIPE
64. PAINT 4" WIDE SOLID YELLOW WITH 4" WIDE YELLOW SKIP CENTERLINE STRIPE
65. PAINT 4" WIDE SOLID YELLOW CENTERLINE STRIPE
66. PAINT 4" WIDE SOLID WHITE SKIP STRIPE LANE LINE
67. PAINT 4" WIDE SOLID WHITE PARKING STALL STRIPE
68. PAINT 4" SOLID WHITE PARALLEL PARKING "T" PER DETAIL 1, SHEET C23.
69. PAINT HANDICAP PARKING LEGEND (WHITE ON BLUE FIELD)
70. PAINT 4" SOLID WHITE BOUNDARY LINE WITH 4" SOLID WHITE CROSS HATCH INFILL (45° ANGLE AT 3' ON CENTER)
71. PAINT 4" SOLID WHITE LINE
72. PAINT SOLID WHITE DIRECTIONAL ARROW LEGEND AS SHOWN
73. PAINT SOLID WHITE PAVEMENT LEGEND AS SHOWN
74. PAINT SPEED BUMP SOLID HIGH VISIBILITY YELLOW
75. PAINT CURB RED (NO PARKING ZONE)
76. INSTALL SIGN & POST PER STD DRAWING C-5.4.2
77. REMOVE EXISTING SIGN & POST, GRIND FLUSH WITH CONCRETE, FILL ANNULAR SPACE WITH NON SHRINK GROUT.
78. PAINT 6" SOLID WHITE BOUNDARY LINE WITH 6" SOLID WHITE CHEVRON HATCH INFILL AT 6" ON CENTER
79. INSTALL CONCRETE WHEEL STOP PER STD. DRAWING C-5.5.2
80. PERFORM TREE ROOT PRUNING AS REQUIRED PER SPECIFICATIONS.
81. PROVIDE TREE PROTECTION AROUND PERIMETER AS REQUIRED.

DESIGNED BY: DGR	DRAWN BY: DGR	CHECKED BY: TEG	DWG NO.: 0900-TS PHASE 2A-1	SCALE (HORIZ): N/A	SCALE (VERT): N/A	DATE: 3/31/14
------------------	---------------	-----------------	-----------------------------	--------------------	-------------------	---------------

**CARSON CITY
PUBLIC WORKS DEPARTMENT**

3505 BUTTE WAY CARSON CITY, NEVADA 89701
PH: 775-887-2355 FAX: 775-887-2112

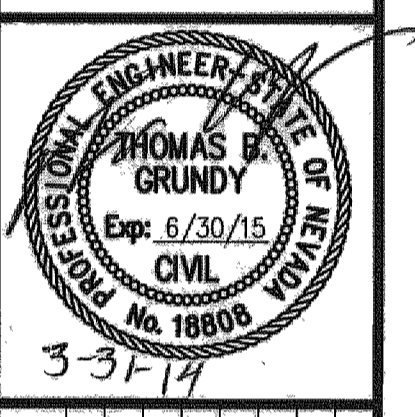

REV.	DATE	DESCRIPTION	BY	APP'D

**EAST/WEST WATER TRANSMISSION MAIN
PROJECT - PHASE 2A-1
PROJECT No. 4-0900**

NOTES, LEGEND, & ABBREVIATIONS

SHEET
62
OF
31

FOR BIDDING PURPOSE ONLY

14:PROJECTS\40000 E-W Transmission Main Phase 2A-1\0900-TS PHASE 2A-1.dwg 3/29/14

- WATER MAIN SHUTDOWNS/INTERRUPTION OF WATER/FIRE SERVICE, OBTAIN TENTATIVE APPROVAL FROM CARSON CITY WATER UTILITY PRIOR TO PLANNING A SHUTDOWN. APPROVAL IS REQUIRED ONE WORKING DAY PRIOR TO NOTIFICATION OF CUSTOMERS. COMMERCIAL CUSTOMERS SHALL RECEIVE 2 WORKING DAYS WRITTEN AND VERBAL NOTICE OF A SHUTDOWN. SPECIAL ARRANGEMENTS INCLUDING NIGHT TIME SHUTDOWNS MAY BE REQUIRED OF THE CONTRACTOR TO ACCOMMODATE CUSTOMER OPERATIONS. RESIDENTIAL CUSTOMERS SHALL RECEIVE 24 HOURS WRITTEN NOTICE. NOTICE IS PERFORMED BY CITY STAFF. THE CITY IS RESPONSIBLE FOR THE NOTIFICATION. THE CONTRACTOR IS RESPONSIBLE IN ALL OTHER CASES. A LIST SHALL BE KEPT BY THE RESPONSIBLE PARTY LISTING THE DATE, TIME AND ADDRESS OF ALL PERSONS NOTIFIED. THE PERSON NOTIFIED SHALL BE INCLUDED ON THE LIST FOR ALL COMMERCIAL CUSTOMERS. CONTACT CARSON CITY WATER UTILITY FOR PHONE NUMBERS WHEN COMMERCIAL CUSTOMERS CANNOT BE LOCATED. THE CONTRACTOR WILL BE SUBJECT TO DAMAGE CLAIMS SHOULD THEY FAIL TO NOTIFY CUSTOMERS OR MAINTAIN DOCUMENTATION OF NOTIFICATION OF CUSTOMERS. THE TOTAL TIME OF ANY WATER SERVICE INTERRUPTION IS LIMITED TO 4 HOURS MAXIMUM. THE CONTRACTOR SHALL NOT OPERATE ANY EXISTING WATER VALVES. WATER MAIN SHUTDOWNS WILL ONLY BE SCHEDULED FOR TUESDAYS, WEDNESDAYS, OR THURSDAYS. EXCLUDING THE WORKING DAYS BEFORE AND AFTER A HOLIDAY. CONTRACTOR SHALL MAKE A WRITTEN REQUEST TO THE WATER OPERATIONS CHIEF, A MINIMUM OF 10 CALENDAR DAYS IN ADVANCE OF ANY PLANNED SHUTDOWN.
- WATER MAINS (6 INCH THRU 12 INCH) SHALL BE PVC C900, DR 18 (MINIMUM WALL THICKNESS) UNLESS HIGHER PRESSURE IS SPECIFIED ON THE PLANS. WATER SERVICES 2 INCHES OR LESS SHALL BE CTS, PE TUBING MINIMUM 200 PSI; WATER SERVICES 3 INCHES OR GREATER SHALL BE 4 INCH MINIMUM DIAMETER PVC C900, DR 18 OR AS SPECIFIED ON THE PLANS.
- MAINTAIN 18 INCHES VERTICAL AND 18 FEET HORIZONTAL SEPARATION BETWEEN WATER LINES AND ALL UNDERGROUND POWER LINES. IF WATER LINE IS BELOW POWER LINE OR IS WITHIN 18 INCH VERTICAL SEPARATION OF POWER LINE, POWER LINE SHALL BE ENCASED WITH 4 INCHES MINIMUM OF CONCRETE EXTENDING 5 FEET EACH SIDE OF CROSSING. (SEE NV ENERGY SPECS.) CONCRETE ENCASEMENT OF WATER LINES IS NOT ALLOWED.
- ALL HOT TAPS, GREATER THAN 2 INCHES AND LESS THAN 14 INCHES, ARE TO BE PERFORMED BY CARSON CITY WATER UTILITY. THE CONTRACTOR SHALL CONTACT THE WATER OPERATIONS CHIEF AT LEAST 2 WORKING DAYS PRIOR TO SCHEDULING HOT TAP DATE AND TIME (HOT TAPS ARE PERFORMED TUESDAY THRU THURSDAY EXCLUDING THE WORKING DAYS BEFORE AND AFTER A HOLIDAY). PRIOR TO HOT TAPPING, THE SADDLE SHALL BE HYDROSTATICALLY PRESSURE TESTED TO 150 PSI MINIMUM OR THE DESIGN OF PIPE SYSTEM FOR A MINIMUM OF 5 MINUTES. THE TEST SHALL BE PERFORMED IN THE PRESENCE OF THE WATER UTILITY PERSONNEL PRIOR TO PERFORMING THE TAP.
- WATER VALVE MARKERS SHALL BE BLUE CARSONITE UTILITY MARKER (CUM-375), 5 FEET-2 INCHES (5'-2") WITH CARSON CITY WATER VALVE DECAL (CWV-116) OR APPROVED EQUAL. PLACE MARKER NO MORE THAN 5 FEET FROM THE VALVE OR AS DIRECTED BY THE CARSON CITY INSPECTOR.
- REDUCED PRESSURE PRINCIPLE AND DOUBLE CHECK VALVE BACKFLOW ASSEMBLIES SHALL BE APPROVED BY THE CARSON CITY INSPECTOR, AND TESTED BY A CERTIFIED BACKFLOW ASSEMBLY TESTER, AND TEST RESULTS SHALL BE APPROVED BY CARSON CITY WATER UTILITY. FOR NEW WATER METER SETS, THE REQUIRED BACKFLOW PREVENTION ASSEMBLY SHALL BE INSTALLED, INSPECTED, APPROVED AND CERTIFIED TEST RESULTS PROVIDED TO THE CARSON CITY INSPECTOR WITHIN 5 DAYS OF METER SET. UNLESS THE CARSON CITY ENGINEER OR PUBLIC WORKS DIRECTOR APPROVES OTHERWISE, THE SERVICES WILL BE LOCKED OFF IF INSPECTIONS AND CERTIFICATIONS ARE NOT COMPLETED AS SPECIFIED ABOVE. A 25 DOLLAR FEE WILL BE ASSESSED AT TIME OF TURN-ON WHEN LOCK IS REMOVED DURING NORMAL WORKING HOURS. THE FEE WILL BE ASSESSED ON THE BUILDING PERMIT FOR THE INSTALLATION OF THE BACKFLOW DEVICE.
- ALL WATER MAIN, WATER/FIRE SERVICE, AND BACKFLOW PREVENTION INSPECTIONS AND TESTING MUST BE APPROVED PRIOR TO APPROVAL OF ANY CERTIFICATE OF OCCUPANCY.
- DISINFECTION TABLETS SHALL BE PLACED USING TITEBOND MULTI-PURPOSE CLEAR 100% SILICONE OR APPROVED EQUAL FOOD GRADE SILICONE.

NO.	REVISION	DATE	STANDARD DETAIL FOR PUBLIC WORKS CONSTRUCTION	SECTION CARSON CITY DRAWING NO. C-3.1.1 (307) DATE
WATER GENERAL NOTES (MODIFIED)				
APPROVED BY:		07/09		7/2009

- MANHOLE MATERIALS AND CONSTRUCTION SHALL CONFORM TO THE REQUIREMENTS OF SECTION 204 "MANHOLES AND CATCH BASINS" OF THE SSPWC.
- MARKING TAPE SHALL BE INSTALLED 12 INCHES ABOVE ALL STORM DRAIN PIPE. TAPE WIDTH SHALL BE 3 INCHES, THICKNESS SHALL BE FOUR (4) MIL OR GREATER AND SHALL BE GREEN AND BEAR LARGE PRINTING DENOTING "CAUTION BURIED STORM DRAIN LINE BELOW" OR EQUIVALENT WORKING.
- PORTLAND CEMENT CONCRETE (P.C.C.) SHALL HAVE THE FOLLOWING CHARACTERISTICS: 4000 PSI MIN. COMPRESSIVE STRENGTH @ 28 DAYS, CURB AND BUTTIEF TRANSITION ONLY, ALL UNEXPOSED CONCRETE MAY BE 3000 PSI MIN. 6 SACKS OF CEMENT PER CUBIC YARD WITH A MAX. WATER/CEMENT RATIO OF 0.45, AIR ENTRAINMENT 8% ±1.5%, SLUMP AT 1 TO 4 INCHES. ALL MATERIALS SHALL CONFORM TO SSPWC SECTION 202.
- REINFORCING STEEL SHALL BE GRADE 40 AND HAVE 1.5 INCHES MINIMUM CLEAR COVER.
- EACH CATCH BASIN SHALL HAVE A 4 INCH ALUMINUM BLUE DISK WITH FISH IMAGE AND THE WORDS "NO DUMPING DRAINS TO RIVER" (ALMETEK 3D-4 OR APPROVED EQUAL) INSTALLED ON THE TOP OF THE CURB BOX.
- FRAMES AND GRATES SHALL BE MATCHED TO ACHIEVE A CLOSE TOLERANCE FIT, WITH MINIMAL GAPS, AS APPROVED BY THE CARSON CITY ENGINEER OR PUBLIC WORKS DIRECTOR.
- STORM DRAINAGE IMPROVEMENTS SHALL INCORPORATE WATER QUALITY AND EROSION CONTROLS IN ACCORDANCE WITH THE NEVADA "HANDBOOK OF BEST MANAGEMENT PRACTICES".
- PRECAST MANHOLES SECTIONS, OTHER THAN GRADE RINGS, SHALL BE JOINED WITH FLEXIBLE PLASTIC GASKET MATERIAL SUCH AS RAM-NEK OR APPROVED EQUAL PER MANUFACTURERS RECOMMENDATIONS.
- TRACER WIRE SHALL BE ATTACHED TO ANY STORM DRAIN LATERAL WHICH IS NOT PERPENDICULAR TO THE STORM DRAIN MAIN.
- MANHOLES LOCATED OUTSIDE PAVED AREAS SHALL REQUIRE ALL WEATHER ACCESS ROADWAY CONSISTING OF 6 INCHES TYPE 2, CLASS B AGGREGATE BASE (CONFORMING TO THE SSPWC SECTION 200.01.02) AND STORM DRAIN MANHOLE MARKERS BE INSTALLED. STORM DRAIN MANHOLE MARKERS SHALL BE GREEN CARSONITE UTILITY MARKER (CUM 375), 5 FEET-2 INCHES (5'-2") WITH DECAL READING "STORM DRAIN MANHOLE". PLACE MARKERS ON EASEMENT LINE NEAREST TO MANHOLE OR AS DIRECTED BY THE CARSON CITY ENGINEER OR PUBLIC WORKS DIRECTOR.
- MANHOLE CONCRETE COLLARS SHALL BE LEFT 2 1/2 INCHES TO 3 INCHES BELOW FINISHED ASPHALT SURFACE. APPLY AN APPROVED TACK COAT (CONFORMING TO THE SSPWC SECTION 316) AND FILL VOID BETWEEN ADJACENT PAVEMENT AND FRAME WITH TYPE 3 AC 20 PAVING (CONFORMING TO THE SSPWC SECTION 320). APPLY FOG SEAL (CONFORMING TO SSPWC SECTION 317) TO THE ASPHALT SURFACE. ALL CUTS IN PAVING SHALL BE STRAIGHT AND EVEN, EXCEPTION: WHEN STRUCTURE NOT LOCATED IN ASPHALT PAVEMENT OR LOCATED IN AN UNPAVED AREA, EXTEND CONCRETE TO FINISH GRADE.
- GRATES SHALL BE PLACED OUTSIDE OF THE PEDESTRIAN TRAVELED WAY. GRATE OPENINGS SHALL NOT EXCEED 0.5 INCHES IN WIDTH OR 4 INCHES IN LENGTH. GRATES SHALL BE TRAFFIC RATED AND ADA COMPLIANT.

NO.	REVISION	DATE	STANDARD DETAIL FOR PUBLIC WORKS CONSTRUCTION	SECTION CARSON CITY DRAWING NO. C-4.1.1 DATE
STORM DRAIN GENERAL NOTES				
APPROVED BY:		7/09		7/2009

- NO CONCRETE SHALL BE PLACED UNTIL FORMS AND SUBGRADE ARE INSPECTED AND APPROVED BY CARSON CITY PUBLIC WORKS.
- PORTLAND CEMENT CONCRETE (P.C.C.) SHALL HAVE THE FOLLOWING CHARACTERISTICS: SYNTHETIC FIBER-REINFORCEMENT (AT A MINIMUM OF 1 POUND PER CUBIC YARD), WITH COARSE AGGREGATE GRADATION CONFORMING TO SIZE NO. 67 PER SECTION 200.05.03 OF THE STANDARD SPECIFICATIONS, AND SHALL HAVE A 1 TO 4 INCH SLUMP, AND 4 TO 7 PERCENT ENTRAINED AIR. 4000 PSI MIN. COMPRESSIVE STRENGTH @ 28 DAYS, MIN 6 SACKS OF TYPE II CEMENT PER CUBIC YARD WITH A MAX. WATER/CEMENT RATIO OF 0.45, AIR ENTRAINMENT 8% ±1.5%, SLUMP AT 1 TO 4 INCHES. ALL MATERIALS SHALL CONFORM TO SSPWC SECTION 202. OF THE STANDARD SPECIFICATIONS FOR PUBLIC WORKS CONSTRUCTION.
- ALL CONCRETE EDGING AND JOINTING SHALL BE CONSTRUCTED IN ACCORDANCE WITH STD. DETAIL C-5.1.1 AND CONFORM TO SEC. 312.09 OF THE STANDARD SPECIFICATIONS FOR PUBLIC WORKS CONSTRUCTION (SSPWC).
- IF OBSTRUCTIONS SUCH AS INLETS, UTILITY POLES, FIRE HYDRANTS, ETC. ARE ENCOUNTERED, THE LOCATION AND DIMENSIONS MAY BE ADJUSTED UPON APPROVAL BY CARSON CITY PUBLIC WORKS. A MINIMUM SURFACE OF 5 FEET X 5 FEET CLEAR IS REQUIRED WHEN DIRECTION OF TRAVEL MAY CHANGE AND A MINIMUM SURFACE OF 4 FEET CLEAR IS REQUIRED WHERE DIRECTION OF TRAVEL IS NOT EXPECTED TO CHANGE, UNLESS OTHERWISE APPROVED BY THE CARSON CITY ENGINEER OR PUBLIC WORKS DIRECTOR.
- EXISTING CONCRETE SHALL BE REMOVED TO A NEAT SAWCUT LINE OR NEAREST EXPANSION JOINT.
- ALL AGGREGATE BASE SHALL BE TYPE 2, CLASS B AND SHALL CONFORM TO SEC.200.01. OF THE STANDARD SPECIFICATIONS FOR PUBLIC WORKS CONSTRUCTION (SSPWC).
- NEW CONCRETE SHALL HAVE A HEAVY BROOM FINISH PERPENDICULAR TO SIDEWALK.

NO.	REVISION	DATE	STANDARD DETAIL FOR PUBLIC WORKS CONSTRUCTION	SECTION CARSON CITY DRAWING NO. C-5.2.1 DATE
SIDEWALK AND DRIVEWAY GENERAL NOTES				
APPROVED BY:		7/09		7/2009

WATER/SEWER SEPARATION GUIDELINES

PREFERRED DESIGN/NO MITIGATION REQUIRED

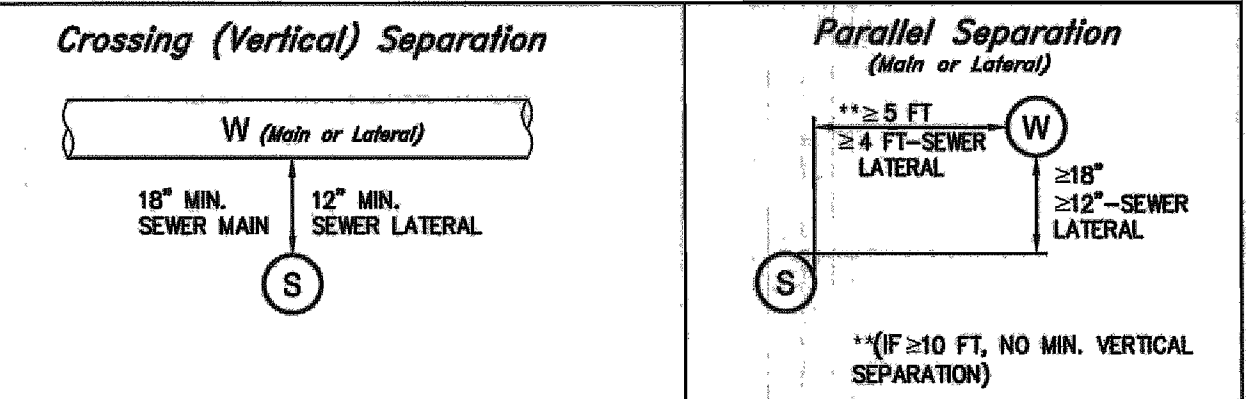

MITIGATED DESIGN/CONSTRUCTION CONFIGURATION

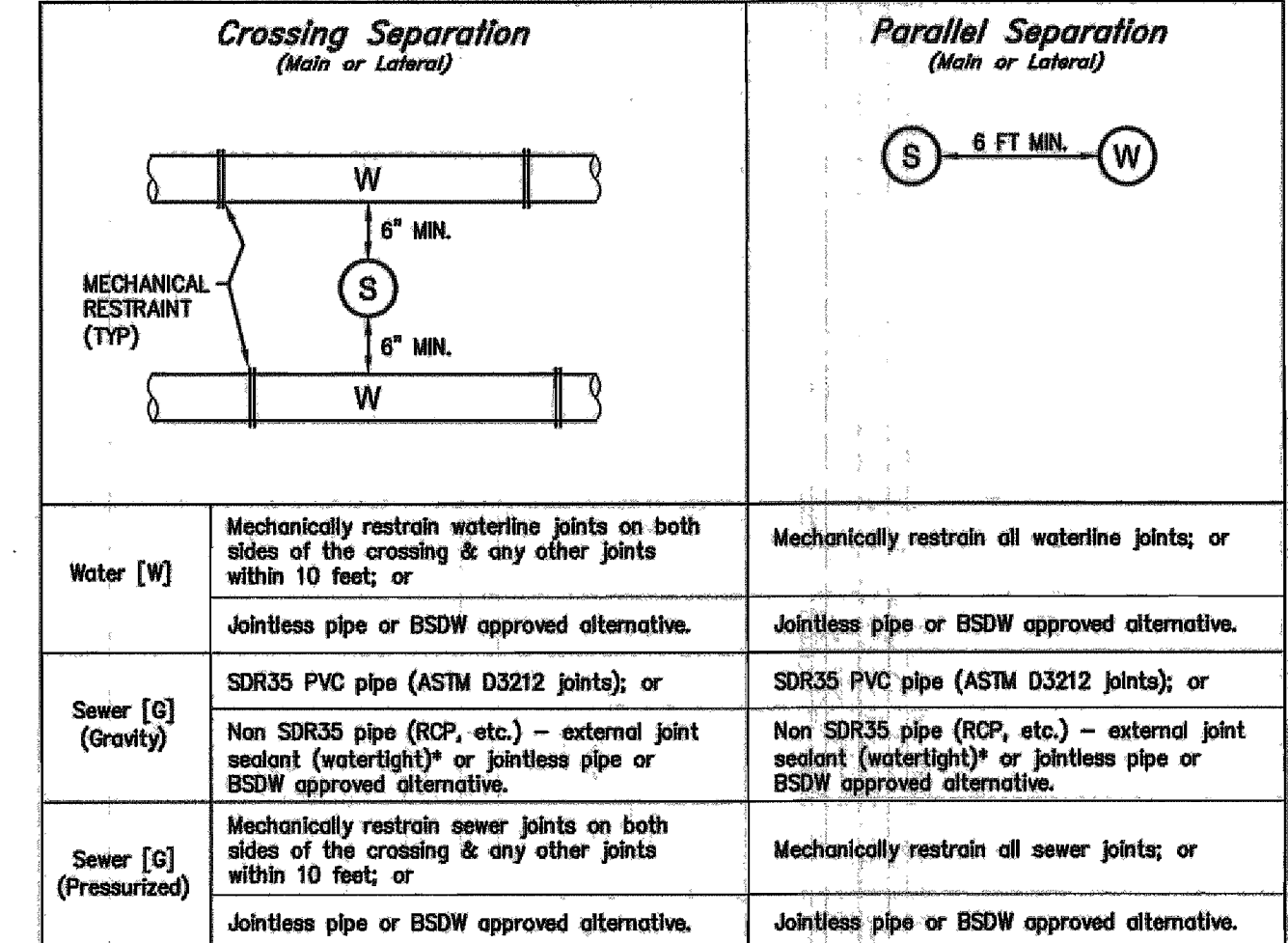

SPECIAL CONSTRUCTION / VERTICAL CROSSING CONFLICTS NOTES:

- "SPECIAL CONSTRUCTION" IS REQUIRED WHENEVER SEWER/STORM DRAIN/IRRIGATION/RECLAIMED/NON-POTABLE CROSSES ABOVE WATER, REGARDLESS OF VERTICAL SEPARATION.
- "SPECIAL CONSTRUCTION" IS REQUIRED IF WATER MAIN DOES NOT CROSS AT LEAST 18 INCHES ABOVE SEWER/STORM DRAIN/ IRRIGATION/RECLAIMED/NON-POTABLE MAIN.
- AT CROSSINGS REQUIRING "SPECIAL CONSTRUCTION", MITIGATION MUST BE PROVIDED TO BOTH AFFECTED LINES. IN ADDITION TO CENTERING AND RESTRAINING THE WATER MAIN, THE EXISTING SEWER/STORM DRAIN/ IRRIGATION/RECLAIMED/NON-POTABLE MAIN/LATERALS MUST ALSO BE PROTECTED PER THE "WATER/SEWER SEPARATION GUIDELINES" LISTED ABOVE.

- NO CONCRETE SHALL BE PLACED UNTIL FORMS AND SUBGRADE ARE INSPECTED BY CARSON CITY ENGINEERING DIVISION.
- PORTLAND CEMENT CONCRETE (P.C.C.) SHALL HAVE THE FOLLOWING CHARACTERISTICS: SYNTHETIC FIBER-REINFORCEMENT (AT A MINIMUM OF 1 POUND PER CUBIC YARD), 4000 PSI MIN. COMPRESSIVE STRENGTH @ 28 DAYS, MIN 6 SACKS OF CEMENT PER CUBIC YARD WITH A MAX. WATER/CEMENT RATIO OF 0.45, AIR ENTRAINMENT 8% ±1.5%, SLUMP AT 1 TO 4 INCHES. ALL MATERIALS SHALL CONFORM TO SSPWC SECTION 202. OF THE STANDARD SPECIFICATIONS FOR PUBLIC WORKS CONSTRUCTION.
- ALL CONCRETE EDGING AND JOINTING SHALL BE CONSTRUCTED IN ACCORDANCE WITH STD. DETAIL C-5.1.1 AND CONFORM TO SEC. 312.09 OF THE STANDARD SPECIFICATIONS FOR PUBLIC WORKS CONSTRUCTION (SSPWC).
- IF OBSTRUCTIONS SUCH AS INLETS, UTILITY POLES, FIRE HYDRANTS, ETC. ARE ENCOUNTERED, THE LOCATION AND DIMENSIONS MAY BE ADJUSTED UPON APPROVAL BY CARSON CITY ENGINEER OR PUBLIC WORKS DIRECTOR. A MINIMUM LANDING OF 5 FEET X 5 FEET CLEAR IS REQUIRED WHEN DIRECTION OF TRAVEL MAY CHANGE. A MINIMUM OF 4 FEET CLEAR IS MAY BE USED UPON APPROVAL OF THE CARSON CITY ENGINEER OR PUBLIC WORKS DIRECTOR WHERE DIRECTION OF TRAVEL IS NOT EXPECTED TO CHANGE.
- WHEN A CROSSWALK IS SERVICED BY RAMP, LANDINGS SHALL BE CONTAINED WITHIN THE CROSSWALK AREA.
- EXISTING CONCRETE SHALL BE REMOVED TO A NEAT SAWCUT LINE OR NEAREST EXPANSION JOINT.
- PLANTMIX BITUMINOUS SURFACE SHALL BE FLUSH WITH THE EDGE OF THE CUTTER PAN IN THE AREA OF THE CURB RAMP. GUTTER SHALL MAINTAIN POSITIVE DRAINAGE TO PREVENT PONDING.
- ALL AGGREGATE BASE SHALL BE TYPE 2, CLASS B AND SHALL CONFORM TO SEC.200.01. OF THE STANDARD SPECIFICATIONS FOR PUBLIC WORKS CONSTRUCTION (SSPWC).
- NEW CONCRETE SHALL HAVE A HEAVY BROOM FINISH PERPENDICULAR TO SIDEWALK.
- DETECTABLE WARNINGS SHALL BE EAST JORDAN IRON WORKS 7005 SERIES CAST IRON DETECTABLE WARNING PLATES OR APPROVED EQUAL. INSTALLED PER MANUFACTURERS INSTALLATION GUIDELINES AND CONFORM TO ADAAG (4.26) "DETECTABLE WARNINGS". COLOR: ASPHALT DIPPED UNLESS OTHERWISE APPROVED BY CARSON CITY ENGINEER OR PUBLIC WORKS DIRECTOR. RADIAL DETECTABLE WARNINGS SHALL BE USED WHEN REQUIRED TO MAINTAIN MINIMUM CLEARANCE OF 3 INCHES AND MAXIMUM CLEARANCE OF 8 INCHES FROM DETECTABLE WARNINGS TO BACK FACE OF CURB. RADIAL DETECTABLE WARNINGS SHALL HAVE A RADIUS WITHIN 5 FEET OF BACK FACE OF CURB RADIUS.

NO.	REVISION	DATE	STANDARD DETAIL FOR PUBLIC WORKS CONSTRUCTION	SECTION CARSON CITY DRAWING NO. C-5.3.1 DATE
CURB RAMP GENERAL NOTES				
APPROVED BY:		7/09		7/2009

DESIGNED BY: DGR
DRAWN BY: DGR
CHECKED BY: TEG
DWG. NO.: 40900-15 PHASE 2A-1
SCALE (HORIZ): N/A
SCALE (VERT): N/A
DATE: 3/31/14

**CARSON CITY
PUBLIC WORKS DEPARTMENT**
3505 BUTTI WAY CARSON CITY, NEVADA 89701
PH: 775-887-2555 FAX: 775-887-2112

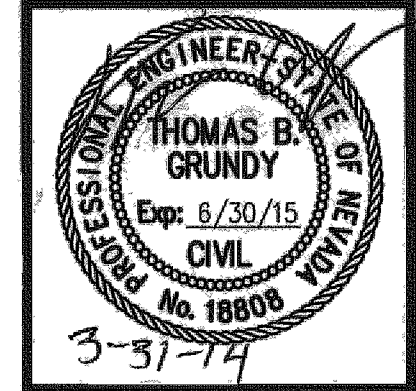

REV.	DATE	DESCRIPTION

**EAST/WEST WATER TRANSMISSION MAIN
PROJECT - PHASE 2A-1
PROJECT No. 4.0900**

GENERAL NOTES

SHEET
G3
OF
31

FOR BIDDING PURPOSE ONLY

IRRIGATION INSPECTIONS/APPROVALS: 10/2000

ALL APPROVALS TO BE BY THE LANDSCAPE ARCHITECT OR THE OWNER'S REPRESENTATIVE.
 CONTRACTOR SHALL SUBMIT RECORD AS-BUILT DRAWINGS TO THE LANDSCAPE ARCHITECT OR THE OWNER'S REPRESENTATIVE FOR IN-FIELD INSPECTION & VERIFICATION.
 THE LANDSCAPE ARCHITECT OR THE OWNER'S REPRESENTATIVE SHALL BE PRESENT FOR THE FOLLOWING TESTS & INSPECTIONS:
 COVERAGE TEST.
 OPEN TRENCH PRESSURE TEST.
 OPEN TRENCH MAINLINE INSPECTION.
 OPEN TRENCH CONTROL WIRE INSPECTION.
 FINAL LOCATION OF IRRIGATION CONTROLLER & VALVE WIRE HOOK-UP.
 LAYOUT OF THE SPRAY SYSTEM/LATERAL LINES & DRIP SYSTEM.
 AUTOMATIC OPERATION OF THE SPRAY HEADS/ DRIP SYSTEM.
 RAINMASTER SYSTEM HOOKUP & PERFORMANCE TEST.
 THE CONTRACTOR SHALL NOTIFY THE LANDSCAPE ARCHITECT OR THE OWNER'S REPRESENTATIVE BEFORE ANY IRRIGATION TRENCHES ARE BACKFILLED FOR INSPECTION. FAILURE TO DO SO WILL RESULT IN THE CONTRACTOR DIGGING UP SELECTED AREAS FOR SPOT CHECKING QUALITY OF WORKMANSHIP AT NO COST TO THE OWNER.
 THE LANDSCAPE ARCHITECT OR THE OWNER'S REPRESENTATIVE SHALL PERFORM A FINAL WALK THROUGH INSPECTION AFTER BEING NOTIFIED BY THE CONTRACTOR OF 100% PROJECT COMPLETION.

LANDSCAPE INSPECTIONS/APPROVALS: 10/2000

ALL APPROVALS TO BE BY THE LANDSCAPE ARCHITECT OR THE OWNER'S REPRESENTATIVE.
 FINISH GRADE OF ALL LAWN AND PLANTING BED AREAS SHALL BE REVIEWED & APPROVED BEFORE INSTALLATION OF EITHER MULCH OR SOD.
 ROUGH GRADE, FINISH GRADE, & ALL BERM LOCATION/SHAPES SHALL BE REVIEWED & APPROVED BEFORE INSTALLATION OF THE IRRIGATION SYSTEM & SITE ELEMENTS.
 THE CONTRACTOR SHALL SUBMIT THE BELOW ITEMS FOR REVIEW & APPROVAL AS REQUIRED BY THE DRAWINGS:
 SOD MIX SEED SPECIFICATIONS
 TREE SELECTION
 TREE PROTECTION PLAN
 WEED FABRIC
 MULCH
 PRE-EMERGENT HERBICIDE

GENERAL IRRIGATION NOTES: 10/2000

- PRIOR TO CONSTRUCTION THE CONTRACTOR SHALL LOCATE AND MARK ALL IRRIGATION MAINLINES, IRRIGATION BOXES, AND SPRAY HEADS WITHIN THE PROJECT AREA, WITH THE ASSISTANCE OF THE CITY PROJECT MANAGER AND CARSON CITY PARKS & RECREATION STAFF.
- THE CONTRACTOR SHALL MAKE EVERY EFFORT TO PROTECT ALL EXISTING IRRIGATION COMPONENTS WITHIN THE PROJECT AREA. IRRIGATION MAINLINES WITH CONTROLLER WIRES SHALL NOT BE COMPROMISED, DAMAGED OR BROKEN DUE TO CONSTRUCTION ACTIVITIES.
- THE CONTRACTOR SHALL REPAIR ANY DAMAGES TO THE IRRIGATION SYSTEM, INCLUDING BLOWING OUT ANY DIRT OR DEBRIS FROM OTHER PARTS OF THE IRRIGATION SYSTEM WITHIN A 24 HOUR PERIOD SHOULD A BREAK OCCUR.
- ALL PLUMBING AND ELECTRICAL WORK SHALL BE COMPLETED AS PER ALL LOCAL CODES.
- INSTALLATION OF MATERIALS SHALL BE PER MANUFACTURERS RECOMMENDATIONS OR AS SPECIFIED. SPRINKLER HEADS ARE EXACT. NO EXTRA PAYMENT WILL BE MADE WHERE PIPING MUST BE OFFSET TO AVOID EXISTING CONDITIONS, OTHER WORK OR WHERE CHANGES ARE NECESSARY TO FACILITATE INSTALLATION.
- ALL MATERIALS SHALL BE NEW, WITHOUT FLAWS AND CONSIDERED THE BEST AVAILABLE IN STOCK. THE COMPLETE SYSTEM SHALL HAVE A ONE-YEAR WARRANTY AFTER FINAL PROJECT ACCEPTANCE ON ALL PARTS AND LABOR.
- THE CONTRACTOR SHALL PROVIDE AND KEEP CURRENT A COMPLETE SET OF RECORD DRAWINGS WHICH SHALL BE CORRECTED DAILY TO SHOW CHANGES IN THE ORIGINAL DRAWINGS. ALL MAINLINE PIPING AND VALVE LOCATIONS SHALL BE SHOWN WITH ACTUAL MEASUREMENTS TO REFERENCE POINTS. THESE DRAWINGS SHALL BE SUBMITTED TO THE PARKS AND RECREATION DEPARTMENT PRIOR TO FINAL PAYMENT.
- WHEN THE SYSTEM IS COMPLETE, THE CONTRACTOR SHALL PERFORM A COVERAGE TEST. THE IRRIGATION SYSTEM SHALL PROVIDE 100% COVERAGE OF ALL LAWN & LANDSCAPE PLANTING BED AREAS.
- ALL IRRIGATION MAINLINE PIPING & LATERAL PIPING SHALL BE SCHEDULE 40 PVC PIPE.
- THE CONTRACTOR SHALL BE RESPONSIBLE FOR ANY SETTLING IN THE IRRIGATION TRENCHES OR ASSOCIATED IRRIGATION WORK AS A WARRANTY ITEM.
- ON ALL THREADED JOINTS WITHIN THE IRRIGATION SYSTEM, THE CONTRACTOR SHALL USE 2-3 FULL TURNS OF TEFLON TAPE AND TEFLON PASTE AT EACH CONNECTION.
- PIPE DOPE SHALL NOT BE USED ANYWHERE ON THE IRRIGATION SYSTEM.
- RAINBIRD PEN-TITE OR KINGWIRE SPLICE WIRE CONNECTORS SHALL BE USED ON ALL FIELD WIRE SPLICES AND CONNECTIONS.
- ALL CONTROL WIRE SHALL BEAR A U/A APPROVED LABEL FOR DIRECT UNDERGROUND BURIAL IN NATIONAL ELECTRIC CODE CLASS IT CIRCUITS. AWG SIZES: MINIMUM SIZE #12. ALL CONTROL WIRE RUNS LESS THAN 1000' SHALL HAVE NO SPLICES. IF A SPLICE OCCURS ON A FIELD CONTROL WIRE, THE CONTRACTOR SHALL INSTALL THE SPLICE IN A 6" ROUND VALVE BOX, IF APPROVED BY THE LANDSCAPE ARCHITECT. OTHERWISE THE ENTIRE FIELD CONTROL WIRE SHALL BE REMOVED & REPLACED.
- TAPE AND BUNDLE ALL CONTROL WIRE TO BOTTOM OF MAINLINE PIPE AT 10' O.C.
- IRRIGATION MAINLINE TO BE BURIED 24" BELOW FINISHED GRADE AND ALL LATERAL LINE PIPING TO BE BURIED 18" BELOW FINISHED GRADE. ALL 3/4" DRIP IRRIGATION TUBING TO BE BURIED 4" - 6" BELOW FINISH GRADE.
- NO 3/4" PIPE SHALL BE USED ANYWHERE ON THE IRRIGATION SYSTEM. (EXCEPT FOR 3" SWING JOINT ASSEMBLIES FOR POP-UP SPRAY HEADS).
- THE CONTRACTOR SHALL EXPOSE ENDS OF ALL IRRIGATION SLEEVES, ANY BROKEN OR SHATTERED ENDS OF THE IRRIGATION SLEEVES SHALL BE CUT TO A CLEAN END BEFORE INSTALLATION OF EITHER MAINLINE PIPE, LATERAL LINES OR DRIP IRRIGATION TUBING. ALL SLEEVE ENDS SHALL BE INSPECTED BY PARKS & RECREATION DEPT. STAFF BEFORE BURYING.
- THE CONTRACTOR IS RESPONSIBLE FOR LOCATING ALL UNDERGROUND UTILITIES WHICH MAY EFFECT HIS OPERATION DURING CONSTRUCTION AND SHALL TAKE ALL NECESSARY PRECAUTIONS TO AVOID DAMAGE TO THE SAME.
- THE CONTRACTOR SHALL USE EXTREME CAUTION WHEN WORKING NEAR OVERHEAD OR UNDERGROUND POWER AND/OR TELEPHONE, WATER, GAS AND SEWER FACILITIES SO AS TO SAFELY PROTECT ALL UTILITIES, PERSONNEL, AND EQUIPMENT, AND SHALL BE RESPONSIBLE FOR ALL COSTS AND LIABILITY IN CONNECTION THEREWITH.
- THE CONTRACTOR SHALL TAKE ALL PRECAUTIONARY MEASURES NECESSARY TO PROTECT EXISTING IMPROVEMENTS WHICH ARE TO REMAIN IN PLACE, FROM DAMAGE, AND ALL SUCH IMPROVEMENTS DAMAGED BY THE CONTRACTOR'S OPERATIONS SHALL BE REPAIRED OR RECONSTRUCTED TO THE OWNER'S SATISFACTION AT THE CONTRACTOR'S EXPENSE.
- ALL MAINLINES SHALL BE PRESSURE TESTED AT 1.5 TIMES THE STATIC PRESSURE FOR A MINIMUM 2 HOUR PERIOD PRIOR TO BACKFILLING OF TRENCHES. TEST WILL BE CONSIDERED SUCCESSFUL IF NO PRESSURE LOSS OCCURS DURING THE TWO HOURS. IF ANY LEAKS ARE PRESENT THEY SHALL BE CORRECTED AND LINES SHALL BE RE-TESTED PRIOR TO BACKFILLING TRENCHES.

GENERAL LANDSCAPE NOTES: 10/2000

- ALL LAWN AREAS SHALL BE CONTOURED AND ROLLED WITH A WEIGHTED HAND ROLLER PRIOR TO SODDING OPERATIONS.
- THE CONTRACTOR IS RESPONSIBLE FOR LOCATING ALL UNDERGROUND UTILITIES PRIOR TO ANY DIGGING OR CONSTRUCTION. THE ACQUISITION OF ALL NECESSARY PERMITS ASSOCIATED WITH CONSTRUCTION SHALL BE THE CONTRACTOR'S RESPONSIBILITY.
- THE CONTRACTOR SHALL FURNISH ALL LABOR, MATERIALS, EQUIPMENT AND SERVICES NECESSARY TO INSTALL ALL MATERIALS COMPLETE AND IN PLACE AS SHOWN AND/OR SPECIFIED.
- FINISH GRADES IN ALL LAWN AREAS SHALL BE ESTABLISHED AND INSPECTED BY CITY PROJECT MANAGER BEFORE INSTALLATION OF SOD.
- ROUGH GRADE AND FINISH GRADE SHALL BE ESTABLISHED BY THE CONTRACTOR AND APPROVED BY THE CITY PROJECT MANAGER BEFORE INSTALLATION OF THE IRRIGATION SYSTEM, SITE ELEMENTS OR ANY SOD.
- SOIL AMENDMENTS SHALL BE INCORPORATED INTO THE TOP 6"-8" (MIN.) OF THE ROUGH GRADE OF ALL LAWN AREAS PRIOR TO SODDING.
- ROUGH GRADE IN ALL LAWN AND PLANTING BED AREAS SHALL BE SCARIFIED TO A MINIMUM DEPTH OF 8"-10" (MIN.) PRIOR TO INSTALLATION OF PLANT MATERIAL, BERMS & SOD.
- SOIL AMENDMENTS SHALL BE INCORPORATED INTO THE TOP 6"-8" (MIN.) OF THE ROUGH GRADE OF ALL LAWN AREAS PRIOR TO SODDING.
- ROUGH GRADE IN ALL LAWN AND PLANTING BED AREAS SHALL BE SCARIFIED TO A MINIMUM DEPTH OF 8"-10" (MIN.) PRIOR TO INSTALLATION OF PLANT MATERIAL, BERMS & SOD.
- ALL SOD AND PLANT MATERIALS SHALL BE #1 GRADE NURSERY STOCK AND WARRANTED FOR ONE YEAR AFTER FINAL PROJECT ACCEPTANCE. REPLACE ANY PLANT WHICH DIES WITHIN TWO WEEKS WITH PLANTS EQUAL TO ORIGINAL MATERIALS USED EXCEPT FOR PLANT LOSSES DUE TO VANDALISM, ACTS OF NATURE, OR NEGLIGENCE BY THE OWNER.
- THE CONTRACTOR SHALL BE REQUIRED TO EXCAVATE ALL LAWN & PLANTING BED AREAS TO ESTABLISH ROUGH GRADE AND INSTALL REQUIRED SOIL AMENDMENTS (4 1/2" BELOW TOP OF CURBS IN PLANTING AREAS & 1 1/2" BELOW SIDEWALKS IN LAWN AREAS.)
- ANY IMPORTED TOPSOIL REQUIRED FOR INSTALLATION OF THE BERMS OR ESTABLISHMENT OF ROUGH GRADE OR FINISH GRADE SHALL BE NEVADA ORGANIC PREMIUM TOPSOIL MIX OR AN APPROVED EQUAL.
- TREE STAKING SHALL BE DONE ON ALL TREES. CONTRACTOR SHALL STAKE AS PER DETAIL. ORIGINAL NURSERY STAKES ON TREES SHALL BE REMOVED BEFORE INSTALLATION. TREES MUST STAND UPRIGHT WITHOUT SUPPORT TO ORIGINAL MATERIALS USED EXCEPT FOR PLANT LOSSES DUE TO VANDALISM, ACTS OF NATURE, OR NEGLIGENCE BY THE OWNER.
- INSTALL DEWITT PRO 5 LANDSCAPE FABRIC OR AN APPROVED EQUAL UNDER ALL MULCH AREAS. SECURE TO ROUGH GRADE. DO NOT LEAVE EXPOSED.
- ROCK MULCH SHALL BE A 3"-8" CLEAN RIVER COBBLE. MULCH DEPTH TO BE 4"-6" MIN. AND TO BE INSTALLED IN ALL PLANTING AREAS AND OVER ALL BERMS.
- ALL PLANTING PITS SHALL BE EITHER HAND OR BACKHOE DUG (NO AUGER). THE BOTTOM AND SIDES OF THE PLANTING PITS SHALL BE SCARIFIED BEFORE INSTALLATION OF THE PLANT MATERIAL. HOLES SHALL BE 3 TIMES AS WIDE AS THE ROOTBALL DIAMETER, THE SAME DEPTH AS THE ROOTBALL AND BACKFILLED WITH AN APPROVED SOIL MIX.
- ALL PLANTING BEDS AND SOD AREAS SHALL BE STRIPPED AND CLEARED OF ALL LAWN, ROOTS, WEEDS, AND DEBRIS AND SHALL BE RAKED TO A SMOOTH AND EVEN GRADE PRIOR TO PLANT MATERIAL OR SOD INSTALLATION.
- "L.B.D.U." WATER SOLUBLE STARTER PLANT FERTILIZER BAGS/TABLETS OR AN APPROVED EQUAL SHALL BE INSTALLED IN ALL PLANTING PITS. USE 1 PER 1-GALLON CONTAINER, 3 PER 5-GALLON CONTAINER, AND 5 PER 15-GALLON CONTAINER/ 2" CAL. OR LARGER TREE.
- CONTRACTOR TO APPLY A PRE-EMERGENT HERBICIDE THROUGHOUT ALL ROCK MULCH AREAS PRIOR TO PLACING MULCH. NO PRE-EMERGENT HERBICIDE SHALL BE APPLIED IN PERENNIAL, GROUNDCOVER, BULB AND ANNUAL AREAS. ADD RONSTAR GRANULAR PRE-EMERGENT HERBICIDE PER MANUFACTURER'S WRITTEN RECOMMENDATIONS PRIOR TO INSTALLING WEED FABRIC AND ROCK MULCH.
- FINAL LOCATION OF ALL LANDSCAPE PLANT MATERIAL SHALL BE SET BY THE CONTRACTOR AND APPROVED BY THE CITY PROJECT MANAGER BEFORE INSTALLATION.
- NO PLANTS SHALL BE PLACED TO CONFLICT OR CREATE CONFLICT W/ SIGNS, LIGHTS, UTILITIES, ETC. IF PLANT LOCATION WILL CAUSE A CONFLICT, CONTACT THE CITY PROJECT MANAGER.
- THE CONTRACTOR SHALL REMOVE ALL BURLAP, TWINE, TIES, CONTAINERS AND WIRE BASKETS FROM ALL PLANT MATERIAL. DO NOT DISTURB ROOTBALLS. REMOVE ANY EXCESS SOIL ON TREES OR SHRUBS THAT HAS ACCUMULATED DURING THE PACKAGING & SHIPPING PROCESS. (B&B STOCK - ESPECIALLY IN ORDER TO DETERMINE PROPER PLANTING DEPTH IN ORDER TO PLACE ROOTBALL AT 1" ABOVE GRADE. CLEAN DOWN TO THE TOP OF STRUCTURAL (FLARED) ROOT SYSTEM.
- ALL TREES TO BE #1 GRADE NURSERY STOCK AND MEET CURRENT INDUSTRY QUALITY STANDARDS ADOPTED BY THE AMERICAN ASSOCIATION OF NURSERMEN, ANSI Z60 AND NRS 555 (REGULATIONS OF NURSERY AND NURSERY STOCK). ALL TREES TO INCLUDE THE FOLLOWING:
 - NO GIRDLING, KINKED, CIRCLING OR "J" ROOTS.
 - NO TREES THAT HAVE BEEN TOPPED.
 - NO WOUNDS IN THE TRUNK BARK OR ON LIMBS.
 - TO BE INSECT AND DISEASE FREE, RODENT AND MECHANICAL DAMAGE FREE.
 - NO TREES THAT HAVE LARGE NURSERY STAKES THROUGH ROOTBALL OR HAVE BEEN GROWN ON A NURSERY STAKE.
 - ROOTBALL TO BE APPROPRIATE TO CALIPER AND CROWN SIZE.
 - TRUNK/ CROWN STRUCTURE AND TRUNK TAPER TO BE APPROPRIATE FOR THE SPECIES.
 - ALL GRAFT UNIONS TO BE HEALTHY WITH TRUNK DIAMETER BELOW UNION LARGER THAN ABOVE UNION.
 - ALL TREES TO STAND UPRIGHT WITHOUT STAKES.
 - ROOTS, BARK AND SHOOT GROWTH TO GIVE EVIDENCE OF GOOD TREE WGOR.
 - ANY REPLACEMENT OF PLANT STOCK TO BE EQUAL TO ORIGINAL SPECIFICATION AND APPROVED BY THE OWNER'S REPRESENTATIVE.
- ALL PLANTING BEDS AND SOD AREAS SHALL HAVE POSITIVE DRAINAGE AWAY FROM ALL BUILDINGS.
- NO BOX TREES TO BE ACCEPTED ON SITE.
- A 48 HR. MIN. NOTICE TO CARSON CITY PARKS AND RECREATION DEPARTMENT (775) 887-2363 REQUIRED FOR PLANT MATERIAL, SPACING, AND LAYOUT REVIEW PRIOR TO PLANTING. A 48 HR. MIN. NOTICE TO THE CARSON CITY URBAN FORESTER (775) 884-1883 TO REVIEW TREES UPON ARRIVAL AT SITE IS REQUIRED.
- THE CONTRACTOR SHALL INSPECT THE SITE REGULARLY TO REVIEW THE CONDITION OF ALL PLANTINGS. IF ANY CHANGES IN THE OVERALL MAINTENANCE PROGRAM ARE REQUIRED TO IMPROVE THE CONDITIONS TO AN ACCEPTABLE STANDARD, THE CONTRACTOR SHALL NOTIFY THE OWNER IN WRITING. OTHERWISE THE CONTRACTOR ACCEPTS FULL RESPONSIBILITY FOR THE CONDITION OF THE PLANTINGS AND MUST HONOR THE GUARANTEE. ANY PLANTS REPLACED UNDER THIS GUARANTEE SHALL BE GUARANTEED FOR ONE FULL YEAR FROM THE DATE OF REPLACEMENT.
- THE CONTRACTOR SHALL BE REQUIRED TO PROVIDE MAINTENANCE OF THE ENTIRE IRRIGATION SYSTEM & ALL LANDSCAPING UNTIL FINAL PROJECT ACCEPTANCE. AFTER FINAL PROJECT ACCEPTANCE ALL PROJECT MAINTENANCE SHALL BE THE RESPONSIBILITY OF THE CARSON CITY PARKS & RECREATION DEPARTMENT.
- THE CONTRACTOR SHALL TOP DRESS ROUGH GRADE OF ALL LAWN AREAS WITH 2" OF NEVADA ORGANIC PREMIUM TOP SOIL MIX. SCARIFY ALL LAWN AREAS INCORPORATING TOP SOIL INTO ROUGH GRADE. AGAIN, TOP DRESS ALL LAWN AREAS WITH AN ADDITIONAL 2" OF NEVADA ORGANIC PREMIUM TOP SOIL MIX TO ESTABLISH FINISH GRADE.
- THE CONTRACTOR WILL ONLY PERFORM TREE ROOT PRUNING IN THE PRESENCE OF THE CITY PROJECT MANAGER OR CARSON CITY PARKS & RECREATION DEPT. STAFF. IF TREE ROOT PRUNING IS PERFORMED AND COVERED UP BY THE CONTRACTOR PRIOR TO CITY STAFF INSPECTION, THE CONTRACTOR AT HIS EXPENSE WILL UNCOVER THE TREE ROOTS FOR INSPECTION, AS DIRECTED BY THE CITY PROJECT MANAGER.

DESIGNED BY: DGR
 DRAWN BY: DGR
 CHECKED BY: TEG
 DRG NO.: 4-8900 ph-26r mls pt bty
 SCALE (HORIZ): N/A
 SCALE (VERT): N/A
 DATE: 3/31/2014

**CARSON CITY
 PUBLIC WORKS DEPARTMENT**
 3505 BUTTI WAY CARSON CITY, NEVADA 89701
 PH: 887-2355 FAX: 887-2112

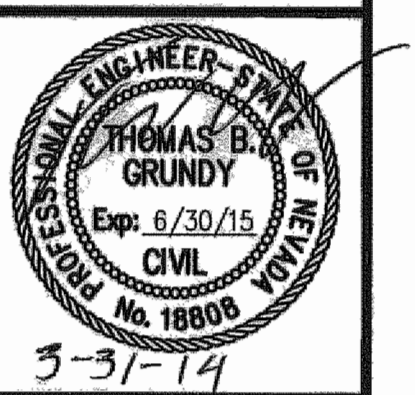

REV.	DATE	DESCRIPTION	BY	APP'D

**EAST/WEST WATER TRANSMISSION MAIN
 PROJECT - PHASE 2A-1
 PROJECT No. 4.0900
 LANDSCAPE & IRRIGATION
 GENERAL NOTES**

SHEET
G4
 OF
31

FOR BIDDING PURPOSE ONLY

4-1900025345000 E-# Transmittal Mch Phase 2/09/09 2A-1/0900-1S PHASE 2A-1.dwg 3/31/14

H:\PROJECTS\65000 E-W Transmission Main Phase 2A\Phase 2A-1\65000-1S PHASE 2A-1.dwg 3/27/14

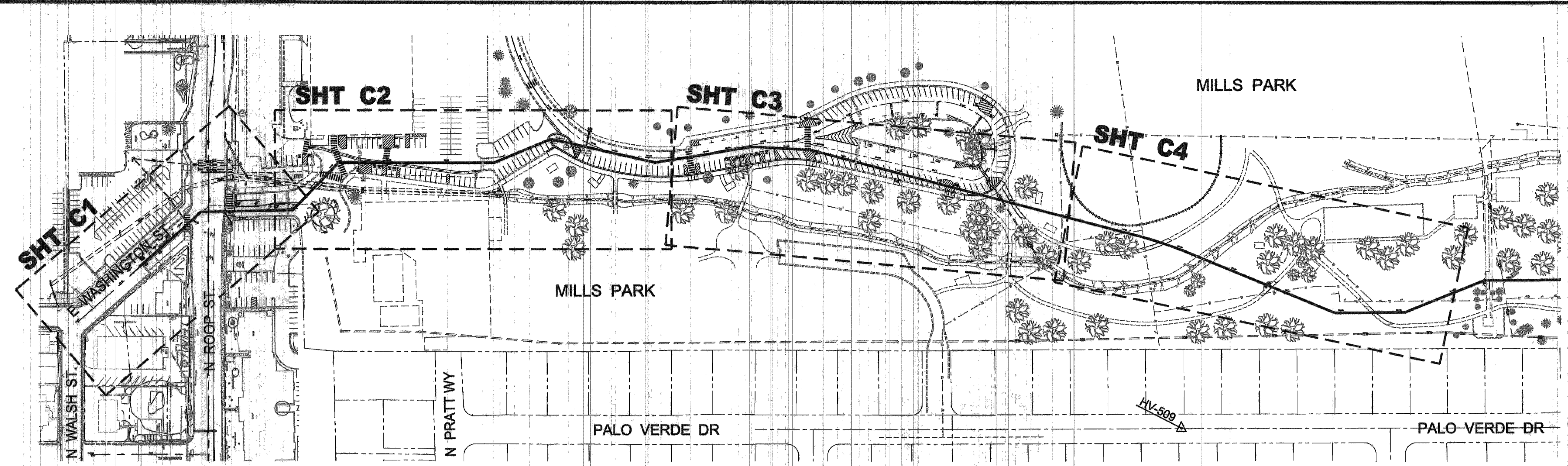

SHEET INDEX
SCALE: 1" = 100'

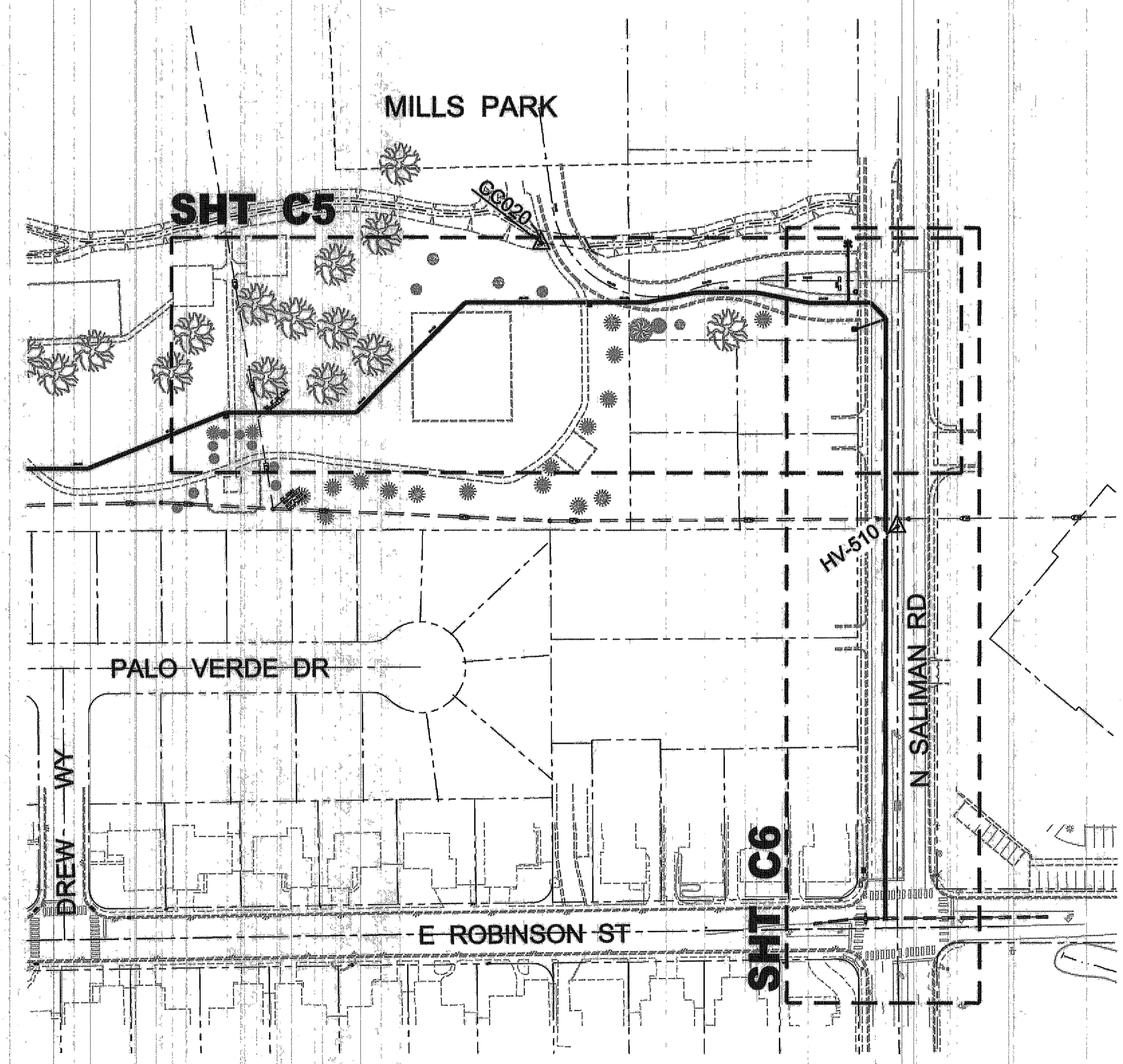

SHEET INDEX
SCALE: 1" = 100'

HORIZONTAL & VERTICAL CONTROL DATA

PT#	NORTHING	EASTING	ELEV.	DESCRIPTION
HV-507	14736803.87	2290504.69	4676.00	PK HV22
HV-508	14736321.20	2291136.45	4667.50	PK HV24
HV-509	14736807.49	2292892.56	4654.86	PK HV277
HV-510	14736928.28	2294085.44	4648.93	PK HV 29
HV-511	14736077.82	2294077.87	4644.86	PK HV30
CC020	14737214.80	2293736.39	4650.45	2" BRASS DISK
CC083	14736339.01	2291156.46	4667.33	2" BRASS DISK

BASIS OF BEARING

NORTH AMERICAN DATUM OF 1983 AS BASED ON FEDERAL BASE NETWORK/COOPERATIVE BASE NETWORK OBSERVATIONS IN 1994 (AKA NAD83/94), NEVADA STATE PLANE WEST ZONE AS DETERMINED WITH REAL TIME KINEMATIC (RTK) GPS OBSERVATIONS MADE BETWEEN FEBRUARY 2-12, 2010 WITH CORRECTIONS TRANSMITTED BY THE REGIONAL BASE NETWORK CONTINUOUSLY OPERATING REFERENCE STATION (CORS) DOT1. GROUND COORDINATES HEREON REFLECT GRID COORDINATES MULTIPLIED BY A COMBINED GRID TO GROUND FACTOR OF 1.0002 (AKA CARSON CITY MODIFIED).

BASIS OF ELEVATION

BASIS OF ELEVATION FOR THIS PROJECT IS CARSON CITY SURVEY CONTROL MONUMENT CC083, WHICH IS A 2" BRASS DISK STAMPED "CC083 2010" LOCATED IN THE TOP OF CURB ALONG THE NORTH SIDE OF EAST SPEAR STREET, APPROXIMATELY 12' WEST OF THE SOUTH RETURN OF THE NORTHWEST CORNER OF THE INTERSECTION OF EAST SPEAR ST. AND NORTH ROOP STREET.

NOTE:
THE CONTRACTOR SHALL BE HELD RESPONSIBLE TO REPLACE IN KIND ALL EXISTING SURVEY CONTROL MARKERS WHICH ARE DAMAGED OR DISTURBED DUE TO HIS CONSTRUCTION EFFORTS. RE-ESTABLISHMENT OF SURVEY CONTROL MARKERS SHALL BE COMPLETED BY A NEVADA LICENSED PROFESSIONAL LAND SURVEYOR.



DESIGNED BY: DGR
 DRAWN BY: DGR
 CHECKED BY: TBG
 DWG NO.: 45900-1S PHASE 2A-1
 SCALE (HORIZ): 1" = 100'
 SCALE (VERT): N/A
 DATE: 3/31/14

**CARSON CITY
PUBLIC WORKS DEPARTMENT**
 3505 BUTTI WAY CARSON CITY, NEVADA 89701
 PH: 775-887-2355 FAX: 775-887-2112

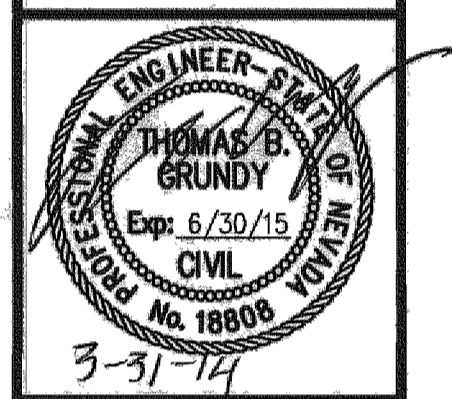

REV.	DATE	DESCRIPTION	BY	APP'D

**EAST/WEST WATER TRANSMISSION MAIN
PROJECT - PHASE 2A-1
PROJECT No. 4-0900**
**SHEET INDEX /
SURVEY CONTROL PLAN**

SHEET
G5
 OF
31

FOR BIDDING PURPOSE ONLY

PROJECT: 4.0900 - E-W Transmission Main Phase 2A-1 (1800 PH-2A) MILLS PARK ST. 3/27/2014

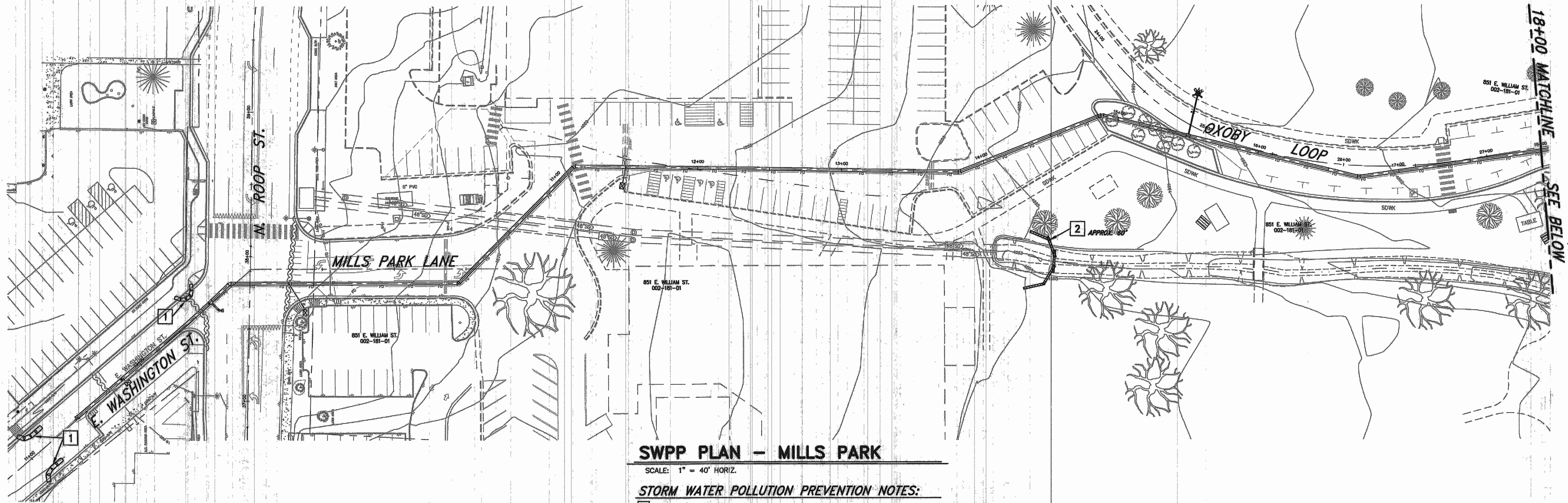

SWPP PLAN - MILLS PARK

SCALE: 1" = 40' HORIZ.

STORM WATER POLLUTION PREVENTION NOTES:

- 1 INSTALL STORM DRAIN INLET PROTECTION PER STD. DWG C-4.1.7
- 2 INSTALL FIBER ROLL CHECK DAM PARALLEL TO WORK AREA PER DETAIL 2, SHEET G7.

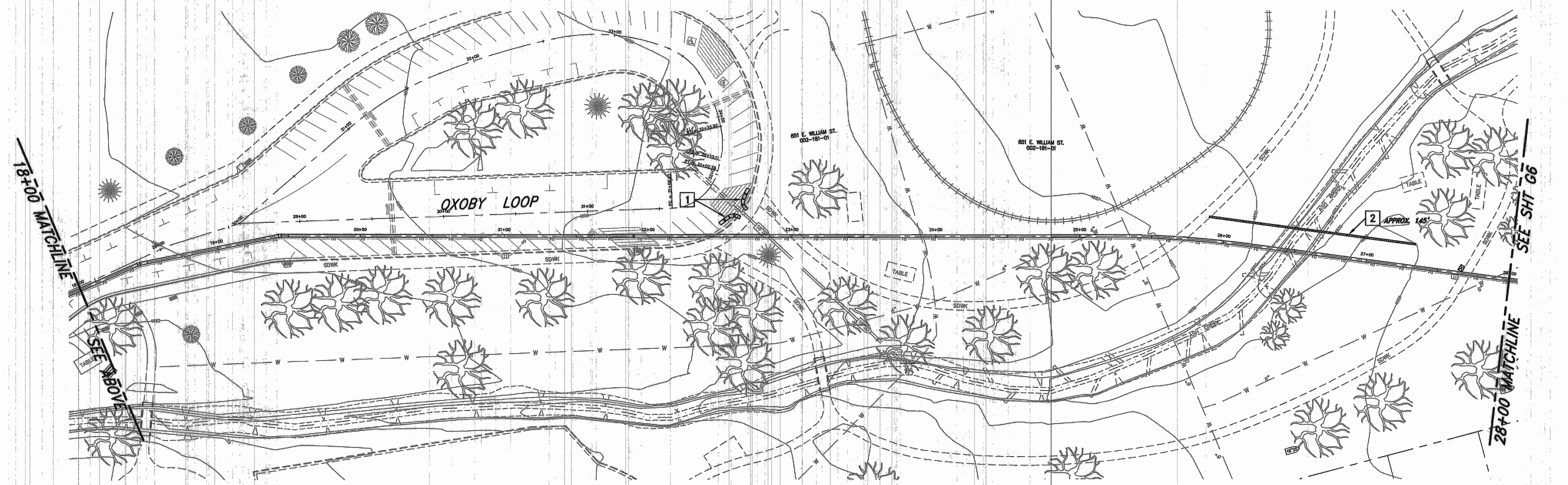

SWPP PLAN - MILLS PARK

SCALE: 1" = 40' HORIZ.

STORM WATER POLLUTION PREVENTION NOTES:

- 1 INSTALL STORM DRAIN INLET PROTECTION AT ALL EXISTING AND INSTALLED CURB INLETS AND CATCH BASINS, PER STD. DRAWING C-4.1.7.
- 2 INSTALL FIBER ROLL CHECK DAM PARALLEL TO WORK AREA PER DETAIL 2, SHEET G7.

THE CONTRACTOR SHALL INSTALL AND MAINTAIN STORM WATER PROTECTION DEVICES IN ACCORDANCE WITH THE "NEVADA CONTRACTORS FIELD GUIDE FOR CONSTRUCTION SITE BEST MANAGEMENT PRACTICES" TO PROTECT THE NEAREST WATERWAY DOWNSTREAM OF ALL CONSTRUCTION ACTIVITIES.

24 HOUR EMERGENCY CONTACT:

NAME: _____ NUMBER: _____

DESIGNED BY: DGR
 DRAWN BY: DGR
 CHECKED BY: TBG
 DWG NO.: 4-0900 PH-2A MILLS PARK
 SCALE (HORIZ): 1" = 40'
 SCALE (VERT): NA
 DATE: 3/31/2014

**CARSON CITY DEPARTMENT
 PUBLIC WORKS DEPARTMENT**
 3505 BUTTI WAY CARSON CITY, NEVADA 89701
 PH: 867-2355 FAX: 867-2112

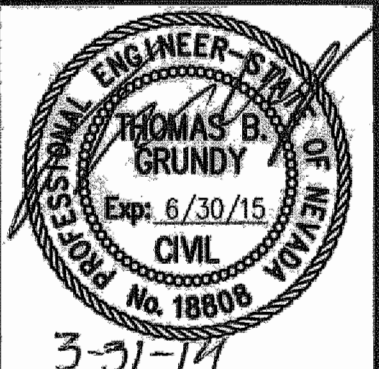

REV.	DATE	DESCRIPTION	BY	APP'D

**EAST-WEST WATER TRANSMISSION MAIN
 PROJECT PHASE 2A-1
 PROJECT No. 4.0900
 STORM WATER
 POLLUTION PREVENTION PLAN**

SHEET
G6
 OF
31

FOR BIDDING PURPOSE ONLY

H:\PROJECTS\4.0900 E-W Transmission Main Phase 2\DWG\4-0900 PH-2A1 MILLS\SWPP.dwg 3/21/2014

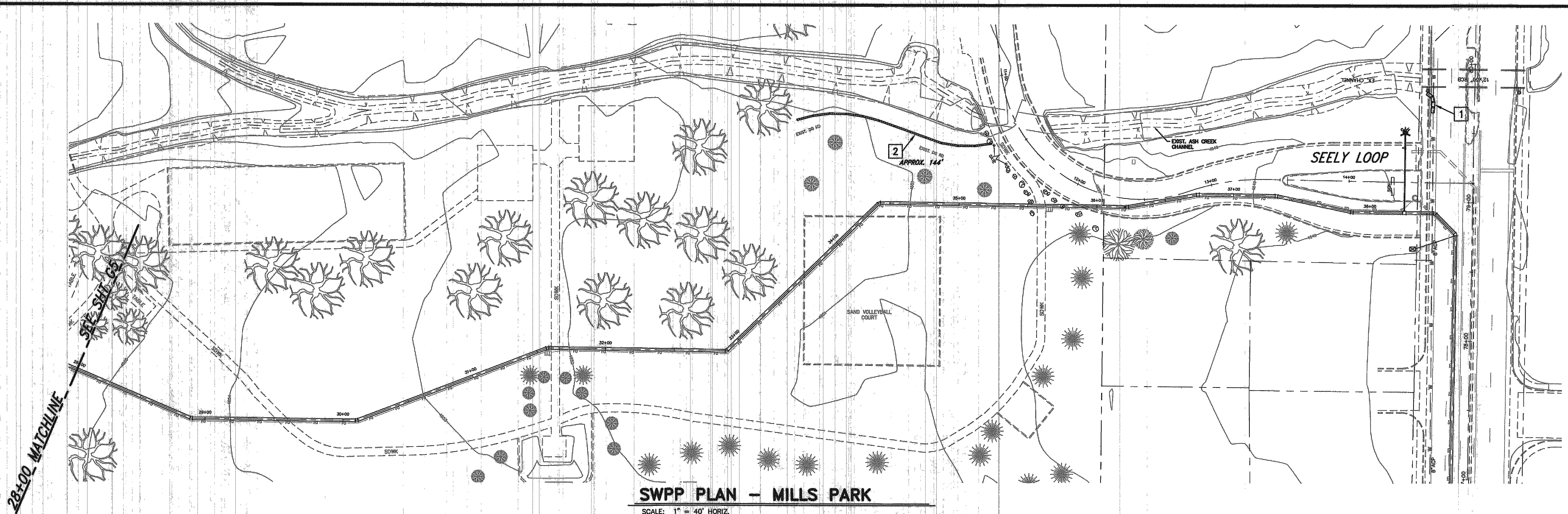

SWPP PLAN - MILLS PARK

SCALE: 1" = 40' HORIZ.

STORM WATER POLLUTION PREVENTION NOTES:

- 1 INSTALL STORM DRAIN INLET PROTECTION PER STD. DWG C-4.1.7
- 2 INSTALL FIBER ROLL CHECK DAM PARALLEL TO WORK AREA PER DETAIL 2, SHEET G7.

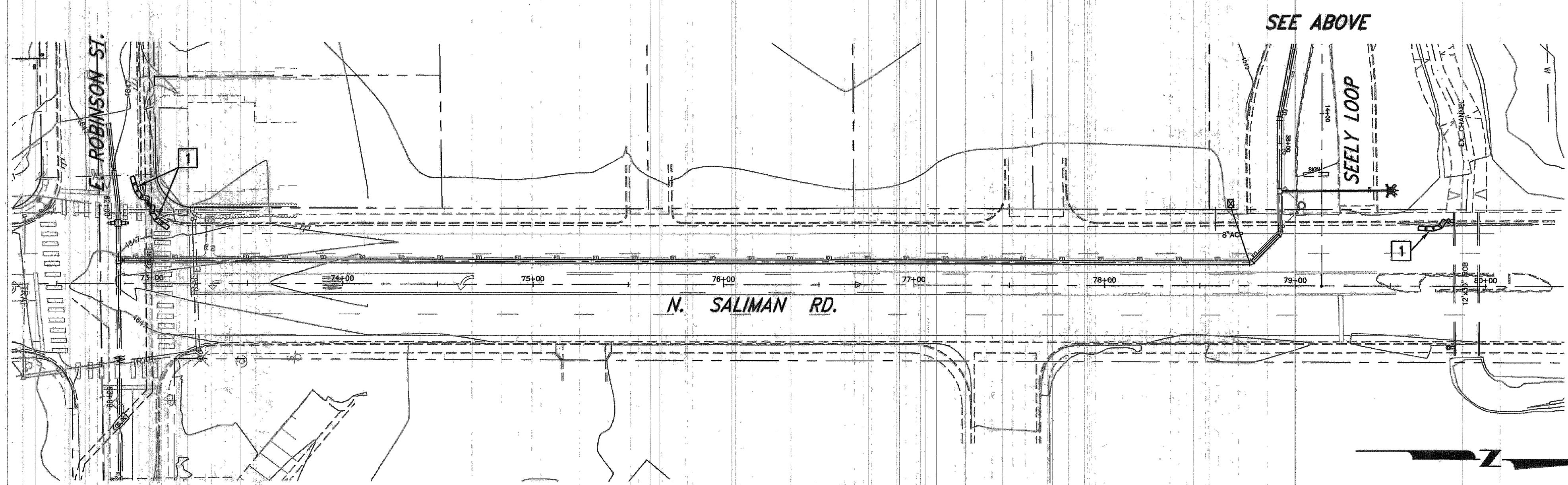
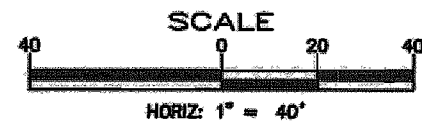

SWPP PLAN - SALIMAN RD.

SCALE: 1" = 40' HORIZ.

STORM WATER POLLUTION PREVENTION NOTES:

- 1 INSTALL STORM DRAIN INLET PROTECTION PER STD. DWG C-4.1.7
- 2 INSTALL FIBER ROLL CHECK DAM PARALLEL TO WORK AREA PER DETAIL 2, SHEET G7.

DESIGNED BY: DGR
 DRAWN BY: DGR
 CHECKED BY: JBG
 DWG NO.: 4-0900 PH-2A1 MILLS
 SCALE (HORIZ): 1"=40'
 SCALE (VERT): NA
 DATE: 3/21/2014

**CARSON CITY
 PUBLIC WORKS DEPARTMENT**
 3505 BUTTI WAY CARSON CITY, NEVADA 89701
 PH: 887-2355 FAX: 887-2112

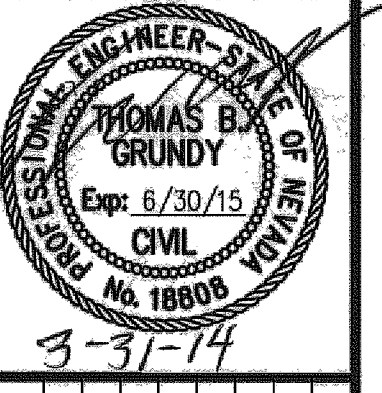

REV.	DATE	DESCRIPTION	BY	APP'D

**EAST-WEST WATER TRANSMISSION MAIN
 PROJECT PHASE 2A-1
 PROJECT No. 4.0900
 STORM WATER
 POLLUTION PREVENTION PLAN**

SHEET
G7
 OF
31

FOR BIDDING PURPOSE ONLY

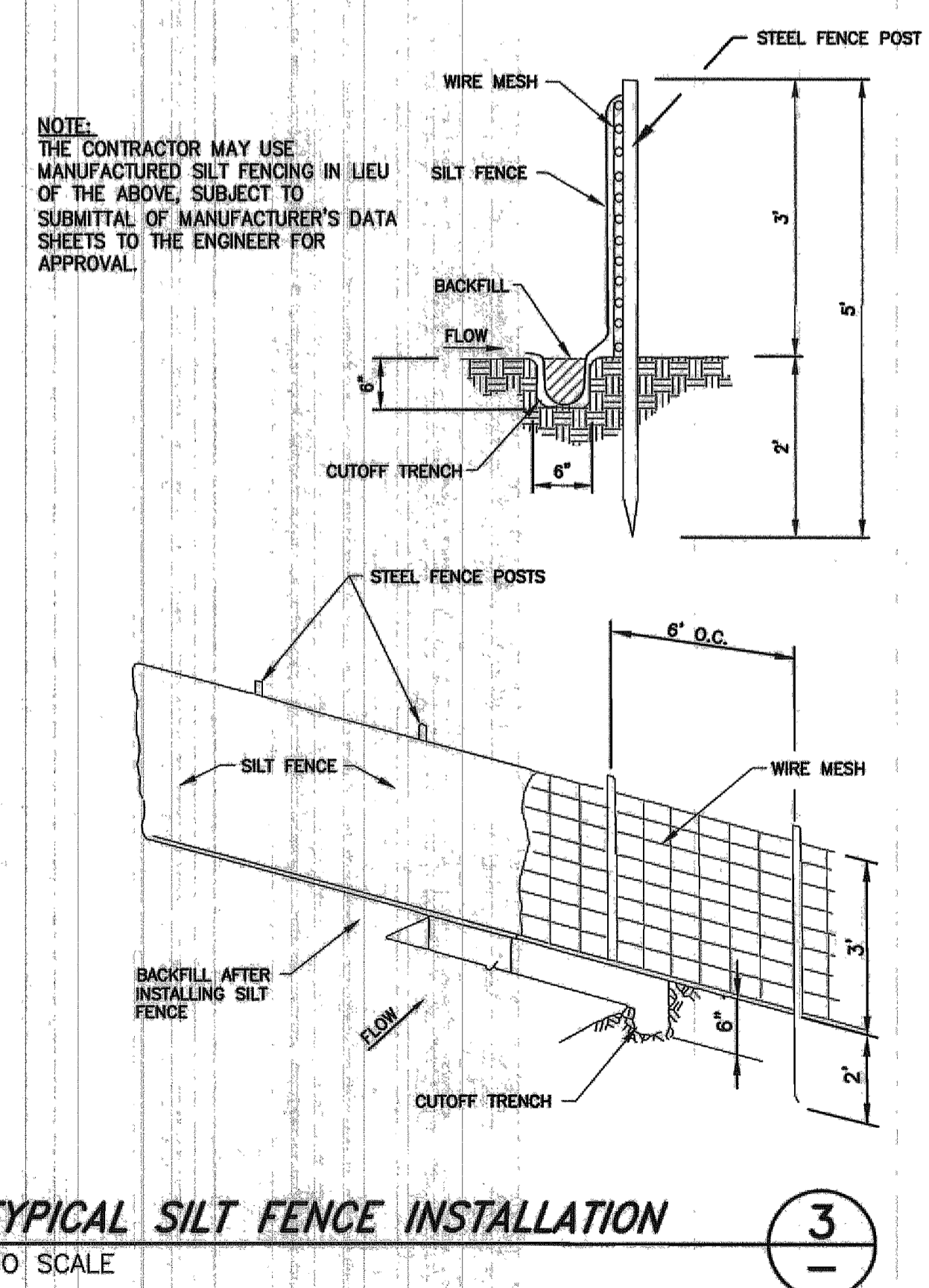
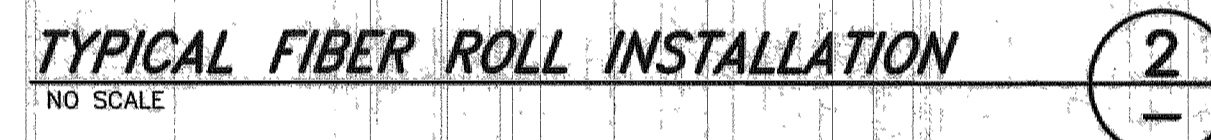
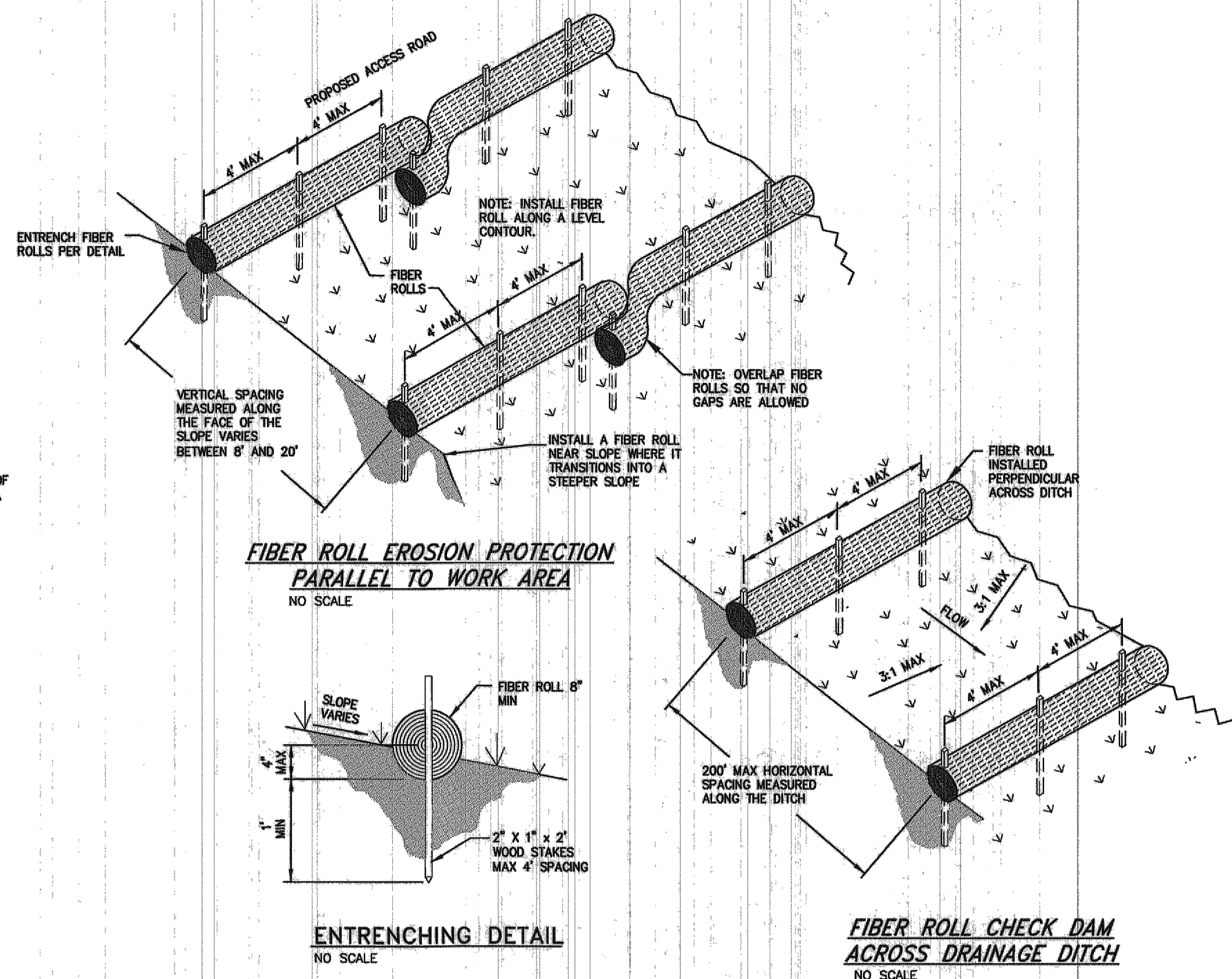
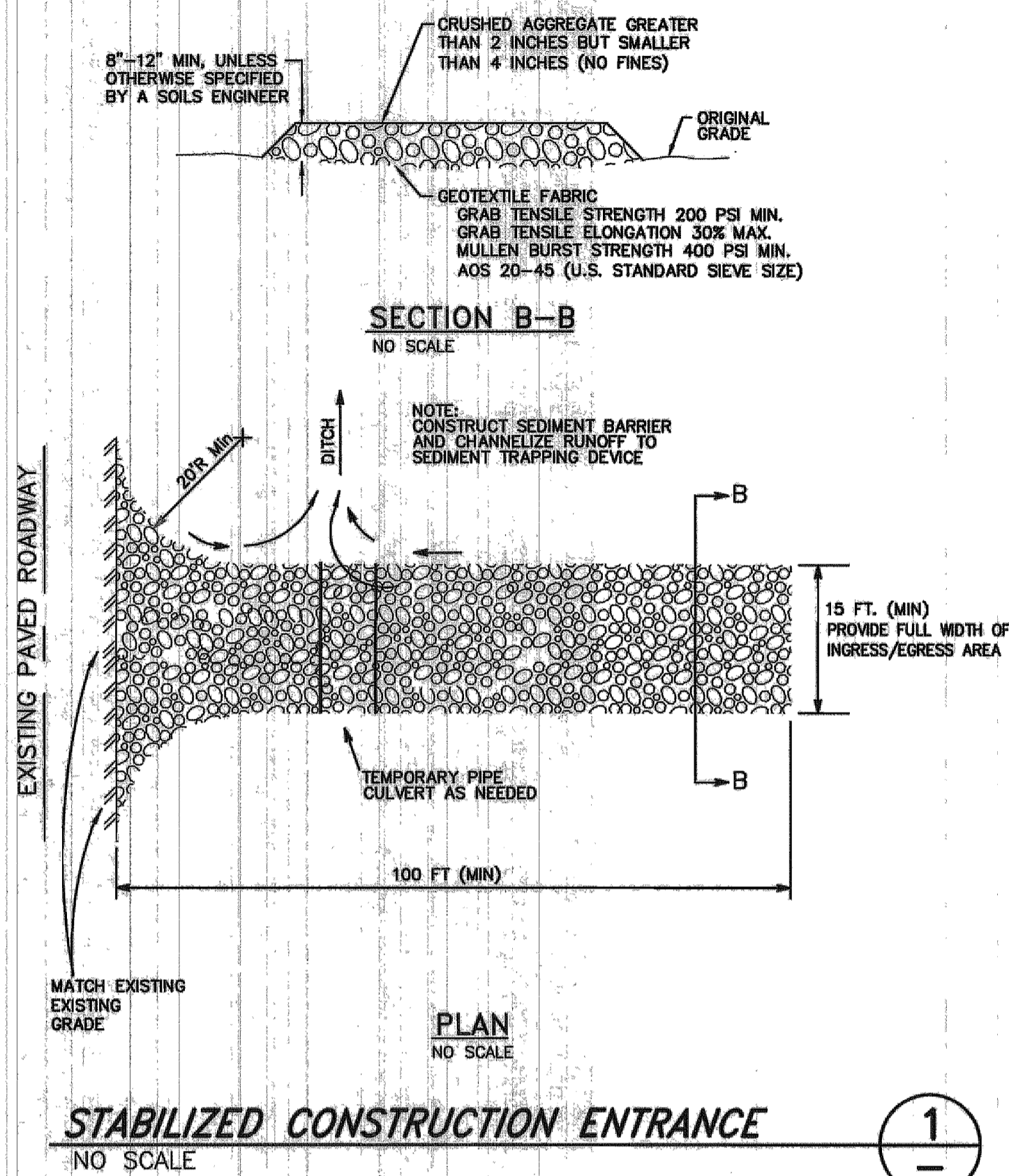

- STORMWATER PROTECTION NOTES:**
- PRIOR TO ANY CONSTRUCTION ACTIVITY, THE CONTRACTOR SHALL INSTALL AND MAINTAIN ALL STORM WATER PROTECTION DEVICES IN ACCORDANCE WITH THE "NEVADA CONTRACTORS FIELD GUIDE FOR CONSTRUCTION SITE BEST MANAGEMENT PRACTICES" AND DETAILS AS SHOWN.
 - ALL INSTALLED PROTECTION DEVICES SHALL BE INSPECTED AND APPROVED BY THE CARSON CITY CONSTRUCTION INSPECTOR PRIOR TO ANY CONSTRUCTION ACTIVITY.
 - BMP'S IN ADDITION TO THOSE INDICATED ON PLAN SHEETS G6 THROUGH G12, AND THE CONTRACTOR'S SWPPP MAY BE REQUIRED IF THEY DON'T MEET LOCAL PERFORMANCE STANDARDS.
 - ALL BMP'S MUST BE INSPECTED WEEKLY, PRIOR TO FORECASTED RAIN EVENTS, AND WITHIN 24 HOURS AFTER ANY EVENT THAT CREATES RUNOFF AT THE SITE.
 - ACCUMULATED SEDIMENT MUST BE REMOVED FROM BMP'S WHEN THE DESIGN CAPACITY HAS BEEN REDUCED BY 50 PERCENT OR MORE. SEDIMENT MUST ALSO BE REMOVED WITHIN SEVEN DAYS AFTER A RUNOFF EVENT OR PRIOR TO THE NEXT FORECASTED RAIN EVENT WHICHEVER IS EARLIER.
 - IF THE ENTRANCE STABILIZATION IS NOT PREVENTING SEDIMENT FROM BEING TRACKED ONTO PAVEMENT, ALTERNATIVE MEASURES TO KEEP THE STREETS FREE OF SEDIMENT SHALL BE USED. THIS MAY INCLUDE STREET SWEEPING, AN INCREASE IN THE DIMENSIONS OF THE ENTRANCE, OR THE INSTALLATION OF A WHEEL WASH.
 - ANY ROCK THAT IS LOOSEENED FROM THE ENTRANCE STABILIZATION PAD, WHICH END UP ON THE PAVED ROADWAY SHALL BE REMOVED IMMEDIATELY.
 - CONTRACTOR SHALL INSPECT LOCAL ROADS ADJACENT TO THE SITE DAILY, SWEEP OR VACUUM TO REMOVE ANY VISIBLE ACCUMULATED SEDIMENT.
 - ANY SEDIMENT THAT IS TRACKED ONTO PAVEMENT SHALL BE REMOVED BY SHOVELING, STREET SWEEPING OR VACUUMING. THE SEDIMENT COLLECTED BY SWEEPING SHALL BE REMOVED OR STABILIZED ON SITE. THE PAVEMENT SHALL NOT BE CLEANED BY WASHING DOWN THE STREET, EXCEPT WHEN SWEEPING IS INEFFECTIVE AND THERE IS A THREAT TO PUBLIC SAFETY. IF IT IS NECESSARY TO WASH THE STREETS, THE CONSTRUCTION OF A SMALL SUMP SHALL BE CONSIDERED. THE SEDIMENT WOULD THEN BE WASHED INTO THE SUMP WHERE IT CAN BE CONTROLLED.
 - CONTRACTOR SHALL BE RESPONSIBLE FOR MAINTAINING DUST CONTROL WITHIN THE CONSTRUCTION LIMITS AT ALL TIMES.
 - STORM DRAIN INLET PROTECTION SHALL BE PLACED ACCORDINGLY ON THE NEAREST INLETS DOWNSTREAM OF ALL CONSTRUCTION ACTIVITIES.
 - HIGH VISIBILITY ORANGE SILT FENCE SHALL BE INSTALLED PER THE DETAILS SHOWN HEREON, AND MAINTAINED THROUGH OUT THE PROJECT.
 - THE CONTRACTOR OR HIS QUALIFIED AGENT IS REQUIRED TO ROUTINELY INSPECT ALL AREAS OF DISTURBED AND BARE SOIL, AREAS USED FOR STORAGE OF MATERIALS AND EQUIPMENT THAT ARE EXPOSED TO PRECIPITATION, ONSITE VEHICLE ENTRANCE AND EXIT LOCATIONS AND ALL ONSITE EROSION AND SEDIMENT CONTROL BMP'S.

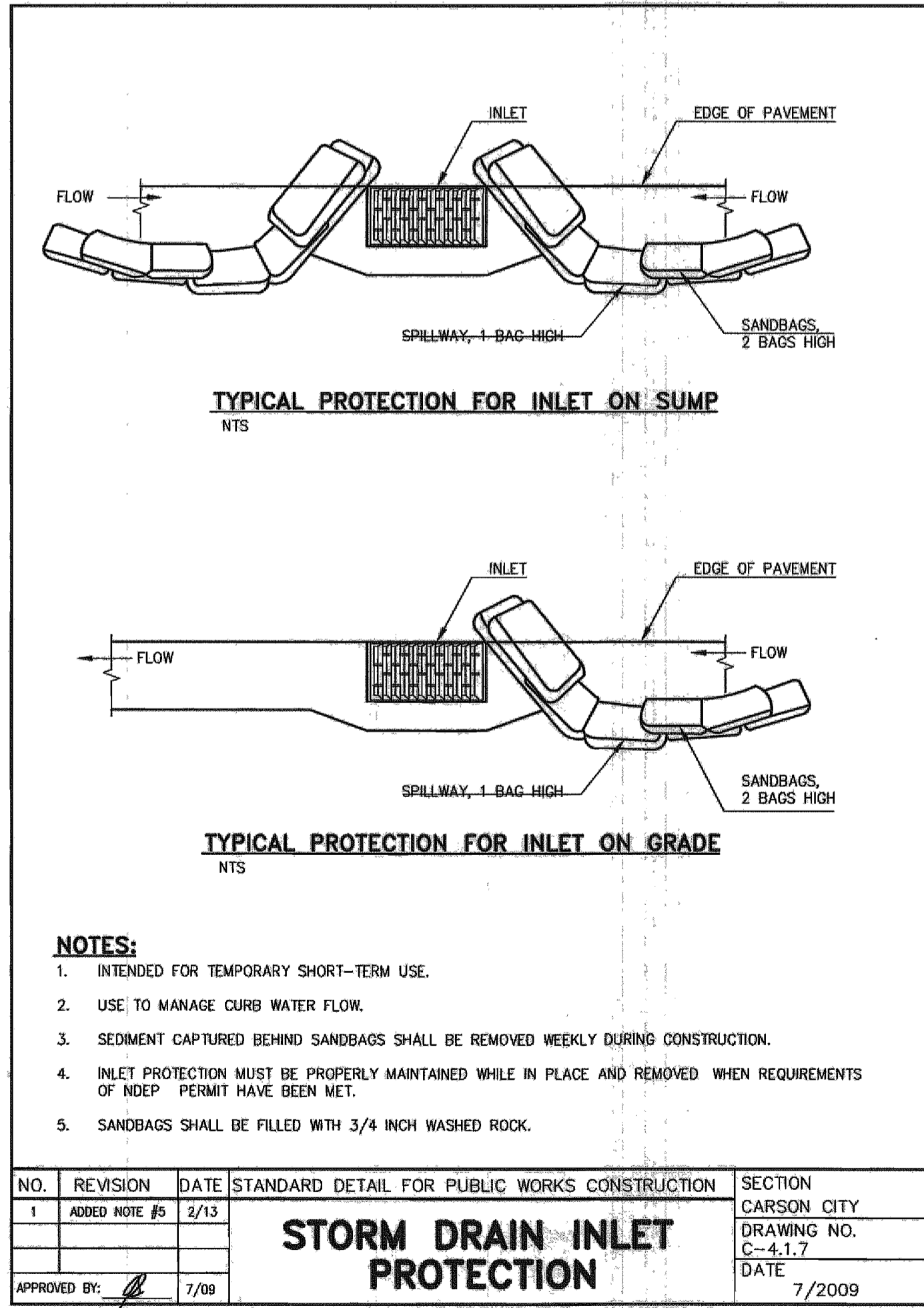

NO.	REVISION	DATE	STANDARD DETAIL FOR PUBLIC WORKS CONSTRUCTION	SECTION
1	ADDED NOTE #0	2/13		CARSON CITY
				DRAWING NO. C-4.1.7
				DATE 7/2009

APPROVED BY: [Signature] 7/09

STORM DRAIN INLET PROTECTION

DESIGNED BY: DGR
DRAWN BY: DGR
CHECKED BY: TEG
DWG NO.: 4-090 PH-2A MILLSPRING
SCALE (HORIZ): N/A
SCALE (VERT): N/A
DATE: 3/31/2014

CARSON CITY PUBLIC WORKS DEPARTMENT

3505 BUTTI WAY CARSON CITY, NEVADA 89701
PH: 887-2355 FAX: 887-2112

REGISTERED ENGINEER - CIVIL
THOMAS B. GRUNDY
Exp: 6/30/15
No. 18808

3-31-14

REV.	DATE	DESCRIPTION	BY	APP'D

EAST-WEST WATER TRANSMISSION MAIN PROJECT PHASE 2A-1 PROJECT No. 4-0900

STORM WATER POLLUTION PREVENTION PLAN DETAILS

SHEET G8 OF 31

FOR BIDDING PURPOSE ONLY