

PHEASANT DRIVE SEWER MAIN REHABILITATION PROJECT (Fairview Dr. to Latigo Dr.)

**CARSON CITY, NEVADA
PROJECT 051403.1**

BOARD OF SUPERVISORS

Bob Crowell Mayor
Karen Abowd Supervisor
Brad Bonkowski Supervisor
John McKenna Supervisor
Jim Shirk Supervisor
Alan Glover City Clerk

DESIGNED FOR:

CARSON CITY PUBLIC WORKS DEPARTMENT
OPERATIONS DIVISION
3505 BUTTI WAY
CARSON CITY, NV 89701
775-887-2355

GENERAL NOTES:

1. ALL WORK SHALL CONFORM TO THE AMERICAN WATER WORKS ASSOCIATION (AWWA) STANDARDS PER NAC 445A.67145 (1)(a) AND THE "STANDARD SPECIFICATIONS FOR PUBLIC WORKS CONSTRUCTION" (SSPWC) AND THE "STANDARD DETAILS FOR PUBLIC WORKS CONSTRUCTION" (SDPWC) AS ADOPTED BY CARSON CITY. THE CONTRACTOR SHALL OBTAIN A PERMIT FOR PUBLIC WORKS CONSTRUCTION FROM THE CARSON CITY PERMIT CENTER PRIOR TO THE START OF CONSTRUCTION.
2. ALL TRAFFIC CONTROL AND BARRICADING WITHIN THE CARSON CITY RIGHT-OF-WAY SHALL CONFORM TO SECTION 100.33, 332.04 AND 332.05 OF THE STANDARD SPECIFICATIONS, PART VI OF THE MANUAL ON UNIFORM TRAFFIC CONTROL DEVICES, LATEST EDITION, AND THE UMR 12 CENTER, TEMPORARY TRAFFIC CONTROL GUIDELINES LATEST EDITION. A TRAFFIC CONTROL PLAN MUST BE SUBMITTED AND APPROVED BY THE CARSON CITY ENGINEERING DIVISION PRIOR TO ANY STREET CLOSURES.
3. THE CONTRACTOR SHALL CALL UNDERGROUND SERVICE ALERT "CALL BEFORE YOU DIG" (811) OR (1-800-227-2600) AT LEAST TWO (2) WORKING DAYS PRIOR TO START OF CONSTRUCTION AND COMPLY WITH THE REQUIREMENTS OF NRS AND NAC 455 THROUGHOUT THE COURSE OF THE WORK, SEWER SERVICE LATERALS ARE NOT OWNED OR MARKED BY CARSON CITY.
4. THE CONTRACTOR SHALL CALL THE CARSON CITY ENGINEERING DIVISION (887-2300) TWO (2) WORKING DAYS PRIOR TO THE START OF CONSTRUCTION. THE CONTRACTOR SHALL CALL ONE (1) WORKING DAY PRIOR TO REQUIRED INSPECTIONS AND TESTING. THE REQUIRED INSPECTIONS AND TESTING ARE LISTED ON THE INSPECTION RECORD ISSUED WITH EACH PERMIT. THE CONTRACTOR MUST HAVE THE PERMIT NUMBER AND THE DESCRIPTION LISTED ON THE INSPECTION RECORD TO SCHEDULE REQUIRED INSPECTIONS AND TESTING. FOR CITY CONTRACTED PROJECTS, THE CONTRACTOR SHALL SCHEDULE INSPECTIONS PER THE CONTRACT DOCUMENTS.
5. FINAL INSPECTIONS WILL BE PERFORMED BY CARSON CITY ENGINEERING DIVISION ACCORDING TO THE CARSON CITY INSPECTIONS AND TESTING PROCEDURES. NOTE: THESE PROCEDURES REQUIRE SUBMITTAL OF RECORD DRAWING PRINTS BY THE CONTRACTOR AND 10 WORKING DAYS TO PREPARE A FINAL PUNCH LIST. ALL CONDITIONS OF THE FINAL INSPECTION MUST BE COMPLETED PRIOR TO FINAL ACCEPTANCE OR ANY APPROVAL OF A CERTIFICATE OF OCCUPANCY BY THE CARSON CITY ENGINEERING DIVISION.
6. MODIFICATIONS TO THE APPROVED PLANS REQUIRES REVIEW AND APPROVAL BY THE CARSON CITY ENGINEERING DIVISION. WORK PERFORMED WITHOUT WRITTEN APPROVAL BY CARSON CITY ENGINEERING WILL REQUIRE REMOVAL AT THE CONTRACTORS EXPENSE.
7. THE APPROVED PLAN, PERMIT AND INSPECTION RECORD MUST BE ON THE JOB SITE AT ALL TIMES.
8. PLAN APPROVAL FOR SEWER AND WATER CONSTRUCTION SHALL EXPIRE ONE YEAR FROM DATE OF APPROVAL UNLESS CONSTRUCTION HAS BEEN INITIATED. (CCMC 12.06.180F, 12.01.140D)
9. THE CONTRACTOR WILL BE SOLELY AND COMPLETELY RESPONSIBLE FOR ACQUIRING A STORMWATER DISCHARGE PERMIT FROM THE NEVADA DIVISION OF ENVIRONMENTAL PROTECTION (NDEP) INCLUDING DEVELOPING, SUBMITTING AND IMPLEMENTING A STORM WATER POLLUTION PREVENTION PLAN (SWPPP). THE CONTRACTOR SHALL DEVELOP, PLACE AND MAINTAIN STORM WATER PROTECTION DEVICES IN COMPLIANCE WITH THE NEVADA CONTRACTORS FIELD GUIDE FOR CONSTRUCTION SITE BEST MANAGEMENT PRACTICES (JUNE 2008).
10. THE LOCATION OF EXISTING UTILITIES SHOWN ON THESE DRAWINGS IS BASED ON THE BEST INFORMATION AVAILABLE TO THE ENGINEER. IT SHALL BE THE CONTRACTORS' RESPONSIBILITY TO VERIFY THESE LOCATIONS AT THE PROPOSED POINTS OF CONNECTIONS AND IN AREAS OF POSSIBLE CONFLICT WITH NEW UTILITY INSTALLATION, PRIOR TO BEGINNING CONSTRUCTION. POTHOLES IS REQUIRED. SHOULD THE CONTRACTOR FIND ANY DISCREPANCIES BETWEEN THE CONDITIONS EXISTING IN THE FIELD AND THE INFORMATION SHOWN ON THESE DRAWINGS, HE SHALL NOTIFY THE ENGINEER BEFORE PROCEEDING WITH CONSTRUCTION.
11. THE CONTRACTOR WILL BE SOLELY AND COMPLETELY RESPONSIBLE FOR THE CONDITIONS OF THE JOB SITE, INCLUDING SAFETY OF ALL PERSONS AND PROPERTY DURING PERFORMANCE OF THE WORK. THIS REQUIREMENT WILL APPLY CONTINUOUSLY AND NOT BE LIMITED TO NORMAL WORKING HOURS. THE CONTRACTOR SHALL BE RESPONSIBLE FOR THE DESIGN AND CONSTRUCTION OF PROPER SHORING OF TRENCHES IN ACCORDANCE WITH OCCUPATIONAL SAFETY LAWS. THE DUTIES OF THE ENGINEER DO NOT INCLUDE REVIEW OF THE ADEQUACY OF THE CONTRACTOR'S SAFETY IN, ON, OR NEAR THE CONSTRUCTION SITE.
12. SHOULD IT APPEAR THAT THE WORK TO BE DONE, OR ANY MATTER RELATIVE THERETO, IS NOT SUFFICIENTLY DETAILED OR EXPLAINED ON THESE PLANS, THE CONTRACTOR SHALL CONTACT THE ENGINEER FOR SUCH FURTHER EXPLANATIONS AS MAY BE NECESSARY.
13. ALL PVC WATER PIPELINES SHALL BE PRESSURE TESTED IN ACCORDANCE WITH AWWA STANDARD C605 PER NAC 445A.67145 (7)(b) PRIOR TO BEING FLUSHED, DISINFECTED OR SAMPLED FOR AN ANALYSIS OF WATER QUALITY. ALL PVC WATER PIPELINES ARE TO BE DISINFECTED ACCORDING TO AWWA STANDARD C851 PER NAC 445A.67145 (6)(a).

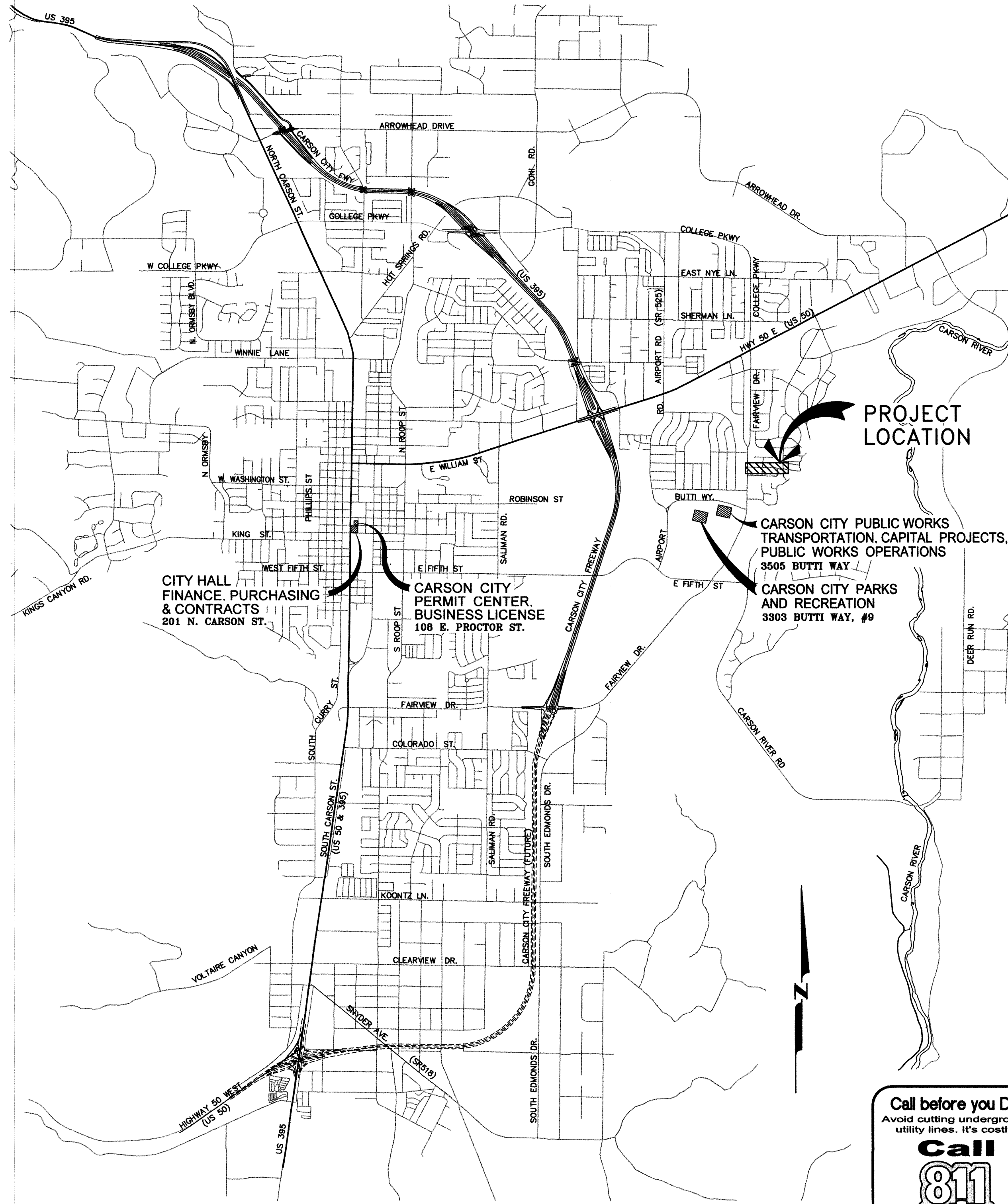

VICINITY MAP
N.T.S.

SHEET INDEX

- G1 TITLE SHEET
- C1 PHEASANT DR. - PLAN & PROFILE
STA 10+00 to STA 17+00
- C2 PHEASANT DR. - PLAN & PROFILE
STA ~~10+00 to STA 17+00~~
17+00 to STA 21+00

ABBREVIATIONS

- APPROX. APPROXIMATE
- CONC CONCRETE
- EXIST EXISTING
- HORIZ HORIZONTAL
- HYD HYDRANT
- IE INVERT ELEVATION
- LAT LATERAL
- LT LEFT
- MH MANHOLE
- MIN MINIMUM
- RT RIGHT
- S SLOPE
- SDWK SIDEWALK
- SS SANITARY SEWER
- SSMH SANITARY SEWER MANHOLE
- STA STATION
- TYP TYPICAL
- VERT VERTICAL
- W WATER
- WV WATER VALVE

REVIEWED FOR CITY REQUIREMENTS:

DARREN SCHULZ, P.E. - PUBLIC WORKS DIRECTOR DATE



DESIGNED BY: DGR/DA
DRAWN BY: DGR
CHECKED BY: DA/TBG
DWC NO.: 051403.1-Pheasant1S
SCALE (HORIZ): N/A
SCALE (VERT): N/A
DATE: 5/28/14

**CARSON CITY DEPARTMENT
PUBLIC WORKS DEPARTMENT**

3505 BUTTI WAY CARSON CITY, NEVADA 89701
PH: 775-887-2355 FAX: 775-887-2355

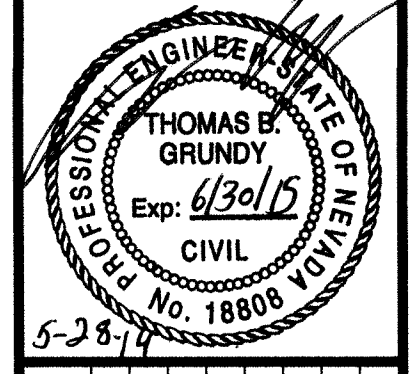

REV.	DATE	DESCRIPTION	BY	APP'D

**PHEASANT DRIVE
SEWER MAIN REHABILITATION PROJECT
PROJECT No. 051403.1**

TITLE SHEET

SHEET
G1
OF
3

APPLICATION NO. _____

FOR BIDDING PURPOSE ONLY

DESIGNED BY: DGR/DA
 DRAWN BY: DGR
 CHECKED BY: DA/TG
 DWG NO.: PHEASANT.DWG
 SCALE (HORIZ): 1" = 30'
 SCALE (VERT): 1" = 3'
 PLOT DATE: 4/28/14

**CARSON CITY
 PUBLIC WORKS DEPARTMENT**
 3505 BUTTI WAY CARSON CITY, NEVADA 89701
 PH: 775-887-2355 FAX: 775-887-2112

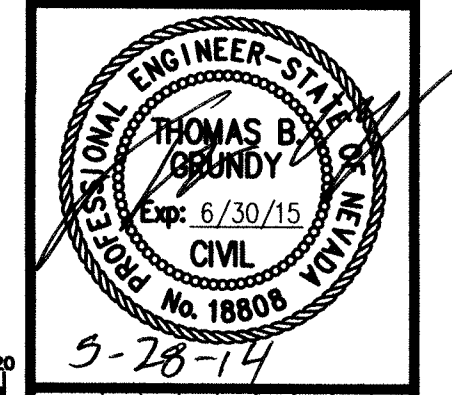

REV.	DATE	DESCRIPTION

**PHEASANT DRIVE
 SEWER MAIN REHABILITATION PROJECT**
 PROJECT NO. 051403.1
**PHEASANT DRIVE
 PLAN & PROFILE**
 STA 10+00 to STA 17+00

SHEET
01
 OF
3

FOR BIDDING PURPOSES ONLY

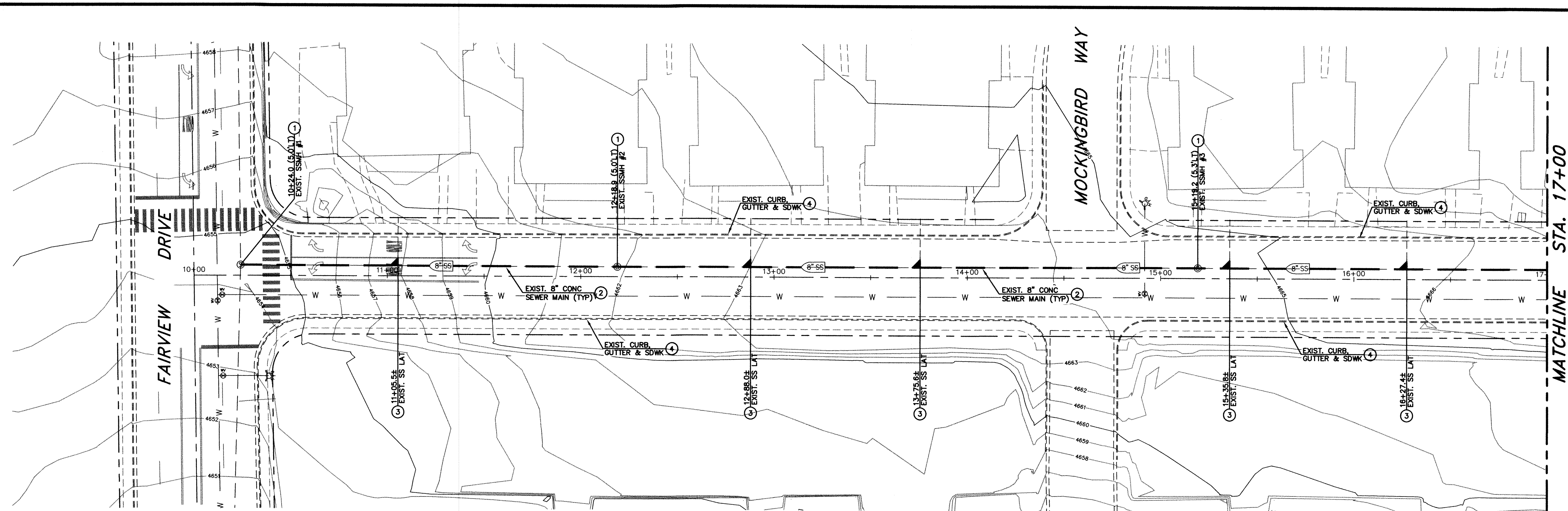

PLAN - PHEASANT DRIVE

SCALE: 1" = 20'

NOTES:

1. THE SEWER FLOW IN THE PHEASANT DRIVE 8" SEWER MAIN IS LIMITED TO THE INFLOW FROM THE SEWER LATERALS SHOWN ON THE PLAN. CONTRACTOR TO VERIFY PRIOR TO CONSTRUCTION.
2. CONTRACTOR TO NOTIFY TODD MITCHELL (CARSON CITY SEWER SUPERVISOR) AT 721-0372, 48 HOURS PRIOR TO CONSTRUCTION.

CONSTRUCTION NOTES:

1. EXISTING SEWER MANHOLE (PROTECT-IN-PLACE) INSTALL LINER THROUGH MANHOLE TROUGH AND CUT OUT TOP TO MATCH EXISTING MANHOLE BASE.
2. INSTALL TRENCHLESS LINER SYSTEM INSIDE EXISTING CONCRETE SEWER MAIN PER MANUFACTURERS RECOMMENDATIONS.
3. EXISTING SEWER LATERAL SERVICE, CONNECT TO TRENCHLESS LINER SYSTEM WITH A LATERAL CONNECTION SEAL, PER DETAIL 1, SHEET 02.
4. PROTECT-IN-PLACE

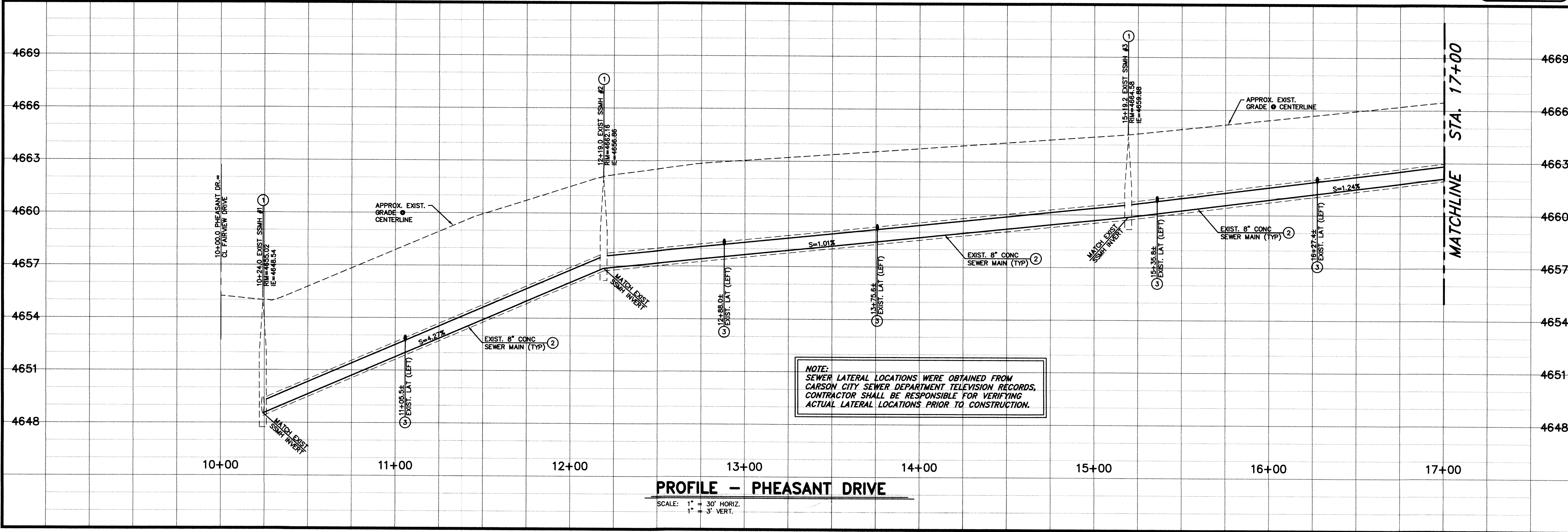
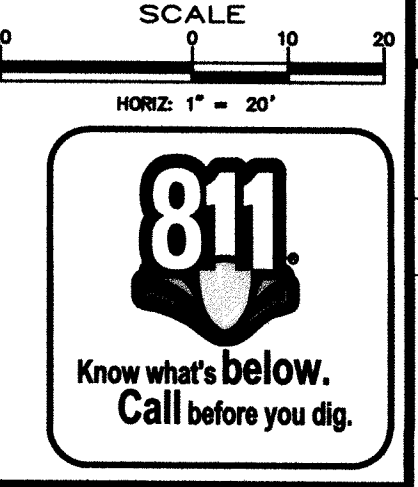

PROFILE - PHEASANT DRIVE

SCALE: 1" = 30' HORIZ.
 1" = 3' VERT.

I:\CAPITAL PROJECTS\Project\051403.1-Pheasant\Drawings\DWG\PHEASANT.dwg 4/28/2014

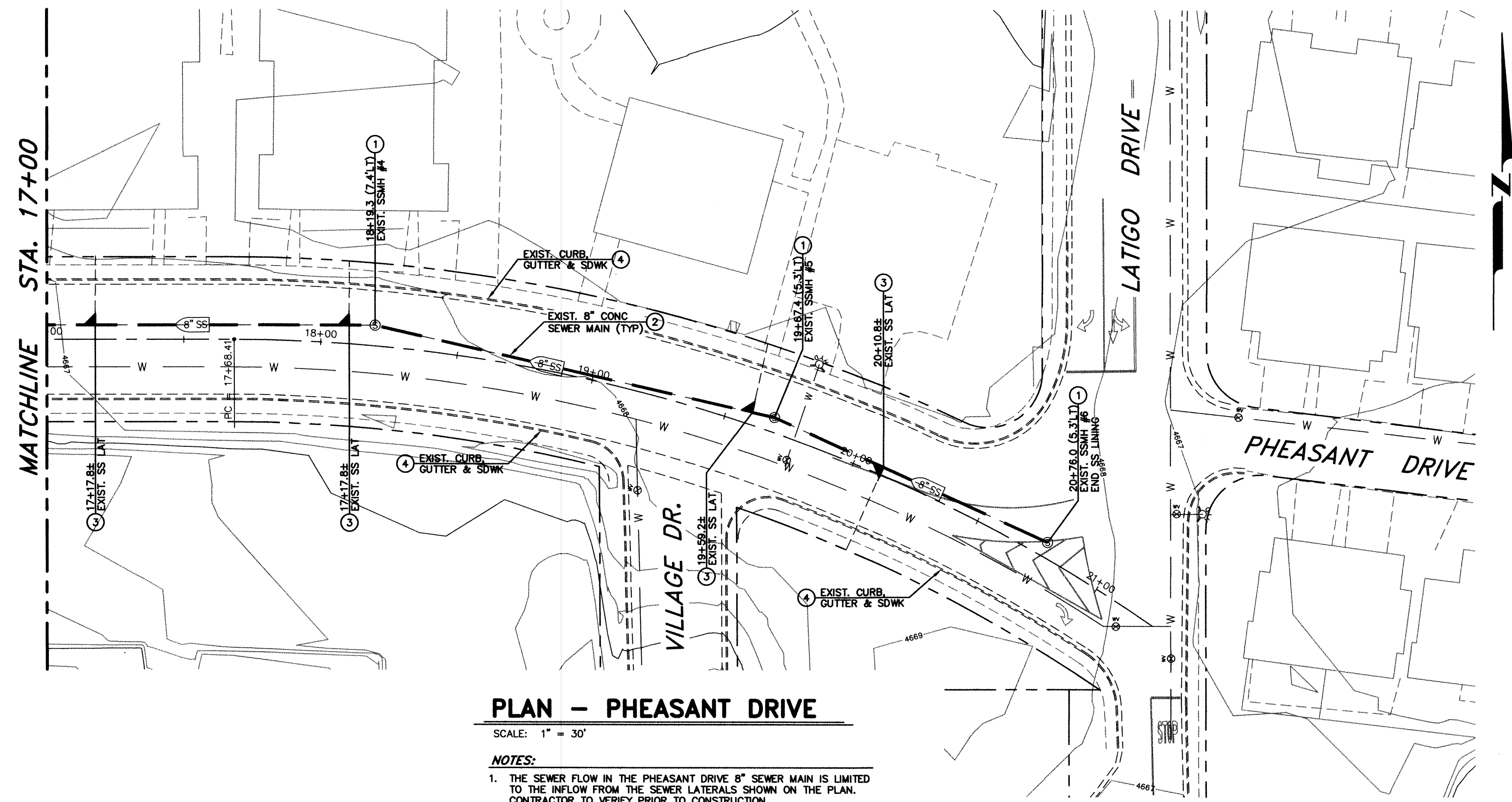

PLAN - PHEASANT DRIVE

SCALE: 1" = 30'

NOTES:

1. THE SEWER FLOW IN THE PHEASANT DRIVE 8" SEWER MAIN IS LIMITED TO THE INFLOW FROM THE SEWER LATERALS SHOWN ON THE PLAN. CONTRACTOR TO VERIFY PRIOR TO CONSTRUCTION.
2. CONTRACTOR TO NOTIFY TODD MITCHELL (CARSON CITY SEWER SUPERVISOR) AT 721-0372, 48 HOURS PRIOR TO CONSTRUCTION.

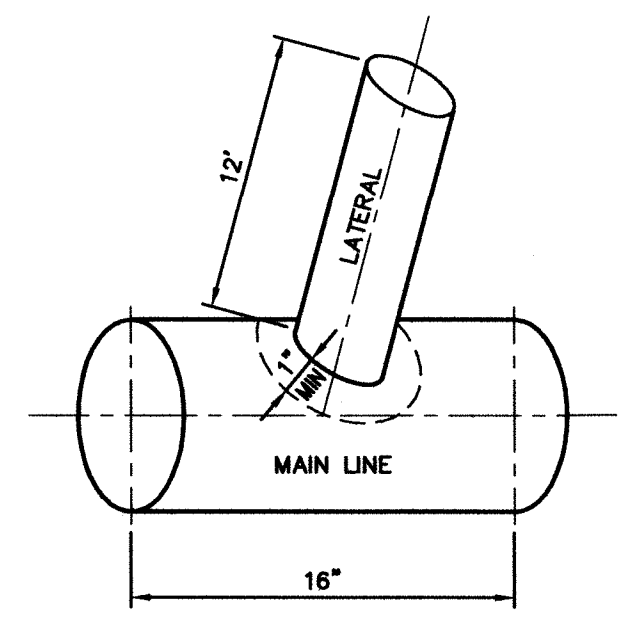

LATERAL CONNECTION SEAL 1

NOT TO SCALE

NOTES:

1. THE SEAL SHALL EXTEND A MINIMUM OF 1" PAST THE LATERAL OPENING ON EITHER SIDE OF THE CONNECTION COUPON.
2. CUT-OUT FOR THE FULL CIRCUMFERENCE OF THE MAIN LINE AND LATERAL LINE.
3. THE LINER MUST HAVE A SMOOTH TRANSITION IN BOTH THE SEWER LATERAL CONNECTION BRANCH AND THE SEWER MAIN.

CONSTRUCTION NOTES:

1. EXISTING SEWER MANHOLE (PROTECT-IN-PLACE) INSTALL LINER THROUGH MANHOLE TROUGH AND CUT OUT TOP TO MATCH EXISTING MANHOLE BASE.
2. INSTALL TRENCHLESS LINER SYSTEM INSIDE EXISTING CONCRETE SEWER MAIN PER MANUFACTURERS RECOMMENDATIONS.
3. EXISTING SEWER LATERAL SERVICE, CONNECT TO TRENCHLESS LINER SYSTEM WITH A LATERAL CONNECTION SEAL, PER DETAIL 1, SHEET C2.
4. PROTECT-IN-PLACE

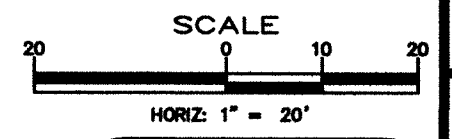

DESIGNED BY: DGB/DA
 DRAWN BY: DGB
 CHECKED BY: DA/TG
 DWG NO.: PHEASANT.DWG
 SCALE (HORIZ): 1"=30'
 SCALE (VERT): 1"=3'
 PLOT DATE: 4/28/14

**CARSON CITY
 PUBLIC WORKS DEPARTMENT**
 3505 BUTTI WAY CARSON CITY, NEVADA 89701
 PH: 775-887-2355 FAX: 775-887-2112

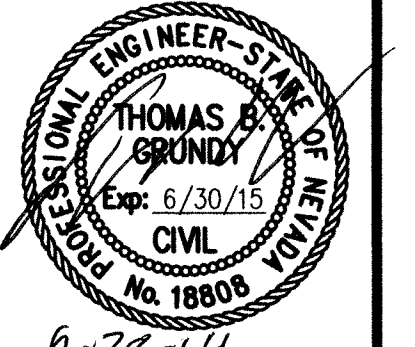

REV.	DATE	DESCRIPTION	BY	APP'D

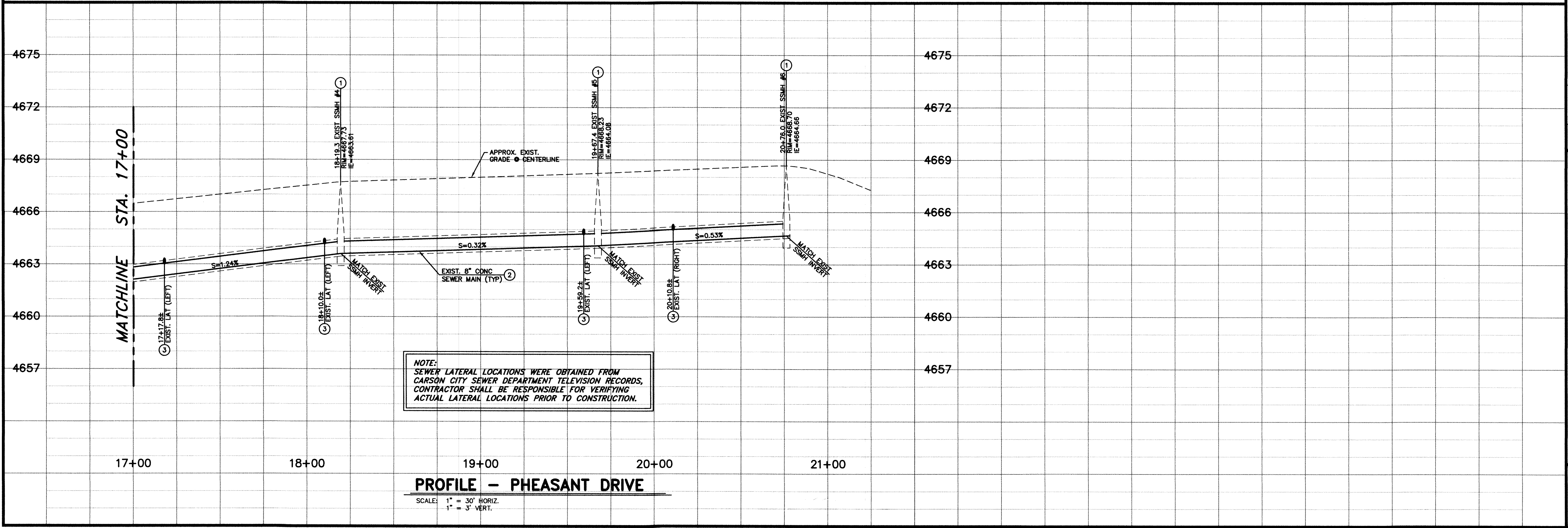

PROFILE - PHEASANT DRIVE

SCALE: 1" = 30' HORIZ.
 1" = 3' VERT.

**PHEASANT DRIVE
 SEWER MAIN REHABILITATION PROJECT
 PROJECT No. 051403.1
 PHEASANT DRIVE
 PLAN & PROFILE
 STA 17+00 to STA 21+00**

SHEET
C2
 OF
3

FOR BIDDING PURPOSES ONLY

\\CAPITAL_PROJECTS\Projects\051403.1_Pheasant\DWG\Profile\Profile.dwg, 4/28/2014