

Is there a fiscal impact? Yes

If yes, account name/number: P303423833 (Gov. Field Maint. Bldg. Replacement)
Capital Projects Fund Capital Improvements Account - 2101005-507010
P303423834 (Gov. Field 3 Announcers Bldg. Replacement)
Capital Projects Fund Capital Improvements Account - 2101005-507010

Is it currently budgeted? Yes

Explanation of Fiscal Impact: Project# P303423833, Account# 2101005-507010 will be reduced by a not to exceed amount of \$205,209.29 and Project # P303423834, Account 2101005-507010 will be reduced by a not to exceed amount of \$63,758.80. The total project budget (Project Number P303423833) for construction is \$225,000; the total project budget (Project Number P303423834) for construction is \$100,000.

Alternatives

Do not approve the purchase and/or provide alternative direction to staff.

Attachments:

[FY23 CXT Quotes.pdf](#)

Board Action Taken:

Motion: _____

- 1) _____
- 2) _____

Aye/Nay

(Vote Recorded By)



State of Nevada
PO #99SWC-NV22-11322



CXT® Precast Concrete Products manufactures restroom, shower and concession buildings in multiple designs, textures and colors. The roof and walls are fabricated with high strength precast concrete to meet all local building codes and textured to match local architectural details. All CXT buildings are designed to meet A.D.A. and to withstand heavy snow, high wind and category E seismic loads. All concrete construction also makes the buildings easy to maintain and withstand the rigors of vandalism. The buildings are prefabricated and delivered complete and ready-to-use, including plumbing and electrical where applicable. With thousands of satisfied customers nationwide, CXT is the leader in prefabricated concrete restrooms.

1. ORDERING ADDRESS(ES): CXT Precast Concrete Products, 606 N. Pines Road, Suite 202, Spokane Valley, WA 99206

2. ORDERING PROCEDURES: Fax 509-928-8270

3. PAYMENT ADDRESS(ES):

Remitting by check:

CXT, Inc., PO Box 676208, Dallas, TX 75267-6208

Remitting by ACH or wire transfer:

Beneficiary: CXT, Inc.

Beneficiary Bank: PNC Bank, Pittsburgh, PA

Account: 1077766885 ABA/Routing: 043000096

Email remittance details to AR@lbfoster.com

4. WARRANTY PROVISIONS: CXT provides a one (1) year warranty. The warranty is valid only when concrete is used within the specified loadings. Furthermore, said warranty includes only the related material necessary for the construction and fabrication of said concrete components. All other non-concrete components will carry a one (1) year warranty. CXT warrants that all goods sold pursuant hereto will, when delivered, conform to specifications set forth above. Goods shall be deemed accepted and meeting specifications unless notice identifying the nature of any non-conformity is provided to CXT in writing within the specified warranty. CXT, at its option, will repair or replace the goods or issue credit for the customer provided CXT is first given the opportunity to inspect such goods. It is specifically understood that CXT's obligation hereunder is for credit, repair or replacement only, F.O.B. CXT's manufacturing plants, and does not include shipping, handling, installation or other incidental or consequential costs unless otherwise agreed to in writing by CXT.

This warranty shall not apply to:

1. Any goods which have been repaired or altered without CXT's express written consent, in such a way as in the reasonable judgment of CXT, to adversely affect the stability or reliability thereof;

2. To any goods which have been subject to misuse, negligence, acts of God or accidents; or

3. To any goods which have not been installed to manufacturer's specifications and guidelines, improperly maintained, or used outside of the specifications for which such goods were designed.

5. TERMS AND CONDITIONS OF INSTALLATION (IF APPLICABLE): All prices subject to the "Conditions of Sale" listed on the CXT quotation form.

Customers are responsible for marking exact location building is to be set; providing clear and level site, free of overhead and/or underground obstructions; and providing site accessible to normal highway trucks and sufficient area for the crane to install and other equipment to perform the contract requirements. Customer shall provide notice in writing of low bridges, roadway width or grade, unimproved roads or any other possible obstacles to access. CXT reserves the right to charge the customer for additional costs incurred for special equipment required to perform delivery and installation. Customers will negotiate installation on a project-

by-project basis, which shall be priced as separate line items. For more information regarding installation and truck turning radius guidelines please see our website at <http://www.cxtinc.com>.

In the event delivery of the building/s ordered is/are not completed within 30 days of the agreed to schedule through no fault of CXT, an invoice for the full contract value (excluding shipping and installation costs) will be submitted for payment. Delivery and installation charges will be invoiced at the time of delivery and installation.

Should the delivery and installation costs increase due to changes in the delivery period, this increase will be added to the price originally quoted, and will be subject to the contract payment terms.

In the event that the delivery is delayed more than 90 days after the agreed to schedule and through no fault of CXT, then in addition to the remedies above, a storage fee of 1-1/2% of contract price per month or any part of any month will be charged.

**Customer is responsible for all local permits and fees.

6. DELIVERY CHARGE: All prices F.O.B. origin prepaid and added to invoice. CXT operates three (3) manufacturing plants in the United States and will deliver from the closest location on our carriers.

7. PAYMENT TERMS: All orders are cash in advance. At CXT's discretion, credit may be given after approval of credit application. Payment to CXT by the purchaser of any approved credit amount is net 30 days after submission of invoice to purchaser. Interest at a rate equal to the lower of (i) the highest rate permitted by law; or (ii) 1.5% per month will be charged monthly on all unpaid invoices beginning with the 35th day (includes five (5) day grace period) from the date of the invoice. Under no circumstance can retention be taken. If CXT initiates legal proceeding to collect any unpaid amount, purchaser shall be liable for all of CXT's costs, expenses and attorneys' fees and costs of any appeal.

8. LIMITATION OF REMEDIES: In the event of any breach of any obligations hereunder; breach of any warranty regarding the goods, or any negligent act or omission of any party, the parties agree to submit all claims to binding arbitration. Any settlement reached shall include all reasonable costs including attorney fees. In no event shall CXT be subject to or liable for any incidental or consequential damages. Without limitation on the foregoing, in no event shall CXT be liable for damages in excess of the purchase price of the goods herein offered.

9. DELIVERY INFORMATION: All prices F.O.B. origin prepaid and added to invoice. CXT operates three (3) manufacturing plants in the United States and will deliver from the closest location on our carriers. Use the information below to determine the origin:

- F.O.B. 6701 E. Flamingo Avenue, Building 300, Nampa, ID 83687 applies to: AK, CA, HI, ID, MT, ND, NV, OR, SD, UT, WA, WY.

- F.O.B. 901 North Highway 77, Hillsboro, TX 76645 applies to AR, AZ, CO, IA, KS, LA, MN, MO, MS, NE, NM, OK, TX.

- F.O.B. 362 Waverly Road, Williamstown, WV 26183 applies to AL, CT, DE, FL, GA, IL, IN, KY, MA, MD, ME, MI, NC, NH, NJ, NY, OH, PA, PR, RI, SC, TN, VA, VT, WI, WV.

- Prices exclude all federal/state/local taxes. Tax will be charged where applicable if customer is unable to provide proof of exemption.

SCHWEITZER – 10.5' up to 12'

Standard features include simulated barnwood textured walls, simulated cedar shake textured roof, 3068 steel 16-gauge galvanized door with latch and deadbolt, door holder, threshold, door sweep/seal, weather strip, operable wall vents, off loaded, and set up at site.

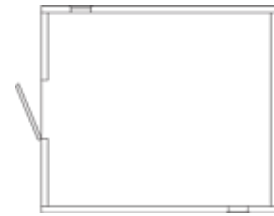

State of Nevada PO #99SWC-NV22-11322		Price Per Unit	
Base Price		\$	\$
Added Cost Options		Click to Select	
Final Connection to Utilities		\$	
Optional Wall Texture - <i>choose one</i> Split Face Block (\$5,500) Stone (\$7,000)			
Optional Roof Texture Ribbed Metal		\$	
Insulation and Heater		\$	
Flat Roof		\$	
Electric Package [includes 4' LED light fixture, switch, 1 LED exterior light photocell controlled, 100 amp breaker panel, louvered exhaust fan, intake with hood, GFI] (each)	Qty:	\$	
Interior Light (each)	Qty:	\$	
Exterior Light (each)	Qty:	\$	
10'6" Internal Concrete Wall (each)	Qty:	\$	
Blockout [greater than 4 sq. ft. subject to engineering] (each)	Qty:	\$	
Skylight (each)	Qty:	\$	
Marine Grade Skylight (each)	Qty:	\$	
Marine Package (excluding fiberglass doors and frames)		\$	
Replace Standard Door with 6068 Double Door (each)	Qty:	\$	
Additional 3068 Door with Hardware (each)	Qty:	\$	
Fiberglass Doors and Frames (each)	Qty:	\$	
Optional Door Closure (each)	Qty:	\$	
Timed Electric Lock System (each)	Qty:	\$	
2K Anti-Graffiti Coating		\$	
Wall Vent (each)	Qty:	\$	
Door Awning (each)	Qty:	\$	
Steel Framed Lexan Window [MS-4] (each)	Qty:	\$	
6' Roll-up Door (each)	Qty:	\$	
Total for Added Cost Options:			\$
Custom Options:			\$
Engineering and State Fees:			\$
Estimated One-Way Transportation Costs to Site (quote):			\$
Estimated Tax:			\$
Total Cost per Unit Placed at Job Site:			\$

Estimated monthly payment on 5 year lease

This price quote is good for 60 days from date below, and is accurate and complete.

CXT Sales Representative _____ Date _____

I accept this quote. Please process this order.

 Member Name & Number _____
 Company Representative _____ Date _____

Exterior Color(s) *(For single color mark an X. For two-tone combinations use W = Walls and R = Roof.)*

<input type="checkbox"/> Amber Rose	<input type="checkbox"/> Berry Mauve	<input type="checkbox"/> Buckskin	<input type="checkbox"/> Cappuccino Cream
<input type="checkbox"/> Charcoal Grey	<input type="checkbox"/> Coca Milk	<input type="checkbox"/> Evergreen	<input type="checkbox"/> Georgia Brick
<input type="checkbox"/> Golden Beige	<input type="checkbox"/> Granite Rock	<input type="checkbox"/> Hunter Green	<input type="checkbox"/> Java Brown
<input type="checkbox"/> Liberty Tan	<input type="checkbox"/> Malibu Taupe	<input type="checkbox"/> Mocha Caramel	<input type="checkbox"/> Natural Honey
<input type="checkbox"/> Nuss Brown	<input type="checkbox"/> Oatmeal Buff	<input type="checkbox"/> Pueblo Gold	<input type="checkbox"/> Raven Black
<input type="checkbox"/> Rich Earth	<input type="checkbox"/> Rosewood	<input type="checkbox"/> Sage Green	<input type="checkbox"/> Salsa Red
<input type="checkbox"/> Sand Beige	<input type="checkbox"/> Sun Bronze	<input type="checkbox"/> Toasted Almond	<input type="checkbox"/> Western Wheat
Special roof color #	_____		
Special wall color #	_____		
Special trim color #	_____		

Rock Color

<input type="checkbox"/> Basalt	<input type="checkbox"/> Mountain Blend	<input type="checkbox"/> Natural Grey	<input type="checkbox"/> Romana
---------------------------------	-----------------------------------------	---------------------------------------	---------------------------------

Roof Texture

<input type="checkbox"/> Cedar Shake	<input type="checkbox"/> Ribbed Metal
--------------------------------------	---------------------------------------

Wall Texture(s) *(For single color mark an X. For top and bottom textures use T = Top and B = Bottom.)*

<input type="checkbox"/> Barnwood	<input type="checkbox"/> Horizontal Lap	Can only be used as bottom texture	
<input type="checkbox"/> Split Face Block	<input type="checkbox"/> Board & Batt	<input type="checkbox"/> Napa Valley Rock	<input type="checkbox"/> River Rock
<input type="checkbox"/> Stucco/Skip Trowel	<input type="checkbox"/> Brick	<input type="checkbox"/> Flagstone	

(Textures not included in CXT's quote are additional cost.)

Door Opener

<input type="checkbox"/> Non-locking ADA Handle	<input type="checkbox"/> Privacy ADA Latch	<input type="checkbox"/> Pull Handle/Push Plate
-------------------------------------------------	--------------------------------------------	-------------------------------------------------

Deadbolt

Accessible Signage

<input type="checkbox"/> Men	<input type="checkbox"/> Women	<input type="checkbox"/> Unisex
------------------------------	--------------------------------	---------------------------------

Toilet Paper Holder

<input type="checkbox"/> 2-Roll Stainless Steel	<input type="checkbox"/> 3-Roll Stainless Steel
-------------------------------------------------	-------------------------------------------------

Notes:

Quote #: **KMEE1019D9-1**

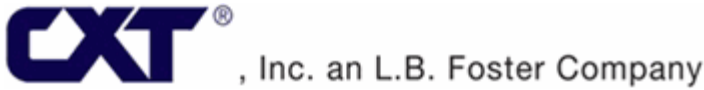

Mailing Address:
CXT Incorporated, an LBFoster Co.
606 N. Pines Road, Suite 202
Spokane Valley, WA 99206

To: **Mee Kurt**

Phone: (800) 696-5766
Fax: (509) 928-8270
Date: 02/13/2023

Attention: Kurt Mee
Phone: (303) 552-1843

Our quotation for the Santiago - KM6 building is as follows:

Pricing based on Sourcewell contract number #081721-CXT
Santiago storage and changing room building with simulated cedar shake roof and barnwood wall texture, three galvanized steel doors and frames, changing bench in changing room, Utility sink and exterior hose bib by bottle filler, interior lights and photo cell controlled exterior lights. Includes PE stamped drawings. Proposal drawing #23-005P

Per Building
\$184,254.29

Price includes delivery, crane and offloading on customers prepared pad and utilities. Customer will be responsible for local permits. Site must be accessible to over the road semi and trailer.

NV state approval	\$900.00
Taxes	\$16,430.00
Haws 1920 bottle filler	\$3,625.00
Freight	
	\$205,209.29

FOB: Freight FOB Plant Prepaid and Add.
Terms: Net 30 days subject to corporate credit approval.
Notes: Sales tax not included
Number of Units: ____

This quotation is subject to the conditions on the attached sheet and the terms hereof shall constitute the exclusive agreement of the parties and all conflicting or additional terms in Buyer's purchase order or any other such documents of Buyer shall have no force or effect.

L.B. FOSTER COMPANY

By _____
Kurt Mee
KMee@lbfoster.com

Accepted this _____ day of _____ 20____
By: _____ (Customer Name)
_____ (Signed)

CONDITIONS OF SALE

1. Taxes: Prices exclude all Federal/State/Local taxes. Tax will be charged where applicable if customer is unable to provide proof of exemption.

2. Payment Terms

All orders are cash in advance. At CXT's discretion, credit may be given after approval of credit application. Payment to CXT by the purchaser of any approved credit amount is net 30 days after submission of invoice to purchaser. Interest at a rate equal to the lower of (i) the highest rate permitted by law; or (ii) 1.5% per month will be charged monthly on all unpaid invoices beginning the 35th day (includes 5 day grace period) from the date of the invoice. Under no circumstances can a retention be taken and purchaser shall pay the full invoiced amount without offset or reduction. These terms are available upon approval of credit. If CXT initiates legal proceeding to collect any unpaid amount or other dispute arising out of or relating to this Quote, purchaser shall be liable for all of CXT's costs, expenses and attorneys fees associated with such litigation, including the fees and costs of any appeal.

3. Quotation Term: This offer is subject to acceptance within 60 days from the date of this quotation. After that time, prices are subject to change without notice.

4. Drawings

Prices do not include any documentation other than standard drawings, packing lists, and invoices, unless otherwise stated in quote. Special documentation, reports, or submittals can be supplied at an additional cost. If additional engineering, engineering seals, state approvals, drawings, or insignias are required additional charges may incur.

5. Delivery

Delivery will be scheduled immediately upon receipt of written customer approval of all building submittals, building worksheet(s) and signed contract/purchase order. In the event delivery of the buildings ordered is/are not completed within 30 days of the agreed to schedule through no fault of CXT, an invoice for the full contract value (excluding shipping and installation costs) will be submitted for payment, the terms of which will be as per item 2 in our quotation. Delivery and installation charges will be invoiced at the time of delivery and installation. Should the delivery and installation costs increase due to changes in the delivery period, this increase in cost will be added to the price originally quoted, and will be subject to the contract payment terms. In the event that the delivery is delayed more than 45 days after the agreed to schedule and through no fault of CXT, then in addition to the remedies above, a storage fee of 1 1/2% of contract price per month or part of any month will be charged.

6. Fuel Costs

Fuel costs for crane and freight have been quoted at fuel prices furnished at the time of quotation. If at the time of delivery and installation these costs have risen, CXT reserves the right to adjust the freight and crane costs to reflect the fuel costs furnished at the time of delivery.

7. Responsibilities of the Customer

- A. Stake exact location building is to be set, including orientation.
- B. Provide clear and level site, free of overhead and/or underground obstructions.
- C. Provide site accessible to normal highway trucks and sufficient area for the crane to install and other equipment to perform the contract requirements.
- D. Customer shall provide notice in writing of low bridges, roadway width or grade, unimproved roads or any other possible obstacles from State highway and/or main county road to site. CXT reserves the right to charge the customer for additional costs incurred for special equipment required to perform delivery and installation.
- E. Customer is responsible for all permits required.
- F. Completing and complying with Pre-Order Information Worksheet that is incorporated herein by this reference.

8. Access to Site

For Installation methods described below in paragraph 9 A & B, delivery will be made in normal highway trucks and trailers. If at the time of delivery conditions of access are hazardous or unsuitable for truck equipment for any reason, CXT shall be entitled to payment for extra costs to ensure a safe and quality installation to the chosen site or will agree to an alternative site with better access.

To safely offload the facility referred to within this quotation, CXT must have clear and unobstructed access next to the gravel pad or hole where the facility will be placed. CXT is not responsible for cracked or damaged roads, driveways, sidewalks or aprons that are in the path of the delivery trucks or cranes at the final offloading site. Should CXT be required to obtain a larger crane than quoted due to site amenities or hardscapes, CXT will charge the customer the difference between the crane originally quoted, and the one that was hired to successfully offload the facility safely and efficiently.

9. Installation

- A. **Full Install.** If the customer opts to have full installation of their new building, CXT will provide a backhoe trailered into the site, and prepare the customer site at the marked hole/pad area. The crane will arrive and set up next to the hole/pad. Any requirements to lift the building over obstacles or not having the ability of the crane to be right next to the hole could incur additional charges. The size of the crane varies however most cranes require an area of 18'x18' for their outriggers. Truck(s) carrying the vaults and the building systematically pull up right next to the crane and are offloaded onto the site. Any requirements to lift the building over obstacles or not having the ability of the truck to be right next to the crane could incur additional charges. Installation crew then performs all necessary excavation, backfill, compaction, site grading, and connection of utilities (if applicable). Please note: additional time and any special equipment needed by the installation crew for unscheduled site work will be billed to the customer.
- B. **Set-Only Install.** If the customer opts to prepare the hole, and do earthwork preparation for the site, the customer will move all excess dirt to allow access by the crane and semi-truck. The crane will arrive and set up next to the hole/pad. Any requirements to lift the building over obstacles or not having the ability of the crane to be right next to the hole could incur additional charges. The size of the crane varies however most cranes require an area of 18'x18' for their outriggers. Truck(s) carrying the vaults and the building systematically pull up right next to the crane and are offloaded onto the site. Any requirements to lift the building over obstacles or not having the ability of the truck to be right next to the crane could incur additional charges. Customer performs all necessary excavation, backfill, compaction, site grading, connection of utilities (if applicable). If the pad for a flush building, or a customer prepared excavation/hole prep is not to CXT specifications, and results in extra costs the customer will be responsible for these extra costs.
- C. **Ship-Only.** If customer opts to self-install their building CXT can provide a drawing of the recommended lifting/rigging arrangement plus the four special lifting plates for the buildings itself with a charge of \$5,000.00 to purchase the lifting plates and hardware to lift the building and vaults. The CXT arrangements will help prevent damage to the building. CXT will not take responsibility for any damage/accidents to the building or workers during the use or non-use of our recommended lifting/rigging arrangements.
- D. CXT shall be entitled to reimbursement from customer for any expenses that are the result of conditions encountered at the site which are (1) subsurface or otherwise concealed physical conditions which differ materially from those indicated by the customer or (2) unknown physical conditions of an unusual nature, which differ materially from those ordinarily found to exist and generally recognized as inherent in construction activities at the customer's location.
- E. Should customer request additions or changes to the work, CXT shall be entitled to payment for additional or changed work. Any request for additions or changed work shall be in writing executed by Customer Field Representative by signing the additional work required section of the Building Acceptance Form, incorporated herein by this reference.

10. Transportation

Your building(s) will be transported from our plant to your installation site via semi-truck with trailer. The length and clearance vary with the style of trailer used to accommodate your building model(s) and must be taken into consideration when determining access to site. If you ordered a(n)....

Cascadian/Rocky Mountain - Requires 1 truck: When shipped in 2-pieces (standard) the building with vault is shipped on a flatbed trailer. The length of the

tractor-trailer can be up to 75' long. Must have a 14' height clearance to access site.

Gunnison - Requires 1 truck: Shipped with its vault, this building is typically shipped on a step-deck trailer. The length of the tractor-trailer can be up to 75' long. Must have 14' height clearance to access site.

Tioga Special • Requires 2 trucks: 1 to transport the building and 1 to transport vaults. The building is typically shipped on a step-deck trailer and 2 vaults are typically transported on a flatbed trailer. The length of the tractor-trailer can be up to 75' long. Must have 14' height and 14' width clearance to access site.

Dbl Cascadian/Dbl Rocky Mountain • Requires 2 trucks: 1 to transport the building and 1 to transport the vaults. The building is typically shipped on a dbl-drop or low boy trailer (approximate ground clearance of 4 to 6") and the 2 vaults are typically transported on a flatbed trailer. The length of the tractor-trailer can range from 75' to 80'. Must have 14' height and 14' width clearance to access site.

Cortez/Ozark I/Teton/Pioneer - Requires 1 truck: Generally shipped on a step-deck trailer. The length of the tractor-trailer can be up to 75' long. Must have a 14' height and 14' width clearance to access site.

Large Flush, Sectional, or Custom Bldgs -

(Arapahoe/OzarkII/Cheyenne/Montrose/Taos/Rainier/PomonayNavajo/Malibu/Kodiak/FontanayDiablo/Denali)

Requires 2-4 trucks, depending on size of building. Each section will be shipped on an RGN trailer (approximate ground clearance of 4 to 6"). The length of the tractor-trailer can range from 80' to 115'. Must have 14' height and 14' width clearance to access site. The Denali model could ship on either an RGN trailer or a dbl-drop.

Schweltzer/Mendocino - Requires 1-2 trucks, depending on size of building. Generally shipped on a step-deck trailer. The length of the tractor-trailer can be up to 75' long. Must have 14' height and 14' width clearance to access site.

11. CXT Warranty

CXT warrants that all structures sold pursuant hereto will, when delivered, conform to specifications of the building listed on the quote. Structures shall be deemed accepted and meeting specifications unless notice identifying the nature of any non-conformity is provided to CXT in writing within one (1) year of delivery. It is specifically understood that CXT's obligation hereunder is for credit or repair only. CXT will repair structural defects against materials and workmanship for one (1) year from date of delivery provided CXT is first given the opportunity to inspect said structure. CXT warranties all components sold within all structures pursuant here to when delivered within structures. Components deemed accepted and meeting specifications shall be warranted for a period of one (1) year against defects in the materials and/or workmanship from said date of delivery. CXT is not responsible for components that are damaged due to misuse, acts of violence, negligence, acts of God, or accidents. Shipping, handling, installation or other incidental or consequential costs, unless otherwise agreed to in writing by CXT, are not included.

This warranty shall not apply to:

Any goods which have been repaired or altered without CXT's express written consent, in such a way as in the reasonable judgment of CXT, to adversely effect the stability or reliability thereof;

To any goods which have been subject to misuse, negligence, acts of God, or accidents;

To any goods which have not been installed to manufacturer's specifications and guidelines, improperly maintained, or used outside of the specifications for which such goods were designed.

12. Disclaimer of Other Warranties

THE WARRANTY SET FORTH ABOVE IS IN LIEU OF ALL OTHER WARRANTIES, EXPRESS OR IMPLIED. ALL OTHER WARRANTIES ARE HEREBY DISCLAIMED. CXT MAKES NO OTHER WARRANTY EXPRESS OR IMPLIED, INCLUDING WITHOUT LIMITATION, NO WARRANTY OF MERCHANTABILITY OR FITNESS FOR A PARTICULAR PURPOSE OR USE.

13. Limitation of Remedies

In the event of any breach of any obligations hereunder; breach of any warranty regarding the goods, or any negligent act or omission of any party, the parties agree to submit all claims to binding arbitration. Any settlement reached shall include all reasonable costs including attorney fees. In no event shall CXT be subject to or liable for any incidental or consequential damages. Without limitation on the foregoing, in no event shall CXT be liable for damages in excess of the purchase price of the goods herein offered.

14. Acceptance

The foregoing terms will be deemed accepted in full by signature and return of one copy to CXT, subject to customer credit approval. A copy of any applicable form of payment security device (i.e. payment bonds) available to CXT shall be included with the signed copy of this agreement.

15. Timing of Billing to Buyer

Seller will invoice Buyer upon shipment from its supplier or facility, unless otherwise indicated on the face of this document.

16. Storage of Material For Buyer

If, at Buyer's request, goods covered by this document are held at Seller's facility or service provider for more than 21 days after they are available for shipment, Buyer shall accept Seller's invoice and pay said invoice based on payment terms set forth herein.

17. Material Reservation

Seller will only reserve material for 30 days with receipt of an executed purchase order, quote or order acknowledgement acceptable to Seller. After that time, material availability, price and shipment date may be adjusted, at Seller's option.